

# The Fifty-Second Meeting of the Southwestern Psychological Association

President

**Paul R. Nail**

*University of Central Arkansas*

Past President

**Edward P. Kardas**

*Southern Arkansas University*

President-Elect

**Charles Burdsal**

*Wichita State University*

Secretary-Treasurer

**Raymond Russin**

*Kansas Wesleyan University*

## Executive Council Members

Arizona

**Bill Gibson**

*Northern Arizona University*

Arkansas

**James A. Gillaspay, Jr.**

*University of Central Arkansas*

Kansas

**Arnold Froese**

*Sterling College*

Louisiana

**Theresa A. Wozencraft**

*University of Louisiana-Lafayette*

Missouri

**Michael Nelson**

*University of Missouri-Rollo*

New Mexico

**Steven P. Verney**

*University of New Mexico*

Oklahoma

**Brett Roark**

*Oklahoma Baptist University*

Tennessee

**Dana K. Fuller**

*Middle Tennessee State*

Texas

**John P. Hall**

*Texas Wesleyan University*

## Association and Convention Support Staff

Convention Manager

**Loretta Neal McGregor**

*Arkansas State University*

Co-Program Chairs

**Loretta Neal McGregor**

*Arkansas State University*

**Darcee Datteri**

*Wichita State University*

Historian

**James A. Gillaspay, Jr**

*University of Central Arkansas*

Continuing Education

**Theresa A. Wozencraft**

*University of Louisiana-Lafayette*

## Table of Contents

Registration Information	vi
From the Program Chair	vii
Acknowledgements	viii
Audio-Visual Policy	ix
Continuing Education Workshop Information	x
APA/SWPA Undergraduate/Graduate Student Workshop Invitation	xi
Psi Chi Student Invitation to SWPA Social Hour	xii
Meeting Facilities Layout	xiii
SWPA Executive Council Meeting	1
SWPA Business Meeting	45
SWPA Social Hour	23
SCPA Business Meeting	54
SAMR Business Meeting	23
CUPP/CTUP Continental Breakfast and Conversation Hour	25
Psi Chi Faculty Luncheon	35
Psi Chi Conversation Hour with Elliot Aronson	40
Psi Chi Awards Ceremony	45
Index	55

## **SWPA *Southwestern Psychological Association***

### **Saul B. Sells Lecture**

Monica Biernat	6
----------------	---

### **Invited Addresses**

Jeffrey R. Alberts	9
David Buss	19
Robert Montgomery	29
Joshua Aronson	30
Elliott Aronson	36

**SWPA *Southwestern Psychological Association*****Symposia**

An evaluation of using a client feedback model	3
Teaching trauma II: Practical and ethical issues in the classroom	5
Creating a successful psychology student philanthropy course	10
Change through communication	20
The academic side of character development	34
The effects of child sexual abuse	34
Sin: The psychology of moral failure in religious populations	48
Hurricane Rita: Personality variables and coping mechanism	52

**Continuing Education Workshop**

Pediatric psychopharmacology in the Schools: Advances, issues, and role opportunities	18
---	----

**Workshops**

Ethical and practical strategies for clinical assessment of cultural diverse individuals	25
Practical strategies and interventions for counseling the culturally diverse	23
Team approach to assessing diverse children with autism	47

**Paper Sessions**

Clinical and Counseling Psychology	4
General Psychology I	5
Social and Personality Psychology I	14
Social and Personality Psychology II	25
Applied Psychology	28
General Psychology II	28
Developmental Psychology	34
Teaching	38
Cognition and Memory	40
Gender, Ethnicity, and Culture I	41
Gender, Ethnicity, and Culture II	51

**SWPA *Southwestern Psychological Association***Poster Sessions

Clinical, Counseling and Applied	7
General Psychology I	10
Cognition and Memory	20
General Psychology II	31
Gender, Culture, and Ethnicity	37
Social and Personality	48

Research Competitions

SWPA Undergraduate Research Competition	26
SWPA Graduate Research Competition	4

**APA *American Psychological Association***Workshop

Entering the academic marketplace: Advice from experts	23
--	----

**SCPA *Southwest Comparative Psychological Association***Invited Addresses

Michael J. Ryan	39
Mauriccio R. Papini	53

Paper Sessions

Animal Learning I	14
Animal Learning II	22
Animal Learning III	35
Animal Learning IV	52

Poster Sessions

SWPA/SCPA Poster Session	27
--------------------------	----

**SAMR *Society for Applied Multivariate Research***Invited Address (SAMR and SWPA)

Irwin Sandler	22
---------------	----

Paper Session

Topics in Regression	17
----------------------	----

SAMR Workshop

Introduction to Meta-analysis 5

**CUPP** *Council of Undergraduate Psychology Programs*Symposia

Symposium for new and aspiring department chairs 41

**CTUP** *Council of Teachers of Undergraduate Psychology*Symposia

Teaching psychological statistics to undergraduates 27

Poster Session(CTUP and SWPA)

Teaching 15

**PT@CC** *Psychology Teachers at Community Colleges*Invited Address

Sharon Burson 47

Symposia

Scholarship at the community college level 54

**TOPSS** *Teaching of Psychology in Secondary Schools*Symposia

Teaching research methods in the AP classroom 53

**Psi Chi** *The Honor Society in Psychology*Invited Address

Charles Spielberger 13

Paper Sessions

Psi Chi Paper Session I 25

Psi Chi Paper Session II 51

Poster Session

Psi Chi Poster Session I 41

Workshop

Sharing the glory; sharing the pain 3

## **Registration at the 2006 Southwestern Psychological Association Convention**

For the Southwestern Psychological Association, the convention registration fee is the same as the annual membership dues. Members who pre-registered for the conference pay the standard membership rate. When a Full Member pays the \$60, an Associate Member pays \$45, and a Student Member pays the \$30 to join SWPA, they are also paying for their convention registration; thus, registering for the SWPA convention means joining SWPA.

**On-site registration fees are \$40.00 for students; \$55.00 for Associate members; \$70.00 for SWPA members and non-members.**

Registration will take place at the registration desk in front of the Capital View Terrace Room (see map on page 13) located on the third floor of the Marriott at the Capitol Hotel. Registration hours are Wednesday, April 13, 5:30 p.m.-9:00 p.m.; Thursday, April 14, 8:00 a.m.-5:00 p.m.; Friday, April 15, 8:00 a. m.- 5:00 p. m.; and Saturday, April 16, 8:00 a.m.-10:00 a.m.

**From the Program Chair**  
**Loretta Neal McGregor**  
*Arkansas State University*

Welcome to Austin, y'all! I have been told that everything is bigger and better in Texas. And this time, I must say that I agree with that statement. We have an amazing conference scheduled for 2006. At this point, I had planned to share some of the conference highlights with you. However, I quickly realized that I simply could not choose just a few things to include as highlights. So, I wish you luck in choosing which sessions to attend.

As usual, I must say thank you to everyone who submitted a proposal for presentation. It is you who truly make this conference possible. I would also like to thank the program coordinators from the affiliate organizations for their roles in planning this conference. Thanks to Deborah McCall (APA), Scott A. Bailey (SCPA and CUPP), Jeanne Burdsal (SAMR), Matthew Johnson (CTUP), Skip Pollock (PT@CC) and Richard Kasschau (Psi Chi). Each respective organization is lucky to have such dedicated and competent members. Thanks to Theresa Wozencraft for organizing the CE workshop. Thank you to Paul Nail and Charles Burdsal. It has truly been a pleasure to work with both of you. To my dear friend Edward Kardas, as usual, your assistance was invaluable. Thanks to the new incoming program chair, Darcee Datteri. I wish you nothing but the best of luck. I would also like to thank Brent Ellison. Brent, I could not ask for a better graduate assistant to work with me. And to my children Porsha and Sean, thanks again for sharing your mom with SWPA.

Finally, for the past three years, I have had the honor of serving as program chairperson for SWPA. It has been challenging yet rewarding in many ways. I have read hundreds of abstracts and I have learned a lot about psychology. I have made some wonderful new friends and gained a greater appreciation for many of my long-time friends. For these things and many more, I simply say, thank you SWPA for allowing me to serve as your program chairperson! It has been an honor.

## Acknowledgements

SWPA gratefully acknowledges the generosity of the Science Directorate of the American Psychological Association for supporting the SWPA Science Dinner Host Program. Additionally, SWPA is grateful to APA for co-sponsoring the undergraduate/graduate student workshop. SWPA also thanks McGraw-Hill for co-sponsoring the Saul B. Sells Lecture.

### Thank you to the following individuals who served as reviewers.

Paul Ackerman	Dorothy A. Flannagan	Janet R. Matthews
Regginald Adkisson	Arnold D. Froese	Amie McKibban
Scott A. Bailey	Stella D. Garcia-Lopez	Paul S. Merritt
Carl Bartling	James A. Gillaspay	Michael D. Murphy
Ira H. Bernstein	Cathy A. Grover	Robert W. Newby
Kristen Biondillilo	Frances M. Haemmerlie	Amy R. Pearce
Richard Breeding	John P. Hall	Latoya Pierce
Monica Brooker	Richard J. Harris	Harold Rodinsky
Jeanne P. Burdsal	Christian L. Hart	Darrin L. Rogers
Casey Butler	Jennifer Hendrix	David Saarnio
Will H. Canu	Jennifer L. Hicks	Steven J. Schapiro
Aaron Z. Carlson	Sarah Horn	Lauren Scharff
Barbara Chaparro	Jeffrey Howard	Carl W. Scott
Chrisanne Christensen	Matthew I. Isaak	Sangeeta Singg
Robbie Cline	Benetha G. Jackson	Ronald D. Taylor
Kristin L. Croyle	Matthew C. Johnson	Julie A. Tietz
John M. Davis	Robert D. Johnson	Marilyn D. Van Leeuwen
Steve J. DePaola	Edward P. Kardas	Bonnie J. Walker
Lawrence S. Dilks	Edythe E. Kirk	Kenneth A. Weaver
Brent Ellison	Bill J. Lammers	David Weissenburger
Heidi L. Eyre	Sara C. Lawrence	Katie Williams
Douglas S. Faust	Lisa K. Lockhart	Virginia V. Wood



## **Audio-Visual Policy**

SWPA provides only a screen in all meeting rooms where members present papers, workshops, or symposia. If members need any other audio-visual equipment, they are responsible for making their own arrangements and payment.

The security and storage of any equipment brought to the meeting site are the sole responsibility of the individual bringing or renting the equipment for the meeting. SWPA is not responsible for the security and storage of equipment brought to the meeting site by private arrangement.

## **Continuing Education Workshop Information**

This year's Continuing Education workshop is entitled "Pediatric psychopharmacology in the schools: Advances, issues and role opportunities" The workshop presenter is Dr. Thomas Kubiszyn from the University of Houston. Dr. Kubiszyn, is Professor of Educational Psychology and Director of Training for the Ph.D. School Psychology Program at the University of Houston, and is a past Assistant Executive Director for Professional Practice and Director of the Office of Policy and Advocacy in the Schools with the American Psychological Association (APA). He has been licensed psychologist in Texas since 1981, and is a member of the National Register of Health Service Providers in Psychology. He was chair of the APA Division 16 (School Psychology) Task Force on Psychopharmacology in the Schools from 1992-1995, and the Division's Task Force on Psychopharmacology, Learning and Behavior from 2002-2005 and has published several articles and chapters on pediatric psychopharmacology.

Workshop fees may be paid during the SWPA conference. Workshop registration will take place at the Registration desk across from the Capitol View Terrace (see map on page ) located on the second floor of the Marriott at the Capitol.

## **Attention Aspiring Academics! Attend an Undergraduate/Graduate Student Workshop: A Primer on Entering the Professoriate**

A workshop sponsored by the American Psychological Association in conjunction with the Southwestern Psychological Association entitled, "Entering the Academic Marketplace: Advice from Experts," will be held during the convention from 3:00 to 4:30 on Thursday, April 13 in Ballrooms A&B. What is the "right" academic job, and what does it take to land it? This workshop is designed for aspiring academics who are currently undergraduate, graduate, or postdoctoral students. Expert panelists will share their insights, with plenty of opportunity for discussion.

### **Five Burning Questions of the Professoriate**

- What are the major rewards and challenges of an academic career? Which are unique to your institution or type of institution?
- Did graduate school prepare you for the job you are doing now?
- If you could go back and do one thing differently along your career path, what would it be?
- What are the biggest "turn ons" and "turn offs" about job candidates who are applying to your department?
- What do you think the major changes in academic life will be in coming years?

# CALLING ALL STUDENTS!

## 2<sup>nd</sup> Annual Dinner with a Psychologist

How would you like to have the opportunity to meet in a small group and talk about research and graduate school opportunities with a noted expert and academician from our Southwestern region? Reservations may be made at the SWPA convention desk during registration on Wednesday evening (5:30-8:30 pm) or on Thursday and Friday mornings (8 am -12 pm). Spots are limited and will be made on a first come / first served basis, so sign up today (students pay for their own meals).

Monica Biernat, Ph.D. University of Kansas	Stereotyping and Prejudice	Thursday, April 13
David M. Buss, Ph.D. University of Texas	Evolutionary Psychology	Thursday, April 13
John Murphy, Ph.D. University of Central Arkansas	School Psychology and Brief Interventions	Thursday, April 13
Joe Lee Rodgers, Ph.D. University of Oklahoma	Adolescent Development, Decision Making (infertility), and Mathematical Modeling	Thursday, April 13
Barbara Chaparro, Ph.D. Wichita State University	Human Factors	Friday, April 14

### New Reasons to Attend the SWPA Social

Come meet faculty and students from across our region, and have a chance to talk to the invited speakers. The SWPA social will offer a relaxed atmosphere and a cash bar for refreshments. Further, if you are a student, the Southwestern Region of Psi Chi will provide you with free nonalcoholic beverages, snacks, and prizes. Everyone is also invited to participate in activities to promote interactions between attendees from different universities (or you can just come and watch the fun).

**Thursday, April 13: Ballroom D (5:00-7:00 p.m.)**

The Marriott Austin at the Capitol Hotel Meeting Facilities

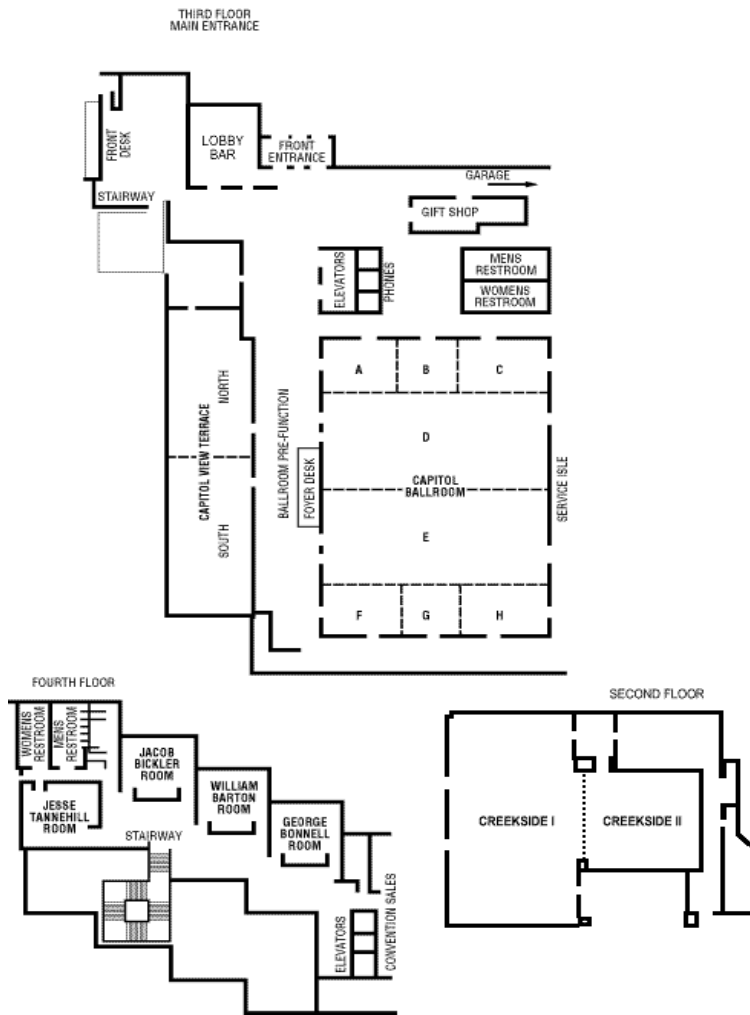

All Poster Sessions are held in the Capitol View Terrace

**Wednesday, April 12<sup>th</sup>, 2006**

**Registration**

5:30 p.m.- 9:00 p.m.

2<sup>nd</sup> Floor Registration Desk

**SWPA Executive Council Meeting**

7:00 p.m.- 9:00 p.m.

Chaired by Paul R. Nail

Ballrooms A&B



**Thursday, April 13<sup>th</sup>, 2006**

**SWPA Symposium: An evaluation of using client feedback model**

8:00 a.m.- 8:50 a.m.

Ballrooms G&H

Chaired by Jeff Reese

Jeff Reese  
Larry A. Norsworthy  
Scott Perkins  
Steve Rowlands  
Alison Gensic  
Jennifer M. Voiles  
Amy Kaderka

*Abilene Christian University*  
*Abilene Christian University*  
*Abilene Christian University*  
*Abilene Christian University*  
*Abilene Christian University*  
*Abilene Christian University*  
*Abilene Christian University*

**Psi Chi Workshop: Sharing the glory; sharing the pain**

8:00 a.m.-8:50 a.m.

Creekside I

Chaired by John M. Davis

Christine Yates  
Amanda L. Exner  
Erin L. Short  
Crissy N. Potts  
Megan E. Davis  
Lindsey C. Harkabus  
Bethany Gulley  
Amber Kahn  
Clarence Davis  
Alex Yudovich

*Emporia State University*  
*Louisiana State University*  
*Oklahoma Baptist University*  
*Stephen F. Austin State University*  
*Texas State University*  
*Texas State University*  
*University of Central Arkansas*  
*University of Houston*  
*University of Houston*  
*University of Texas—Austin*



## **SWPA Graduate Research Competition**

8:00 a.m.-10:00 a.m.

Ballrooms A&B

Chaired by Paul R. Nail

### **How working memory and text coherence interact in Chinese comprehension**

Sau Hou Chang

*Texas A&M-Commerce*

Tracy B. Henley, *Faculty Sponsor*

*Texas A&M-Commerce*

### **Effects of Hurricane Rita on rural elderly in Vermilion Parish: A comparison of nursing home and independent elderly**

Theodore S. Smith

*Texas A&M-Commerce*

Raymond J. Green, *Faculty Sponsor*

*Texas A&M-Commerce*

### **The effects of program context on commercial recall**

Laura M. Olson

*Stephen F. Austin State University*

Jeffrey L. Oldenkamp

*Stephen F. Austin State University*

Lauren Scharff, *Faculty Sponsor*

*Stephen F. Austin State University*

### **Overcoming workplace barriers by utilizing S.T.R.E.S.S.**

Nedra H. Francis

*Prairie View A&M University*

Paula A. Moore *Faculty Sponsor*

*Prairie View A&M University*

## **SWPA Paper Session: Clinical and Counseling**

9:00 a.m.- 9:50 a.m.

Jacob Brickler Room

Chaired by James A. Gillaspy

### **Concealable stigma and test performance: Revealing a mental illness history**

Amanda M. Fleming

*Henderson State University*

Aneeq Ahmad

*Henderson State University*

### **On-line gaming: Addictive quality among young adults**

David L. Carlston

*Midwestern State University*

Timothy M. Baghurst

*Midwestern State University*

David L. Carlston

*Midwestern State University*

### **Religious-spiritual issues in couples therapy: A developmental perspective**

J. Roland Fleck

*National University*

Dorothy T. Fleck

*South Bay Community Services*

### **Factor structure of the simple screening instrument (SSI)**

Stephen R. Gillaspy

*University of Central Arkansas*

James A. Gillaspy

*University of Central Arkansas*

**SWPA Symposium: Teaching Trauma II: Practical and Ethical Issues in the Classroom**

9:00 a.m.- 9:50 a.m.

Ballroom E

Chaired by Sharon K. Hall

Sharon K. Hall

Jo A. Meier

Mary McNaughton-Cassill

Kyle E. Chang

*University of Houston Clear Lake*

*University of Houston Clear Lake*

*University of Texas at San Antonio*

*University of Houston Clear Lake*

**SAMR Workshop: Introduction to meta-analysis**

9:00 a.m.- 12:00 p.m.

George Bonnell Room

Chaired by Richard Osbaldiston

Richard Osbaldiston

Charles G. Lambdin

Dennis L. Jackson

Rebecca J. Purc-Stephenson

*Southwestern University*

*Wichita State University*

*University of Windsor*

*University of Windsor*

**SWPA Paper Session: General Psychology I**

10:00 a.m.- 10:50 a.m.

William Barton Room

Chaired by Deborah L. Stote

**Glycine receptor modulation by alcohol, volatile anesthetics, and inhalants**

Lindsay M. McCracken

Deborah L. Stote

*University of Texas at Austin*

*University of Texas at Austin*

**Evidence of alcohol binding in the GABA(A) receptor beta2 subunit**

Mandy L. McCracken

Deborah L. Stote

*University of Texas at Austin*

*University of Texas at Austin*

**What do students think about SWPA?**

Jennifer L. Cook

Maria G. Busmail

Arnold D. Froese

*Sterling College*

*Sterling College*

*Sterling College*

**Docosahexaenoic acid (DHA) may protect hippocampus morphology from lead toxicity**

Kristina G. Demarest

Rebecca R. weaver

Aneeq Ahmad

*Henderson State University*

*Henderson State University*

*Henderson State University*

**Saul B. Sells Lecture**-Chaired by Paul R. Nail

**Monica Biernat**

*University of Kansas*

**Complexity and subtlety in patterns of stereotyping and prejudice**

Thursday, 10:00 a.m.- 10:50 a.m.  
Ballroom D

We typically think of a stereotyping effect as a blatant application of a stereotype to an individual group member - as when an individual African American or woman is judged less competent than a white man for a particular occupation. But stereotypes can also manifest themselves in more subtle ways, as when standards are low for members of devalued groups (leading to surprise when they are surpassed), or when an initial positive reaction toward a devalued group member "frees" the perceiver to act in a more prejudiced manner later. Dr. Biernat will explore a variety of research traditions that document effects of this sort and will argue that these subtle patterns both a) reduce people's concerns about the "problem" of prejudice and b) serve to maintain stereotypes over time.

Dr. Biernat is Professor of Psychology and Director of the Ph.D. Program in Social Psychology at the University of Kansas. She earned her Ph.D. from the University of Michigan in 1989. She has authored many articles and chapters and recently published a book on standards and expectancies. She is the winner of several teaching awards, the Distinguished Publication Award of the Association for Women in Psychology, and the APA Distinguished Scientific Award for Early Career Contribution to Psychology.

**SWPA Poster Session: Clinical, Counseling, and Applied**

10:00 a.m.- 11:15 a.m.

Capitol View Terrace

**Board 1: Emotional disorders secondary to pesticide exposure**

Brooke D. Mayeaux	<i>McNeese State University</i>
Lawrence S. Dilks	<i>McNeese State University</i>
Janice C. Marceaux	<i>McNeese State University</i>
Jacqueline F. Bourassa	<i>McNeese State University</i>
Sheila B. Hixson	<i>McNeese State University</i>
Burton J. Ashworth	<i>McNeese State University</i>
Marie A. Bourgeois	<i>McNeese State University</i>

**Board 2: Complimentary medicine use and the community college student**

Virginia M. Wharton	<i>Stephen F. Austin State University</i>
Benetha G. Jackson	<i>Angelina College</i>

**Board 3: Lay beliefs about the course of ADHD and treatment**

Michaela T. Robertson	<i>University of Texas at San Antonio</i>
David R. Pillow	<i>University of Texas at San Antonio</i>

**Board 4: Treatment for pathological gambling: Cognitive behavioral treatment versus twelve-step facilitated**

Cam L. Melville	<i>McNeese State University</i>
Janice C. Marceaux	<i>McNeese State University</i>
Brooke D. Mayeaux	<i>McNeese State University</i>

**Board 5: Burnout in rural mental health counselors**

Jeffery Alan Kee	<i>Amarillo College</i>
------------------	-------------------------

**Board 6: Counselor characteristics in the selection of a counselor**

Stephanie M. York	<i>Abilene Christian University</i>
Larry A. Norsworthy	<i>Abilene Christian University</i>

**Board 7: Symptoms of eating disorders and oOCD: Cognitive and affective similarities**

Joy D. Humphreys	<i>Texas Tech University</i>
James R. Clopton	<i>Texas Tech University</i>

**Board 8: Longitudinal study of soldier depressive and posttraumatic stress symptoms**

Coady B. Lapierre	<i>Tarleton State University</i>
Bill J. LaBauve	<i>Tarleton State University</i>
Mercathea J. Hughes	<i>Tarleton State University</i>

**Board 9: Health identity and health behavior in college students**

Jean M. Low	<i>University of Louisiana-Monroe</i>
Jennifer R. Decker	<i>University of Louisiana-Monroe</i>

**Board 10: Modeling health behaviors and symptoms**

Larry A. Norsworthy      *Abilene Christian University*  
Jennifer G. Waldschmidt      *Abilene Christian University*

**Board 11: Case descriptions of school consultation involving Hispanic youth**

Sylvia Z. Ramirez      *University of Texas-Pan American*  
Peter L. Kranz      *University of Texas-Pan American*

**Board 12: Psychological and behavioral attributes of the incarcerated individual**

Stephanie L. Boyd      *McNeese State University*  
Lawrence S. Dilks      *McNeese State University*  
Janice C. Marceaux      *McNeese State University*  
Darrel B. Turner      *McNeese State University*

**Board 13: Relationship between inmate performance on the MCMI and criminal behavior**

Darrel B. Turner      *McNeese State University*  
Lawrence S. Dilks      *McNeese State University*  
Stephanie L. Boyd      *McNeese State University*  
Janice C. Marceaux      *McNeese State University*

**Board 14: "Loves me not": Current parental attachment and personality dysfunction**

Elissa L. Lewis      *Southwestern University*  
Mary A. Erwin-Hartley      *St. Edwards University*  
Jessica L. DeFilippo      *Southwestern University*  
Bryan D. Neighbors      *Southwestern University*

**Board 15: Narcissism and threatened ego: The relationship between aggression and self-esteem**

Brooke E. Hall      *Lamar University*

**Board 16: The relationship between thought suppression and test anxiety**

Joe A. Randell      *East Central Oklahoma University*  
Christian L. Hart      *East Central Oklahoma University*

**Board 17: Differences in self-esteem levels between long-term and short-term prisoners when compared to a control group**

Jamie M. Smith      *Southern Nazarene University*

**Board 18: Psychometric properties of the fear survey for adults with mental retardation**

Sylvia Z. Ramirez      *University of Texas-Pan American*  
James F. Lukenbill      *University of Texas at Austin*  
Peter L. Kranz      *University of Texas-Pan American*  
Maribel Barrera      *University of Texas-Pan American*

**Board 19: Worry and self-efficacy: Mediational effects of stress**

William E. Kelly

*Texas A&M-Kingsville*

Donald W. Daughtry

*Texas A&M-Kingsville***SWPA Invited Speaker**-Chaired by Paul R. Nail**Jeffrey R. Alberts***Indiana University***Anatomy of a super-organism**Thursday, 11:00 a.m.- 11:50 a.m.  
Ballroom E

From birth and throughout adult life rats aggregate and huddle in groups. Such huddling begins soon after birth. A group of infants in the nest is an integrated whole—a kind of super-organism—that has behavioral and physiological capabilities beyond those of the individuals comprising the group. Several lines of evidence identify the individual basis of group behavior, and computational modeling reveals the rules that spawn group behavior. Though there is lifelong continuity of huddling behavior, its structure changes dramatically. Infants huddle as individual automatons but by 10-days of age the huddle depends on a fundamental rule of sociality, and oxytocin manipulations begin to alter the group's behavior. A variety of behavioral, modeling, and physiological techniques reveal the form and function of this species-typical behavior during development.

Dr. Alberts is a professor at Indiana University. He received his Ph.D. from Princeton University (1974) in the Neural Science and Behavior program, after receiving Master degrees from Princeton (1972) and McMaster University (1970), where he had completed his B.A. He has been awarded research grants from NIH, NSF, and NASA. His honors include a Research Scientist Development Award and a MERIT Award from NIMH. At Indiana he has been Associate Vice President for Research and is active in the Center for the Integrative Study of Animal Behavior.

**SWPA Symposium: Creating a successful psychology student philanthropy course**

11:00 a.m.- 11:50 a.m.

Jacob Brickler Room

Chaired by Jennifer L. O'Loughlin-Brooks and Valerie T. Smith

**Creating a successful psychology service-learning student philanthropy course**

Jennifer L. O'Loughlin-Brooks

*Collin County Community College*

Valerie T. Smith

*Collin County Community College*

**SWPA Poster Session: General Psychology I**

11:30 a.m.- 12:45 p.m.

Capitol View Terrace

**Board 1: Political party affiliation and philosophical orientation**

Kelly A. Caver

*Texas Christian University*

Catherine M. Urbano

*Texas Christian University*

Robert E. Wickham

*Texas Christian University*

Michael L. Czuchry

*Texas Christian University*

Tiffany L. Sia

*Texas Christian University*

**Board 2: Political affiliation and approval ratings for the 2005 presidential candidates**

Jacqueline G. Powell

*Texas Christian University*

Kelly A. Caver

*Texas Christian University*

Ryan C. Kelly

*Texas Christian University*

Michael L. Czuchry

*Texas Christian University*

Tiffany L. Sia

*Texas Christian University*

**Board 3: Religious coping and religious affiliation**

A. Jerry Bruce

*Sam Houston State University*

Marsha J. Harman

*Sam Houston State University*

**Board 4: Relationship between religion and parental sexual discussion with teens**

Cole R. Davis

*Southwestern Oklahoma State University*

Melinda Burgess

*Southwestern Oklahoma State University*

Stephen R. Burgess

*Southwestern Oklahoma State University*

Caleb Shoaf

*Southwestern Oklahoma State University*

Paul Stermer

*Southwestern Oklahoma State University*

**Board 5: Religiosity predicts attitudes about homosexual relationships**

Brenda I. Mascorro

*University of Texas at Brownsville*

Claudia M. Sierra

*University of Texas at Brownsville*

Matthew C. Johnson

*University of Texas at Brownsville*

**Board 6: Attitudes toward forgiveness and propensity to forgive oneself and others**

Amanda L. Beuning	<i>Delta State University</i>
Heidi L. Eyre	<i>Delta State University</i>
Heather M. Peacock	<i>Delta State University</i>

**Board 7: Who tells teens what about sex?**

Cole R. Davis	<i>Southwestern Oklahoma State University</i>
Melinda Burgess	<i>Southwestern Oklahoma State University</i>
Stephen R. Burgess	<i>Southwestern Oklahoma State University</i>
Caleb Shoaf	<i>Southwestern Oklahoma State University</i>

**Board 8: Perceptions of college drinking behavior**

Holly B. LaPota	<i>Emporia State University</i>
Michael J. Leftwich	<i>Emporia State University</i>

**Board 9: Alcohol's effects on perceptions of physical attractiveness**

Ashley R. Webb	<i>University of Texas at San Antonio</i>
----------------	---

**Board 10: Music defined: A prototype analysis**

Joanna L. Hutchison	<i>Texas Christian University</i>
Angela C. Gonzales	<i>Texas Christian University</i>
Alisa A. Scott	<i>Texas Christian University</i>
Timothy L. Hubbard	<i>Texas Christian University</i>

**Board 11: Sex and generation based changes in aerobic capacity**

Ashley E. Schriewer	<i>Texas Lutheran University</i>
Kaleigh R. Emerson	<i>Texas Lutheran University</i>
Scott A. Bailey	<i>Texas Lutheran University</i>

**Board 12: Leadership and motivation in sport**

Anthony E. Bourgeois	<i>Texas A&amp;M-College Station</i>
Arnold D. LeUnes	<i>Texas A&amp;M-College Station</i>

**Board 13: Fake Hand Illusion: Size is not important**

Grant Benham	<i>University of Texas-Pan American</i>
--------------	---

**Board 14: Perceptions of amputees with a prosthesis**

Heather M. Scott	<i>Lamar University</i>
Edythe E. Kirk	<i>Lamar University</i>

**Board 15: Coping style and readiness to change in type 2 diabetics**

Kristin Reed	<i>University of North Texas</i>
Susan Franks	<i>University of North Texas, Health Sciences Center</i>
Scott Hilborn	<i>University of North Texas</i>

**Board 16: Night-sky watching and orientation to problem solving**

William E. Kelly	<i>Texas A&amp;M-Kingsville</i>
Donald W. Daughtry	<i>Texas A&amp;M-Kingsville</i>



**Board 17: Interactions between task difficulty and distractor congruency:  
Mean RT vs. accuracy**

Michael D. Nelson  
Philip A. Norfolk

*University of Missouri-Rolla  
University of Missouri-Rolla*

**Board 18: Attachment as a predictor of God image in university students**

Kris K. Bryant

*Southern Nazarene University*

**Board 19: Personality characteristics of incarcerated juveniles**

Kyra E. Savoy  
Lawrence S. Dilks  
Brooke D. Mayeaux  
Janice C. Marceaux  
Jacqueline F. Bourassa  
Burton J. Ashworth  
Marie A. Bourgeois

*McNeese State University  
McNeese State University  
McNeese State University  
McNeese State University  
McNeese State University  
McNeese State University  
McNeese State University*

**Board 20: Hurricane's Katrina and Rita, the news media, and stress**

Cedric Seys  
Ronald L. Stringfellow  
Mary Ellen McNaughton-Cassill

*University of Texas at San Antonio  
University of Texas at San Antonio  
University of Texas at San Antonio*

**Board 21: Psychological perspectives on the torture question**

Susan F. Castillo  
Amy Chung  
Sherine E. Kurian  
Maria S. Lamas  
Carl W. Scott  
Mary Jane Cuevas  
Lesley A. Wolfe

*University of St. Thomas  
University of St. Thomas  
University of St. Thomas  
University of St. Thomas  
University of St. Thomas  
University of St. Thomas  
University of St. Thomas*

**Psi Chi Invited Speaker**-Chaired by Richard A. Kasschau

**Charles Spielberger**

*University of South Florida*

**Measuring Emotions and Personality**

Thursday, 12:00 p.m.- 12:50 p.m.

Ballroom E

Charles D. Spielberger is Distinguished Research Professor of Psychology and Director of the Center for Research in Behavioral Medicine and Health Psychology at the University of South Florida, where he has been a faculty member since 1972, following prior tenured positions at Duke, Vanderbilt, and Florida State. An ABPP Diplomate in Clinical Psychology, Professor Spielberger has authored, coauthored, or edited over 400 professional publications, including a dozen books and the continuing, now 17-volume series on *Stress and Emotion* (1975-2004) with Irwin G Sarason. His *State-Trait Anxiety Inventory* is a widely accepted international standard for the measure of anxiety. The founding editor of the *American Journal of Community Psychology*, Professor Spielberger has numerous lifetime achievement awards from the APA, and from APA Divisions in Clinical, Community, and International Psychology. In 1991-92, Professor Spielberger was honored as the 100<sup>th</sup> president of the American Psychological Association. He went on to be President of the International Association of Applied Psychology, among many other national and international scientific societies, as well as being the 20th president of Psi Chi—the National Honor Society of Psychology from 1980 to 1983.

**SCPA Paper Session: Animal Learning I**

1:00 p.m.- 1:50 p.m.

William Barton Room

Chaired by Melissa Burns Cusato

**Pairbonding in ringneck dove: Partner preference or place preference?**

Stephanie Gleason

*Sweet Briar College*

Melissa Burns Cusato

*Sweet Briar College*

Brian Cusato

*Sweet Briar College***Variables that determine the Pavlovian conditioned response**

Emily G. Gean

*University of Texas at Austin*

Michael Domjan

*University of Texas at Austin***Effectiveness of an ecologically relevant stimulus on the conditioning of****Japanese Quail**

Carlina N. Muglia

*Sweet Briar College*

Brian Cusato

*Sweet Briar College***SWPA Paper Session: Social and Personality I**

1:00 p.m.- 2:15 p.m.

Jacob Brickler Room

Chaired by Robert D. Johnson

**Stereotypes about adolescents**

Mary L. Porter

*Arkansas State University*

Robert D. Johnson

*Arkansas State University*

David A. Saarnio

*Arkansas State University***Computer gaming characters and personality**

Anna E. Park

*Texas A&M-Commerce*

Tracy B. Henley

*Texas A&M-Commerce***Impression formation as a function of facial piercing and tattoos**

Jess Newsom

*Delta State University*

Cat Bishop

*Delta State University*

Scott A. Hutchens

*Delta State University***Paranormal belief: Survey of high school students using the PBS-R**

Debra J. Colvey

*Williams Baptist College*

**SWPA/CTUP Poster Session: Teaching**

1:00 p.m.- 2:15 p.m.

Capitol View Terrace

**Board 1: A critical thinking instrument for psychology majors**

Bernadette M. Gadzella

*Texas A&M-Commerce*

**Board 2: The importance of critical thinking to the field of special education**

Victoria Zascavage

*Texas A&M-Commerce*

Bernadette M. Gadzella

*Texas A&M-Commerce*

William G. Masten

*Texas A&M-Commerce*

**Board 3: Thinking processes and course grades for students enrolled in special education**

Bernadette M. Gadzella

*Texas A&M-Commerce*

Victoria Zascavage

*Texas A&M-Commerce*

**Board 4: An exploration of equal covariance baseline models for incremental fit in SEM**

Dennis L. Jackson

*University of Windsor*

Rebecca J. Purc-Stephenson

*University of Windsor*

**Board 5: Success in introductory statistics**

Roger E. Kirk

*Baylor University*

**Board 6: A survey of the statistics and methodology sequence of courses**

Bill J. Lammers

*University of Central Arkansas*

**Board 7: Are football jersey numbers really nominal data?**

Theodore S. Smith

*Texas A&M-Commerce*

**Board 8: What do psychology majors know about graduate study areas in psychology?**

Darcee L. Datteri

*Wichita State University*

**Board 9: Training and graduating school psychology students with disabilities**

Ramona M. Noland

*Sam Houston State University*

Rebecca A. Rugh

*Sam Houston State University*

**Board 10: Assessing learning disabilities in college students: A profile analysis**

Jeff Reese

*Abilene Christian University*

Erin E. Kelley

*Abilene Christian University*

Shanas Harris

*Abilene Christian University*

**Board 11: Student perceptions of online quizzing**

Kaira M. Hayes

*Fort Hays State University*

Heath Marrs

*Fort Hays State University*

**Board 12: A comparison of online open-book and traditional assessment techniques**

Kaira M. Hayes	<i>Fort Hays State University</i>
John R. McCain	<i>Fort Hays State University</i>
Marleah J. Augustine	<i>Fort Hays State University</i>
Heath Marrs	<i>Fort Hays State University</i>

**Board 13: Web-enhanced versus online psychology courses: Is there a difference?**

Scott A. Hutchens	<i>Delta State University</i>
-------------------	-------------------------------

**Board 14: Non-traditional versus traditional age college students: Characteristics of successful learners**

Sarah E. Henseler	<i>St. Edwards University</i>
Helen D. Just	<i>St. Edward's University</i>

**Board 15: Student ratings of university teaching in experientially-oriented courses**

Victoria Mosack	<i>Wichita State University</i>
Charles A. Burdsal	<i>Wichita State University</i>

**Board 16: Academic entitlement: An individual difference measure**

Karolyn J. Budzek	<i>University of Oklahoma at Norman</i>
Nicole Judice Campbell	<i>University of Oklahoma at Norman</i>

**Board 17: Type of testing and performance: An effort to reduce cheating on the in-class exams**

Sangeeta Singg	<i>Angelo State University</i>
Tasha N. Palmer	<i>Angelo State University</i>
Bethany L. McNeese	<i>Angelo State University</i>

**Board 18: Music & jelly beans: An introduction to psychology**

Kim Case	<i>University of Houston-Clear Lake</i>
Heather Hatchett	<i>University of Kentucky</i>

**Board 19: Using historic, non-psychological texts to teach psychology**

Cooper B. Holmes	<i>Emporia State University</i>
Kenneth A. Weaver	<i>Emporia State University</i>

**Board 20: From theory to practice: The effectiveness of positive psychology interventions in the classroom**

Irina I. Khramtsova	<i>Arkansas State University</i>
Sean M. Gearson	<i>Arkansas State University</i>
Laura A. Howard	<i>Arkansas State University</i>
Rachel R. Roland	<i>Arkansas State University</i>
Melissa D. Shortnacy	<i>Arkansas State University</i>
Coral U. Machado	<i>Arkansas State University</i>

**Board 21: International psychology resources for the psychology curriculum**

John M. Davis	<i>Texas State University</i>
Catherine A. Bower	<i>Texas State University-San Marcos</i>
Krystle A. Frahm	<i>Texas State University</i>
Richard B. Cano	<i>Texas State University-San Marcos</i>

**Board 22: "Authority teams" in applied psychology: Capitalizing on student interests**

Ralph J. McKenna	<i>Hendrix College</i>
------------------	------------------------

**Board 23: Human sexuality course impact on students' sexual knowledge and attitudes**

Ramona M. Noland	<i>Sam Houston State University</i>
Martha A. Bass	<i>Sam Houston State University</i>
Rosanne S. Keathley	<i>Sam Houston State University</i>
Gina G. Walker-Montoya	<i>Sam Houston State University</i>

**Board 24: Expectations of preschool literacy experiences and school preparedness**

Stephen R. Burgess	<i>Southwestern Oklahoma State University</i>
Cole R. Davis	<i>Southwestern Oklahoma State University</i>

**Board 25: Video game playing and school performance**

Paul Stermer	<i>Southwestern Oklahoma State University</i>
Stephen R. Burgess	<i>Southwestern Oklahoma State University</i>
Melinda Burgess	<i>Southwestern Oklahoma State University</i>
Cole R. Davis	<i>Southwestern Oklahoma State University</i>
Shalisa McCarter	<i>Southwestern Oklahoma State University</i>
Kelanie Jones	<i>Southwestern Oklahoma State University</i>
Miles Johnson	<i>Southwestern Oklahoma State University</i>

**Board 26: An abnormal psychology activity demonstrating normal and abnormal phobic anxiety**

Will H. Canu	<i>University of Missouri-Rolla</i>
--------------	-------------------------------------

**SAMR Paper Session: Topics in Regression**

1:00 p.m.- 3:00 p.m.      George Bonnell Room

Chaired by James A. Gillaspay, Jr. and Ira Bernstein

**Multiple regression: An overview**

Candace Gilmore	<i>Wichita State University</i>
Charles A. Burdsal	<i>Wichita State University</i>

**Logistic regression: Prediction of group membership**

Linda S. Hynan	<i>University of Texas Southwestern Medical Center</i>
----------------	--

**Advanced topics in regression**

Ira H. Bernstein	<i>University of Texas at Arlington</i>
------------------	---

**APA Continuing Education Workshop****Thomas Kubiszyn***University of Houston***Pediatric psychopharmacology in the schools:  
Advances, issues and role opportunities**Thursday, 1:00 p.m.- 5:00 p.m.  
Ballrooms G&H

Prescription of psychoactive drugs to children has increased dramatically in recent years, is commonly extrapolated from adult prescribing practices, and has generated much controversy. Empirical research has increased, but current practice outstrips the empirical support base, with even preschoolers taking multiple psychoactive medications (i.e., polypharmacy), and too often with little attention given to long-term developmental considerations. Recent regulatory warnings have heightened concerns, however, Psychologists, including school psychologists, commonly treat children who take psychotropic medications, but may lack current knowledge about the safety and efficacy of medications, especially in comparison to psychosocial interventions. Because both pediatric psychopharmacology and psychosocial research have expanded significantly over the last decade, and because the growing body of research is complex and highly technical, today's practitioners face an overwhelming task in trying to stay abreast of current developments.

Thomas Kubiszyn, Ph.D. is Professor of Educational Psychology and Director of Training for the Ph.D. School Psychology Program at the University of Houston, and is a past Assistant Executive Director for Professional Practice and Director of the Office of Policy and Advocacy in the Schools with the American Psychological Association (APA). He has been licensed psychologist in Texas since 1981, and is a member of the National Register of Health Service Providers in Psychology. He was chair of the APA Division 16 (School Psychology) Task Force on Psychopharmacology in the Schools from 1992-1995, and the Division's Task Force on Psychopharmacology, Learning and Behavior from 2002-2005 and has published several articles and chapters on pediatric psychopharmacology.

**SWPA Invited Speaker**-Chaired by Paul R. Nail**David Buss***University of Texas at Austin***The murder next door: Why the mind is designed to kill**Thursday, 2:00 p.m.- 2:50 p.m.  
Ballroom D

Today's address focuses on homicide adaptation theory, which offers a radical new explanation of why people kill. Murder has been a remarkably beneficial strategy that evolved to solve an astonishing array of adaptive problems. These include eliminating poor fitness vehicles, ascending status hierarchies, protecting social reputation, removing cost-inflicting competitors, destroying a rival's reproductive resources, and freeing up resources for future reproduction. Being killed, however, is extremely costly for victims. As soon as murder evolved as a strategy, selection immediately favored anti-homicide defenses, in turn favoring refined homicidal strategies to evade victim's defenses. A perpetual co-evolutionary arms race ensued. A study of 375 murderers and victims provides empirical support for facets of the theory, explaining many otherwise inexplicable design features of murder. The theory also parsimoniously accounts for several paradoxical phenomena, such as why women falsely believe that rapists will murder them despite the low conditional probability of rape-murder, and why people display an inordinate fear of getting killed by strangers more than by familiar others, despite the fact that most murderers know their victims, often intimately.

Dr. Buss received his Ph.D. from the University of California at Berkeley in 1981. He began his career in academics at Harvard, later moving to the University of Michigan before accepting his current position as Professor of Psychology at the University of Texas. The author of more than 180 scientific articles and 8 books, Dr. Buss has won numerous awards including the American Psychological Association (APA) Distinguished Scientific Award for Early Career Contribution to Psychology (1988), the APA G. Stanley Hall Lectureship (1990), the APA Distinguished Scientist Lecturer Award (2001), and the Robert W. Hamilton Book Award (2000) for *Evolutionary psychology: The new science of the mind* (Allyn & Bacon, 1999, 2004). He enjoys extensive cross-cultural research collaborations and lectures widely within the United States and abroad.



**SWPA Symposium: Change through communication**

2:30 p.m.- 3:20 p.m.

Creekside I

Chaired by Valerie D. Jackson

**Change through communication**

Valerie D. Jackson

*Prairie View A&M University*

**SWPA Poster Session: Cognition and Memory**

2:30 p.m.- 3:45 p.m.

Capitol View Terrace

**Board 1: Gender differences in cognitive performance of Alzheimer's patients**

Carl W. Scott

*University of St. Thomas*

**Board 2: Does the g loading of cognitive tests predict academic achievement?**

Bernardino Hernandez

*University of Texas at San Antonio*

Thomas R. Coyle

*University of Texas at San Antonio*

**Board 3: Investigating the relationship between stereotypicality and evaluation for African-American targets**

Raymond J. Green

*Texas A&M-Commerce*

**Board 4: The effects of sleep deprivation on complex cognitive skills**

Bridget L. McConnell

*Texas Lutheran University*

June J. Pilcher

*Clemson University*

James A. McCubbin

*Clemson University*

**Board 5: Field dependence/independence relationship with intelligence**

Amanda Martinez

*West Texas A&M University*

Timothy B. Atchison

*West Texas A&M University*

**Board 6: Body-fat: Mediating effects on gender differences in spatial cognition**

Alan S. Lenz

*Texas A&M-Corpus Christi*

Paul S. Merritt

*Texas A&M-Corpus Christi*

**Board 7: Reaction time complexity mediates age-memory relationships over the lifespan**

Thomas R. Coyle

*University of Texas at San Antonio*

Bernardino Hernandez

*University of Texas at San Antonio*

**Board 8: Representational momentum and motion capture**

Timothy L. Hubbard

*Texas Christian University*

Mallory L. Watson

*Texas Christian University*

**Board 9: Eyewitness identification over different time periods: Effects of race and bizarreness**

Scott A. Hutchens

*Delta State University*

**Board 10: Perceptions of stories delivered in different tones of voice**

Ryan W. Ferguson	<i>Texas Christian University</i>
Sarah C. Glass	<i>Texas Christian University</i>
Christian P. Hensby	<i>Texas Christian University</i>
Jacqueline G. Powell	<i>Texas Christian University</i>
Michael L. Czuchry	<i>Texas Christian University</i>

**Board 11: Memory for stories delivered in different tones of voice**

Catherine M. Urbano	<i>Texas Christian University</i>
Christian P. Hensby	<i>Texas Christian University</i>
Leslie K. Gann	<i>Texas Christian University</i>
Ryan C. Kelly	<i>Texas Christian University</i>
Michael L. Czuchry	<i>Texas Christian University</i>

**Board 12: Automatic memory of colored words in Stroop's paradigm**

Yung-Fei K. Kao	<i>Northeastern State University</i>
-----------------	--------------------------------------

**Board 13: Examining memory for distances with close-up views**

Dawn R. Cargo	<i>Texas Christian University</i>
Jon R. Courtney	<i>Texas Christian University</i>
Timothy L. Hubbard	<i>Texas Christian University</i>

**Board 14: What gorilla? An investigation of individual differences in inattentional blindness?**

Scott A. Hutchens	<i>Delta State University</i>
Page Logan	<i>Delta State University</i>

**Board 15: Visual change detection for emotional scenes**

Loranel M. Graham	<i>Our Lady of the Lake University</i>
-------------------	--

**Board 16: What did you say? My emotions got in the way!**

A. Jerry Bruce	<i>Sam Houston State University</i>
Marsha J. Harman	<i>Sam Houston State University</i>
Patricia D. Murphree	<i>Sam Houston State University</i>
Kathleen A. Treadway	<i>Sam Houston State University</i>

**SAMR/SWPA Invited Speaker**-Chaired by Linda S. Hynan

Irwin Sandler

*Arizona State University***Development and evaluation of a theory and research based preventive intervention for bereaved children**Thursday, 3:00 p.m.- 3:50 p.m.  
Ballroom E

A 25 year program of research of testing models of adaptation following bereavement will be presented. The findings from the research were used to design and evaluate a preventive intervention. The contribution of theory to program development and feedback from program evaluation to advance theory will be highlighted, including many interesting models of mediation, moderation, and growth over time.

**SCPA Paper Session: Animal Learning II**

3:00 p.m.- 3:50 p.m.

William Barton Room

Chaired by Fay A. Guarraci

**Intracranial amphetamine alters proceptive behavior and locomotion in paced mating**

Debra J. Hines

*St. Edwards University*

Fay A. Guarraci

*Southwestern University*

Russell J. Frohardt

*St. Edwards University***Mate selection influences the display of paced mating behavior in female rats**

Abby N. Diehl

*Southwestern University*

Elizabeth L. Joyce

*Southwestern University*

Jenifer L. Cohn

*Southwestern University*

Fay A. Guarraci

*Southwestern University*

**"Some guys get all the luck": Individual male rats are preferred consistently during mating tests**

Jennifer L. Lovell  
Jose J. Lopez  
Elizabeth L. Joyce  
Fay A. Guarraci

*Southwestern University*  
*Southwestern University*  
*Southwestern University*  
*Southwestern University*

**APA/SWPA Undergraduate/Graduate Student Workshop**

3:00 p.m.- 4:30 p.m.

Ballrooms A&B

**Entering the academic marketplace: Advice from experts**

Chaired by Clare Porac

Clare Porac  
Loretta Neal McGregor  
Stephen F. Davis

*American Psychological Association*  
*Arkansas State University*  
*Texas Wesleyan University*

**SWPA Workshop: Practical strategies and interventions for counseling the culturally diverse**

3:00 p.m.- 4:30 p.m.

Jacob Brickler Room

Chaired by Josephine De Los Santos

Veronica Castro  
Josephine De Los Santos

*University of Texas-Pan American*  
*University of Texas-Pan American*

**SAMR Business Meeting**

4:00 p.m.- 5:30 p.m.

George Bonnell Room

Chaired by Dennis L. Jackson

**SWPA Social Hour**

5:00 p.m.- 7:00 p.m.

Ballroom D

Hosted by Paul R. Nail



## Friday, April 14

### **CUPP/CTUP Continental breakfast and conversation hour**

8:00 a.m. - 8:50 a.m.

George Bonnell Room

Chaired by Matthew C. Johnson

### **SWPA Paper Session: Social and Personality II**

8:00 a.m. - 8:50 a.m.

Ballroom E

Chaired by Steven Ball

#### **The effect of statistical feedback on self-control**

Jay C. Brown

*Missouri State University*

Megan T. Arens

*Missouri State University*

#### **Affect mediation of social support and stress**

Kathrin Milbury

*University of Houston*

Linda K. Acitelli

*University of Houston*

#### **The automatic influence of social categories on prosocial behavior**

Brandon Randolph-Seng

*Texas Tech University*

#### **Theory of mind and set shifting in young children**

Megan Besozzi

*Texas A&M-Commerce*

Steven E. Ball

*Texas A&M-Commerce*

### **Psi Chi Paper Session I**

8:00 a.m. - 9:15 a.m.

Creekside I

Chaired by Lauren Scharff

#### **Religious imagery and mood: Effects of positive and negative visual stimuli**

Samantha J. Calhoun

*Henderson State University*

Todd Wiebers

*Henderson State University*

#### **The relationship of stress and time imposed deadlines on gender**

Erin L. Short

*Oklahoma Baptist University*

Bret M. Roark

*Oklahoma Baptist University*

#### **Pretest information and related factors affecting performance**

Janine S. Kesterson

*Henderson State University*

Todd Wiebers

*Henderson State University*

#### **Choosing friends by personality, activities, and beliefs**

Elizabeth A. Haney

*Oklahoma Baptist University*

**SWPA Workshop: Ethical and practical strategies for clinical assessment of culturally diverse individuals**

8:00 a.m.- 9:30 a.m.

Ballrooms G&H

Chaired by Josephine De Los Santos  
Josephine De Los Santos

*University of Texas-Pan American*

**SWPA Undergraduate Research Competition**

8:00 a.m.- 10:00 a.m.

Ballrooms A&B

Chaired by Charles Burdsal

**Differences between master's programs in counseling disciplines: An initial investigation**

Jonathan W. Priest

*University of Central Arkansas*

James A. Gillaspay, *Faculty Sponsor*

*University of Central Arkansas*

**Attitudes toward homosexuality: Gender, religiosity, and the nature-nurture issue**

Elena Sergeeva Yakunina

*Southern Arkansas University*

Edward P. Kardas, *Faculty Sponsor*

*Southern Arkansas University*

**Modeling the effects of distance and clutter on visual conspicuity**

Laurel A. Issen

*University of Texas at Austin*

Paul R. Nail, *Faculty Sponsor*

*University of Central Arkansas*

**Gender differences in self-discrepancies and their effect upon romantic relationships**

Aaron Z. Carlson

*Texas Tech University*

Christine A. Palmer

*Texas Tech University*

Lindsey M. Jasbring

*Texas Tech University*

Kristin C. Wood

*Texas Tech University*

Erin E. Hardin, *Faculty Sponsor*

*Texas Tech University*

**Size matters: Perception of nutrition through serving sizes**

Emily G. Taylor

*Southwestern University*

Mark M. Morrow

*Southwestern University*

Richard Osbaldiston, *Faculty Sponsor*

*Southwestern University*

**CTUP Symposium: Teaching psychological statistics to undergraduates**

9:00 a.m. - 9:50 a.m.

William Barton Room

Chaired by Charles G. Halcomb

Charles G. Halcomb  
Stephanie J. Hargrave  
Candace N. Lambdin  
Satoru Tokuda

*Wichita State University*  
*Wichita State University*  
*Wichita State University*  
*Wichita State University*

**SWPA/SCPA Poster Session**

9:00 a.m. - 10:15 a.m.

Capitol View Terrace

**Board 1: From chickens to dolphins: Operant psychology's expansion into marine mammal training in the 1950s**

James A. Gillaspay

*University of Central Arkansas*

**Board 2: Effects of housing condition on ethanol consumption in an operant situation**

Waylon J. Howard  
Billy T. Page  
Glenda C. Jackson  
Melissa A. Augustine  
Christine L. Yates  
Cathy A. Grover

*Emporia State University*  
*Emporia State University*  
*Emporia State University*  
*Fort Hays State University*  
*Emporia State University*  
*Emporia State University*

**Board 3: Voluntary oral nicotine consumption in C57BL/6J female mice**

Amy R. Pearce  
Alicia D. Burns

*Arkansas State University*  
*Arkansas State University*

**Board 4: Effects of dopaminergic and cholinergic agonists on interval timing behavior in rats**

Darius D. Donohue  
Grant Sawyer  
Jennifer J. Higa-King

*Texas Christian University*  
*Texas Christian University*  
*Texas Christian University*

**Board 5: The von Restorff effect in Long Evans rats**

Claudia E. Juarez-Maldonado  
M. Guadalupe Ortega-Saavedra  
Sara E. Cruz-Morales  
J. C. Pedro Arriaga-Ramirez

*National Autonomous University of Mexico at Iztacala*  
*National Autonomous University of Mexico at Iztacala*  
*National Autonomous University of Mexico at Iztacala*  
*National Autonomous University of Mexico at Iztacala*



**Board 6: Serial position effects in social transmission of food preference**

J. C. Pedro Arriaga-Ramirez

*National Autonomous University of Mexico at Iztacala*

M. Guadalupe Ortega-Saavedra

*National Autonomous University of Mexico at Iztacala***Board 7: Sensitivity to mechanical stimulation in an animal model of MS**

Rebecca R. Weaver

*University of Texas at Arlington*

Perry N. Fuchs

*University of Texas at Arlington***Board 8: A comparison of personality traits in captive big cats**

Scott L. Coleman

*University of North Texas*

Roger L. Mellgren

*University of Texas at Arlington***SWPA Paper Session: Applied**

10:00 a.m.- 10:50 a.m.

Jacob Brickler Room

Chaired by David A. Saarnio

**Quality of life as a function of gender in supported housing**

Henry J. Chiasson

*Stephen F. Austin State University***Perceptions of students who report cheating and students who cheat**

Arden T. Miller

*Missouri State University*

Carol F. Shoptaugh

*Missouri State University*

Annette H. Parkerson

*Missouri State University*

Whitney J. Miller

*Missouri State University*

Natalie D. Brunnworth

*Missouri State University***The relations between components of jobs and life satisfaction**

Rebecca L. Breckenridge

*Arkansas State University*

David A. Saarnio

*Arkansas State University***SWPA Paper Session: General Psychology II**

10:00 a.m.- 11:15 a.m.

Ballrooms G&amp;H

Chaired by Michael Murphy

**Investigation of the influence of religiosity and profanity on retention**

Anna E. Short

*Henderson State University*

W. Paul Williamson

*Henderson State University***Performance anxiety, perfectionism, and depression among college music performers: A pilot study**

Svetlana A. Serova

*University of North Texas***Determinants of function transfer in humans**

Alan D. Foltz

*Henderson State University*

Toby J. Hendrix

*Henderson State University*

Rafael Bejarano

*Henderson State University*

**Musical scales and evaluations of speed and tempo change**

William G. Collier

*University of North Carolina at Pembroke*

Timothy L. Hubbard

*Texas Christian University***Effectiveness of religious and nonreligious coping styles**

Michael D. Murphy

*Ouachita Baptist University***SWPA Invited Speaker**-Chaired by Paul R. Nail**Robert Montgomery***University of Missouri-Rolla***Non-cognitive (personality) measures and college student success**

Friday, 10:00 a.m.- 10:50 a.m.

Ballroom E

Nationally, nearly half (47%) of all those who begin college never graduate. Today's presentation will review how a university is working to increase its graduation rates by using data from a seven-year study, tracking academic progress, and using student personality traits as assessed by the Hogan Personality Inventory (HPI) in addition to more traditional measures such as ACT test scores and high school G.P.A. Initial results indicate that key non-cognitive measures might not only be used in selection but could also be used to help build intervention strategies not previously addressed by traditional at-risk student models. Concept strategies for implementation will be discussed.

Dr. Montgomery is Professor and Chair of the Psychology Department at the University of Missouri-Rolla. He was president of the Southwestern Psychological Association in 1992 and president of the Society of Southwestern Social Psychologists in 1989. He received his Ph.D. in Social/Personality Psychology with an emphasis in statistics and research design from Oklahoma State University and his B.A. in Psychology from Bethany College in Bethany, W. Va.

**SWPA Invited Speaker**-Chaired by Paul R. Nail**Joshua Aronson***New York University***The nurture of intelligence**

11:00 a.m.- 11:50 a.m.

Ballroom D

Human intelligence is more fragile than we tend to think. It is fragile because it is in most situations a social transaction, which occurs within a web of social relations. In this talk Dr. Aronson will discuss one social force that undermines people's academic achievement—stereotypes alleging the intellectual ability of certain minorities. Such stereotypes often create an atmosphere of threat, mistrust, and low expectations. In this atmosphere, academic achievement, motivation and the self-concepts of minority students is often undermined. Dr. Aronson will discuss how these social forces explain part of the achievement gap between minorities and whites. He also will discuss research that shows us how to help students at risk for underperformance.

Dr. Aronson is associate professor of psychology and education at NYU. He received his Ph.D. in 1992 from Princeton University. Aronson's research focuses on the social and psychological influences on academic achievement. Aronson is internationally known for his research on minority student achievement, research which offers a strong challenge to traditional, genetic explanations of why African Americans and Latinos perform less well on tests of intelligence than their white counterparts. He has authored numerous chapters and scholarly articles on this work and is the Editor of *Improving academic achievement: Impact of psychological factors on education* (Academic Press). Aronson has received numerous awards and grants for his research including Early Career awards from the Society for the Psychological Study of Social Issues and the National Science Foundation, and the G. Stanley Hall Award from the American Psychological Association. He is currently co-director (with C. Steele) of the National Task force on the Achievement Gap, at NYU.

**SWPA Poster Session: General II**

11:00 a.m.- 12:15 p.m.

Capitol View Terrace

**Board 1: Using a computer based screener to assess mild cognitive impairment**Larry A. Norsworthy  
Jeff Reese*Abilene Christian University*  
*Abilene Christian University***Board 2: Computer-mediated and cellular phone communication in college students**Shirley M. Ogletree  
Ryan A. Drake*Texas State University-San Marcos*  
*Texas State University-San Marcos***Board 3: Relations of video game playing to empathy**Paul Stermer  
Stephen R. Burgess  
Melinda Burgess  
Cole R. Davis  
Shalisa McCarter  
Kelanie Jones  
Miles Johnson*Southwestern Oklahoma State University*  
*Southwestern Oklahoma State University*  
*Southwestern Oklahoma State University*  
*Southwestern Oklahoma State University*  
*Southwestern Oklahoma State University*  
*Southwestern Oklahoma State University*  
*Southwestern Oklahoma State University***Board 4: The influence of visual display information on customer behavior**Jeffrey L. Oldenkamp  
Lauren Scharff*Stephen F. Austin State University*  
*Stephen F. Austin State University***Board 5: A preliminary exploration of on-line gamers' personal relationships**

Michael A. Vandehey

*Midwestern State University***Board 6: Factors that influence the perceptions toward minority supervisors**

Sherine E. Kurian

*University of St. Thomas***Board 7: Is cultural sensitivity training effective? Attitudes toward cultural diversity**Amy Chung  
Sherine E. Kurian*University of St. Thomas*  
*University of St. Thomas***Board 8: Self-reports of business building competency in candidate and incumbent salespeople**Trelitha R. Bryant  
George Dudley  
Shannon L. Goodson*Behavioral Sciences Research Press*  
*Behavioral Sciences Research Press*  
*Behavioral Sciences Research Press***Board 9: R-e-s-p-e-c-t: How college students address professors in e-mail communications**Shirley M. Ogletree  
Christopher Frost  
Erin E. Kauffman  
Casey B. Nixon*Texas State University-San Marcos*  
*Texas State University-San Marcos*  
*Texas State University-San Marcos*  
*Texas State University-San Marcos*

**Board 10: Serving sizes: Behavior compared to manufacturer recommendations**

Wyn E. Taylor

*Texas Wesleyan University*

Marisol J. Benavidez

*Texas Wesleyan University*

Maria M. Alvarez

*Texas Wesleyan University***Board 11: The influence of exaggeration on sales selection and performance outcomes**

George Dudley

*Behavioral Sciences Research Press*

Shannon L. Goodson

*Behavioral Sciences Research Press*

Trelitha R. Bryant

*Behavioral Sciences Research Press***Board 12: Age and the stability of self-esteem in rural women**

James M. Rafferty

*Bemidji State University*

Carol L. Bennett

*University of North Dakota*

Russell L. Bennett

*Bemidji State University***Board 13: Alternate oral instructions for the TONI-3**

James R. Stacks

*Texas A&M-Commerce*

Paul R. Gesn

*Pro-Ed, Inc.***Board 14: The gestural basis of speech: An EMG study**

David R. Higginbotham

*University of Louisiana-Lafayette*

Matthew I. Isaak

*University of Louisiana-Lafayette***Board 15: Anticipatory facial expressions predict response inhibition or disinhibition to tickling**

Harvey J. Ginsburg

*Texas State University*

Casey B. Nixon

*Texas State University-San Marcos***Board 16: Display rule knowledge and prosocial intent in preschool children**

Tara M. Cole

*University of Arkansas at Fayetteville*

Joni D. Williams

*University of Arkansas at Fayetteville***Board 17: Allocation of attentional resources as a function of task difficulty: An event-related fMRI study**

Michael D. Nelson

*University of Missouri-Rolla***Board 18: Effects of time limits on MRT's relationship to POI tests**

Jessie L. Weed

*West Texas A&M University*

Timothy B. Atchison

*West Texas A&M University*

**Board 19: A pilot study regarding the long term neurobehavioral effects of Agent Orange**

Lawrence S. Dilks	<i>McNeese State University</i>
Janice C. Marceaux	<i>McNeese State University</i>
Brooke D. Mayeaux	<i>McNeese State University</i>
Jacqueline F. Bourassa	<i>McNeese State University</i>
Burton J. Ashworth	<i>McNeese State University</i>
Sheila B. Hixson	<i>McNeese State University</i>
Marie A. Bourgeois	<i>McNeese State University</i>

**Board 20: The parenting scale: Validity with two child behavior problems measures**

Raegan B. Smith	<i>Oklahoma State University</i>
Tamara C. Newcomb	<i>Oklahoma State University</i>
Chuck Edgington	<i>Oklahoma State University</i>
Maureen A. Sullivan	<i>Oklahoma State University</i>
Cynthia A. Hodges	<i>Oklahoma State University</i>

**Board 21: The nature of peer support for students with disabilities**

Victoria Zascavage	<i>Texas A&amp;M-Commerce</i>
Philip L. Armstrong	<i>Texas A&amp;M-Commerce</i>

**Board 22: Development of an inventory to measure sibling support**

Aletha R. Miller	<i>University of North Texas</i>
Arielle Edwards	<i>University of North Texas</i>

**Board 23: Pets as sources of support in children and adolescents**

Dena L. Matzenbacher	<i>McNeese State University</i>
Sunshine D. Radford	<i>McNeese State University</i>

**Board 24: Death anxiety in the elderly**

Steve J. DePaola	<i>Thomas University</i>
Marissa D. Phillips	<i>Thomas University</i>
Shannon Hurst	<i>Thomas University</i>
Jaymi Williams	<i>Thomas University</i>
Claire Avery	<i>Thomas University</i>

**Board 25: Death anxiety and personal anxiety among older adults**

Marissa D. Phillips	<i>Thomas University</i>
Steve J. DePaola	<i>Thomas University</i>
Shannon Hurst	<i>Thomas University</i>
Jaymi Williams	<i>Thomas University</i>
Claire Avery	<i>Thomas University</i>

**SWPA Paper Session: Developmental Psychology**

12:00 p.m.- 12:50 p.m.

Jacob Brickler Room

Chaired by: Steven E. Ball

**Theory of mind and deception in young children**

Amie L.C. Singleton

*Texas A&M-Commerce*

Steven E. Ball

*Texas A&M-Commerce*

Brian S. Ball

*Texas A&M-Commerce***Mother-child discourse and the development of emotion regulation**

Joni D. Williams

*University of Arkansas at Fayetteville*

Tara M. Cole

*University of Arkansas at Fayetteville***A correlational study of theory of mind, attention, and executive function in 5 to 6 year old boys**

Mary E. McGlamery

*Texas A&M-Commerce*

Steve E. Ball

*Texas A&M-Commerce*

Tracy B. Henley

*Texas A&M-Commerce*

Megan Besozzi

*Texas A&M-Commerce***SWPA Symposium: The academic side of character development**

12:00 p.m.- 12:50 p.m.

Ballrooms A&amp;B

Chaired by Chrisanne M. Christensen and Deborah J. Wilson

Chrisanne M. Christensen

*Southern Arkansas University*

Deborah J. Wilson

*Southern Arkansas University***SWPA Symposium: The effects of child sexual abuse**

12:00 p.m.- 12:50 p.m.

Ballrooms G&amp;H

Chaired by Jeffrey N. Wherry

Jeffrey N. Wherry

*Abilene Christian University*

Heidi M. Rhodes

*Abilene Christian University*

Larry A. Norsworthy

*Abilene Christian University*

Kacee A. Junco

*Abilene Christian University*

Christopher C. Covington

*Abilene Christian University*

Shelly R. Luster

*Abilene Christian University*

Veronica A. Smith

*Abilene Christian University*

Derek C. Bowman

*Abilene Christian University*

Rita A. Carr

*Abilene Christian University*

**Psi Chi Faculty Advisor Luncheon**

Hosted by Richard A. Kasschau and Virginia Andreoli Mathie

Friday, 12:00 p.m.- 1:30 p.m.  
Rojo Red Restaurant

**SCPA Paper Session: Animal Learning III**

12:30 p.m.- 1:50 p.m.

William Barton Room

Chaired by Scott A. Bailey

**A possible method for operant conditioning in cuttlefish**

Jesse E. Purdy

*Southwestern University*

Joshua Neese

*Southwestern University*

Neil Minocha

*Southwestern University*

**Prawn-in-a-tube procedure: Habituation or associative learning in cuttlefish?**

Jesse E. Purdy

*Southwestern University*

Anne E. Peters

*Southwestern University*

Elizabeth M. Riedlinger

*Southwestern University*

**Within-trial oscillations in sipper contact: A measure of approach-avoidance conflict in consummatory successive negative contrast?**

Alan M. Daniel

*Texas Christian University*

Mauricio R. Papini

*Texas Christian University*

**Administration of the kappa opioid agonist u-50,488h after the first downshift trial prolongs recovery from consummatory successive negative contrast**

Michael David Wood

*Texas Christian University*

Jacob N. Norris

*Texas Christian University*

Mauricio R. Papini

*Texas Christian University*



**SWPA Invited Speaker**-Chaired by Paul R. Nail**Elliot Aronson***University of California at Santa Cruz***Cognitive dissonance, the jigsaw classroom, the Columbine massacre, and George W. Bush**1:00 p.m.- 1:50 p.m.  
Ballroom D

SWPA President, Paul R. Nail, will interview Dr. Aronson regarding his ideas and research over the past 5 decades: How he helped Leon Festinger develop the Theory of Cognitive Dissonance, how he came to write *The Social Animal*, what led him to invent the jigsaw classroom, why he wrote his analysis of the Columbine High School Massacre, *Nobody Left to Hate*, as well as the book he is currently writing, *Mistakes Were Made But Not By Me: Self Justification in Public and Private Life*. Dr. Aronson is Professor Emeritus at the University of California, Santa Cruz. He has written or edited over 20 books, including *Age of propaganda*, *Nobody left to hate*, and *The handbook of social psychology*. He is the only person in the 120-year history of the American Psychological Association to have received all three of its highest academic awards: For Distinguished Research, for Distinguished Teaching, and for Distinguished Writing. Among his other awards are the Gordon Allport prize for his contributions to inter-racial harmony and the Humanitarian Award from the Texas Classroom Teachers Association. In 2001, he was listed among the 100 most influential psychologists of the 20th Century. His most recent publication (2005) is a children's book that he wrote in collaboration with Ruth Aronson (his 7-year-old-granddaughter), *The Adventures of Ruthie and a Little Boy Named Grandpa*.

**SWPA Poster Session: Gender, Ethnicity, and Culture**

1:30 p.m.- 2:45 p.m.

Capitol View Terrace

**Board 1: Minorities in the workplace: Social interaction among coworkers**

Kent Serratos

*University of St. Thomas***Board 2: Effects of diversity on stress and satisfaction in the workplace**

Brittany R. Dusek

*University of St. Thomas***Board 3: Cross- vs. within-ethnic attractiveness judgment between Caucasian and Taiwanese revisited**

Wai (Ada) N. Woo

*University of Texas at Arlington*

Ira H. Bernstein

*University of Texas at Arlington***Board 4: Coping style and culture: Comparing Cuban immigrants and native-born Americans**

Sarah E. Henseler

*St. Edwards University*

Erika C. Cajas

*St. Edwards University***Board 5: College Success and Ethnicity**

Mary Ellen McNaughton-Cassill

*University of Texas at San Antonio*

Marco L. Hernandez

*University of Texas at San Antonio*

Ophelia O. Poole

*University of Texas at San Antonio*

Casey S. Richards

*University of Texas at San Antonio***Board 6: Systematic review of studies assessing eating disorders and Hispanic acculturation**

Molly Schamel

*University of Texas-Pan American*

Kristin L. Croyle

*University of Texas-Pan American***Board 7: Ethnic identity and resiliency: Comparison of relationships across ethnic groups**

Sarah E. Henseler

*St. Edwards University***Board 8: Committed relationship satisfaction, parental bonds, and sexual behavior**

Naomi DeLeon

*Lamar University*

Edythe E. Kirk

*Lamar University***Board 9: Gender specificity in parental and romantic attachment**

Jessica L. DeFilippo

*Southwestern University*

Elissa L. Lewis

*Southwestern University*

Bryan D. Neighbors

*Southwestern University***Board 10: Benevolent sexism and implicit theories of relationships**

Dawna J. Campbell

*Sam Houston State University*

**Board 11: Elementary school children's beliefs about gender stereotypes in education**

Jean M. Low	<i>University of Louisiana-Monroe</i>
B. Jean Cottingham	<i>University of Louisiana-Monroe</i>
Jared S. Cox	<i>University of Louisiana-Monroe</i>

**Board 12: Stress differences among women students**

Bernadette M. Gadzella	<i>Texas A&amp;M-Commerce</i>
Catherine Carvalho	<i>Texas A&amp;M-Commerce</i>
William G. Masten	<i>Texas A&amp;M-Commerce</i>

**Board 13: Emotional conquest strategies in nonverbal communication**

Alan S. Lenz	<i>Texas A&amp;M-Corpus Christi</i>
Steven D. Seidel	<i>Texas A&amp;M-Corpus Christi</i>

**Board 14: Media's influence on body image and attractiveness in men**

Stella D. Garcia-Lopez	<i>University of Texas at San Antonio</i>
Laura Flores	<i>University of Texas at San Antonio</i>

**Board 15: Adaptive significance of female physical attractiveness: Role of enhanced lips**

Mary B. Bienvenu	<i>McNeese State University</i>
Carl Bartling	<i>McNeese State University</i>

**Board 16: Video game playing experience and preferences in males and females**

Paul Stermer	<i>Southwestern Oklahoma State University</i>
Stephen R. Burgess	<i>Southwestern Oklahoma State University</i>
Melinda Burgess	<i>Southwestern Oklahoma State University</i>
Shalisa McCarter	<i>Southwestern Oklahoma State University</i>
Cole R. Davis	<i>Southwestern Oklahoma State University</i>
Kelanie Jones	<i>Southwestern Oklahoma State University</i>
Miles Johnson	<i>Southwestern Oklahoma State University</i>

**SWPA Paper Session: Teaching**

2:00 p.m.- 2:50 p.m.

Jacob Brickler Room

Chaired by Sandra Rainey and Charles A. Burdsal

**What open ended comments tell you about professors with poor student ratings**

Charles A. Burdsal	<i>Wichita State University</i>
Paul D. Harrison	<i>Wichita State University</i>

**The impact of class and student education level on teaching evaluation instruments**

Veronica D. Hinkle	<i>Wichita State University</i>
Charles A. Burdsal	<i>Wichita State University</i>

**If you're that important why aren't you in a history of psychology text**

Virginia C. Hoelscher  
Leah J. Brown  
John P. Hall  
Stephen F. Davis

*Texas Wesleyan University*  
*Texas Wesleyan University*  
*Texas Wesleyan University*  
*Texas Wesleyan University*

**Taking a psychology of religion course**

Joy-Del T. Snook  
Mark G. Hartlaub

*Texas A&M-Corpus Christi*  
*Texas A&M-Corpus Christi*

**SCPA Invited Speaker**-Hosted by Jesse Purdy**Michael J. Ryan**

*University of Texas at Austin*

**Sexual selection: The brain and the peacock**

Friday, 2:00 p.m.- 2:50 p.m.

Ballroom E

Dr. Ryan studies animal behavior. Most of his work has addressed sexual selection and communication in frogs and fish. He is especially interested in integrating an understanding of the mechanisms of communication involved in mate attraction with the evolutionary consequences of sexual selection. He received his Ph. D. from the Section of Neurobiology and Behavior, Cornell University in 1982, and was a Miller Fellow in the Museum of Vertebrate Zoology at the University of California, Berkeley for the next two years. In 1984 he became an Assistant Professor at the University of Texas, Austin, where he is currently the Clark Hubbs Regents Professor in Zoology in the Section of Integrative Biology. He is also a Research Associate at the Smithsonian Tropical Research Institute in Panama. His research addresses issues in sexual selection and communication, and emphasizes an integrative analysis that combines approaches from population biology, behavioral ecology, phylogenetics, and neurobiology. Dr. Ryan received the Young Investigator Award from the American Society of Naturalists in 1985, was a Guggenheim Fellow in 1998, and was elected to the American Academy of Arts and Sciences in 2001.

**SWPA Paper Session: Cognition and Memory**

2:00 p.m.- 2:50 p.m.

Ballrooms G&H

Chaired by Aneeq Ahmad

**Implicit personality theory and information-consistency in memory**

Ashley N. Frost

*Henderson State University*

Aneeq Ahmad

*Henderson State University*

**The serial position effect in television advertising**

Steve T. Brewer

*Rogers State University*

Leighann B. Hughes

*Rogers State University*

Angela L. Blanck

*Rogers State University*

Stephanie D. Garrison

*Rogers State University*

Robert L. Boughner

*Rogers State University*

**The effect of chronic methamphetamine use on cognitive processing**

Deborah L. Stote

*University of Texas at Austin*

**Psi Chi**

**A Face-to-face conversation with Elliot Aronson**

Chaired by Richard A. Kasschau

Friday, 2:00 p.m.- 2:50 p.m.

Creekside I

**SWPA Paper Session: Gender, Ethnicity and Culture I**

3:00 p.m.- 3:50 p.m.

Ballrooms A&amp;B

Chaired by Helen D. Just

**Social awareness and ethnic identity**Mark G. Hartlaub  
Pamela Brouillard*Texas A&M-Corpus Christi*  
*Texas A&M-Corpus Christi***Is relaxation training better than no instruction for decreasing anxiety?**Russell J. Frohardt  
Helen D. Just  
Debra J. Hines  
Dinah E. Nesenholtz*St. Edwards University*  
*St. Edwards University*  
*St. Edwards University*  
*St. Edwards University***The development of racial identification among African-American college students and its relation to institutional preferences**Courtney C. Heard  
Mark G. Hartlaub*Texas A&M-Corpus Christi*  
*Texas A&M-Corpus Christi***The role of acculturation on Hispanics' perceptions of sexual harassment**

Jared A. Montoya

*University of Texas at Brownsville***CUPP Symposium: Symposium for aspiring and new department chairs**

3:00 p.m.- 3:50 p.m.

George Bonnell Room

Chaired by Scott A. Bailey

Scott A. Bailey  
Arnold D. Froese  
Kenneth A. Weaver  
Loretta Neal McGregor*Texas Lutheran University*  
*Sterling College*  
*Emporia State University*  
*Arkansas State University***Psi Chi Poster Session**

3:00 p.m.- 4:15 p.m.

Capitol View Terrace

**Board 1: Relevant and irrelevant transcripts: Effects of prior information and collaboration**Brooke O. Breaux  
Theresa A. Wozencraft, *Faculty Sponsor**University of Louisiana-Lafayette*  
*University of Louisiana-Lafayette***Board 2: Suppression of unwanted memories in various ages**Kristin R. Wood  
Ruth Marisa Herrera-Conaway  
Kathleen M. Donovan, *Faculty Sponsor**University of Central Oklahoma*  
*University of Central Oklahoma*  
*University of Central Oklahoma*

**Board 3: Photographic effects on memory**

Genevieve E. Wright

*Lamar University*Edythe E. Kirk, *Faculty Sponsor**Lamar University***Board 4: More than just intelligence: The role personality plays in student performance**

Emily L. Gill

*University of Missouri-Rolla*James H. Martin, *Faculty Sponsor**University of Missouri-Rolla***Board 5: Exploring the effects of gender roles on psychological health**

Amy B. Jordan

*Texas State University-San Marcos*Shirley M. Ogletree, *Faculty Sponsor**Texas State University-San Marcos***Board 6: What I say about you: What I say about me**

Mackinzie K. Meyer

*Stephen F. Austin State University*Theodore D. Joseph, *Faculty Sponsor**Stephen F. Austin State University***Board 7: Cover girls and banished boys: depictions of children on magazine covers**

Emily L. Johnson

*St. Edwards University***Board 8: The evaluation of person-centered information**

Ronald R. Holder

*Our Lady of the Lake University***Board 9: Associations between attachment style and expectations about behaviors in relationships**

Charles D. Valadez

*University of Texas at San Antonio*Dorothy A. Flannagan, *Faculty Sponsor**University of Texas at San Antonio***Board 10: Want a long-term relationship? You better have a broken heart!**

Brendan Dunne

*Northwest Vista College*Don Lucas, *Faculty Sponsor**Northwest Vista College***Board 11: What's hot and what's not when choosing a romantic partner**

Alexandra N. Ramsey

*Arkansas State University*Amy R. Pearce, *Faculty Sponsor**Arkansas State University***Board 12: The music and the madness: Perceptions of artists and their art**

Emily L. Johnson

*St. Edwards University*

Andrew W. Nichols

*St. Edwards University***Board 13: Heavy metal music's effect on affect**

David T. Cooley

*Oklahoma Baptist University***Board 14: Internal and external factors associated with sexual risk-taking in college**

Mary E. Pinnell

*Southwestern University*

Molly K. Peterson

*Southwestern University*

Bryan D. Neighbors

*Southwestern University*

**Board 15: Differences in personality development between individualistic and collectivist cultures**

Kelly M. Williams	<i>Oklahoma City University</i>
Amber G. Marzioli	<i>Oklahoma City University</i>
Amy E. Cataldi, <i>Faculty Sponsor</i>	<i>Oklahoma City University</i>

**Board 16: To Greek or not to Greek: That is the question**

Sarah L. Rossmiller	<i>Stephen F. Austin State University</i>
Daniel W. Reuther	<i>Stephen F. Austin State University</i>
Christina N. Potts	<i>Stephen F. Austin State University</i>
Gary C. Rice	<i>Stephen F. Austin State University</i>
Theodore D. Joseph, <i>Faculty Sponsor</i>	<i>Stephen F. Austin State University</i>

**Board 17: Paranormal beliefs within a church population**

Brittany L. Foley	<i>Williams Baptist College</i>
Paul A. Rhoads, <i>Faculty Sponsor</i>	<i>Williams Baptist College</i>

**Board 18: Shyness and its relationship to academic performance**

Virginia M. Doan	<i>Williams Baptist College</i>
Paul A. Rhoads, <i>Faculty Sponsor</i>	<i>Williams Baptist College</i>

**Board 19: Attitudes towards corporal punishment as a function of religious beliefs and political ideology**

Melissa L. Bradley	<i>University of Central Arkansas</i>
James A. Gillaspay, <i>Faculty Sponsor</i>	<i>University of Central Arkansas</i>

**Board 20: Prejudice and partisanship: the connection between racial and political attitudes**

Carlee M. McConnell	<i>Southwestern University</i>
Elissa L. Lewis	<i>Southwestern University</i>



**SWPA Presidential Address**-Chaired by Edward P. Kardas**Paul R. Nail***University of Central Arkansas***Explorations in cognitive dissonance (whatever that means?)**Friday, 4:00 p.m.- 4:50 p.m.  
Ballroom D

Today's address will review major events in the development of cognitive dissonance theory as a backdrop to a presentation of some of Dr. Nail's own dissonance research over the past decade. He will focus on three major, related changes in the theory: How and why the theory evolved (a) from a theory essentially concerned with the need for logic-like consistency among related cognitions (Festinger, 1957) to a theory about the need to maintain one's overall sense of self (Aronson, 1968; 1999; McGregor, 2004; Steele, 1988), (b) from a fundamentally nomothetic theory to a largely idiographic one, and (c) from a theory that had originally focused on direct methods of dissonance reduction (i.e., attitude change / rationalization) to one that currently emphasizes more indirect methods (viz., fluid compensation). Notwithstanding that these and other changes in the theory have been data driven, there still appear to be cases in the world beyond the experimental laboratory that illustrate just "how correct the original statement of the theory had been" (Festinger, 1987/1999, p. 383). Paul R. Nail received his Ph.D. in 1981 from Texas Christian University where he studied under Steve Cole and S. B. Sells. He has been a member of SWPA since 1978. He has served the organization in various capacities over the years-as Oklahoma Delegate and Executive Council Member, as President and Program Chair of the Society of Southwestern Social Psychologists, as a symposium organizer, as a session chair, and as a submission reviewer for the annual convention. His students regularly participate in SWPA's undergraduate research competitions. Besides individual differences in dissonance phenomena, his research interests focus on prejudice and on social influence in groups. His articles have appeared in major journals such as *Psychological Bulletin*, *Journal of Personality and Social Psychology*, and *Personality and Social Psychology Bulletin*. In the spring of 2005, Paul took early retirement from Southwestern Oklahoma State University to start a second career at his new home, the University of Central Arkansas.

SWPA 2006

**Marriott Austin at the Capitol**

Friday, April 14<sup>th</sup>

**SWPA Business Meeting**

5:15 p.m.- 6:15 p.m.

Chaired by Paul R. Nail

Ballroom D

**Psi Chi Awards Ceremony**

6:30 p.m.- 7:30 p.m.

Hosted by Richard A. Kasschau

Creekside I



## **Saturday, April 15**

**PT@CC Invited Speaker**-Chaired by Jennifer O'Loughlin-Brooks

**Sharon Burson**

*Temple College*

**Live dangerously:  
Introduce general psychology students to research**

9:00 a.m.- 9:50 a.m.  
Ballroom E

Introducing General Psychology students to research is an instructional challenge. The majority of students in General Psychology are not psychology majors and may have a "will that be on the test?" mentality to the topic. Introductory students often have misperceptions and/or very erroneous ideas about research. And instructors encounter the challenge to introduce research within the limited time constraints. Ideas, techniques and suggestions will be identified to overcome the most common barriers to an effective introduction to psychological research.

**SWPA Workshop: Team approach to assessing diverse children with autism**

9:00 a.m.- 9:50 a.m.

Ballroom D

Chaired by Cheryl W. Fielding

Terry P. Overton  
Josephine De Los Santos  
Cheryl W. Fielding

*University of Texas-Pan American  
University of Texas-Pan American  
University of Texas-Pan American*

## **SWPA Symposium: Sin: The psychology of moral failure in religious populations**

9:00 a.m.- 9:50 a.m.

Ballrooms A&B

Chaired by Richard A. Beck

Richard A. Beck

*Abilene Christian University*

### **SWPA Poster Session: Social and Personality**

9:00 a.m.- 10:15 a.m.

Capitol View Terrace

#### **Board 1: Do people really think freedom and responsibility are positively correlated?**

Sherri C. Ezell

*University of Louisiana-Monroe*

Melinda K. Robinson

*University of Louisiana-Monroe*

Candi L. Hill

*University of Louisiana-Monroe*

Keith A. Wilkerson

*University of Louisiana-Monroe*

Joseph R. McGahan

*University of Louisiana-Monroe*

#### **Board 2: Explaining changes in voting preference over time in university students**

Sarah C. Gomillion

*Southwestern University*

#### **Board 3: Cognitive reactions to political information**

Nathan C. Prihoda

*University of St. Thomas*

Carl W. Scott

*University of St. Thomas*

Colleen A. Brownell

*University of St. Thomas*

Patricia A. Wells

*University of St. Thomas*

#### **Board 4: Further validation of the Shame and Guilt Inventory**

Heidi L. Eyre

*Delta State University*

Heather M. Peacock

*Delta State University*

#### **Board 5: Gender and ethnicity differences in guilt and shame**

Heather M. Peacock

*Delta State University*

Heidi L. Eyre

*Delta State University*

Amanda L. Beuning

*Delta State University*

#### **Board 6: The effects of shyness on intimate partner relationships**

Billie C. Myers

*McNeese State University*

Lawrence S. Dilks

*McNeese State University*

Janice C. Marceaux

*McNeese State University*

Brooke D. Mayeaux

*McNeese State University*

#### **Board 7: The impact of emotional intelligence and stress on choice of coping strategy**

Tommie Hughes

*Texas A&M-Texarkana*

**Board 8: A replication of the internal awareness and well-being relationship**

Rick Harrington

*University of Houston-Victoria*

Donald A. Loffredo

*University of Houston-Victoria***Board 9: Correlates of college student stress, anxiety, and social support**

Melissa B. Jones

*Delta State University*

Heidi L. Eyre

*Delta State University***Board 10: Communicator style and Myers-Briggs type indicator (MBTI) extraversion-introversion**

Donald A. Loffredo

*University of Houston-Victoria***Board 11: Social inferences and internal motivation to avoid negative interpersonal biases**

Natasha K. Naylor

*Texas Tech University*

Darcy A. Reich

*Texas Tech University*

Mario P. Casa de Calvo

*Texas Tech University*

Robert D. Mather

*Texas Tech University***Board 12: When push comes to shove: Implicit self-esteem vs. collective self-esteem**

Eileen R. Rhoads

*Texas A&M-Commerce*

Raymond J. Green

*Texas A&M-Commerce***Board 13: Ei and interpersonal perception of influence: A social relations analysis**

Melissa E. Duplantis

*Sam Houston State University*

Donna M. Desforges

*Sam Houston State University***Board 14: Phenomenology of ambiguity and the use of primed information**

Jeremy A. Shelton

*Lamar University***Board 15: Hindsight bias and theory of mind tasks with children**

Meagan L. Howell

*Missouri State University*

Harry L. Hom, Jr.

*Missouri State University*

Jill E. Robertson

*Missouri State University***Board 16: Is happiness having what you want or wanting what you have?**

Amie R. McKibban

*Wichita State University***Board 17: Differences in preferred body size of people of different body sizes**

Cole R. Davis

*Southwestern Oklahoma State University*

Melinda Burgess

*Southwestern Oklahoma State University*

Stephen R. Burgess

*Southwestern Oklahoma State University*

Aashka Desai

*Southwestern Oklahoma State University*

**Board 18: Correlates of cognitive style**

Jenel N. Taylor

*University of Oklahoma at Norman*

Nicole Judice Campbell

*University of Oklahoma at Norman***Board 19: Cutoff points and counterfactual thinking**

David R. Pillow

*University of Texas at San Antonio*

Ben D. Craddock

*University of Texas at San Antonio***Board 20: Understanding the gender type perception of traditional versus progressive perceivers**

Fedora O. Galasso

*Texas A&M-Commerce*

Raymond J. Green

*Texas A&M-Commerce***Board 21: Effect of exposure to rape-related information on sexist attitudes**

Robin Dann

*Ouachita Baptist University*

Emilia S. Dewi

*Ouachita Baptist University*

David J. Rivera

*Ouachita Baptist University*

Allison Crews

*Ouachita Baptist University*

Christin D. Robinson

*Ouachita Baptist University*

Christopher R. Long

*Ouachita Baptist University***Board 22: Authoritarianism, fundamentalism, responsibility, and punishment of criminals**

Darrin L. Rogers

*University of Texas-Pan American***Board 23: Detecting lies in the workplace**

Lucas P. Hudson

*East Central Oklahoma University*

Christian L. Hart

*East Central Oklahoma University*

Derek G. Fillmore

*East Central Oklahoma University***Board 24: Piecing the puzzle together: Individual work versus group work**

Emily N. Ellwood

*St. Edwards University*

Helen D. Just

*St. Edward's University***Board 25: Effects of homelessness, gender, and family status on prosocial behavior**

Lauren Scharff

*Stephen F. Austin State University*

Jessica M. Burns

*Stephen F. Austin State University*

Cynthia L. Gamble

*Stephen F. Austin State University*

Shana M. Hatnot

*Stephen F. Austin State University*

Lindsey M. Schmidt

*Stephen F. Austin State University*

Victoria A. Netterville

*Stephen F. Austin State University***Board 26: Early wins and losses in pathological gambling**

Janice C. Marceaux

*McNeese State University*

Cam L. Melville

*McNeese State University*

Darrel B. Turner

*McNeese State University*

Brooke D. Mayeaux

*McNeese State University*

**Psi Chi Paper Session II**

9:00 a.m.- 10:15 a.m.

Creekside I

Chaired by Carl W. Scott

**Autism and executive functions: the effects of motivational/attentional accommodations**

Christine E. Chalmers

*Southwestern University*

Samantha A. Borrego

*Southwestern University*

Candace A. Stockton

*Southwestern University*

Jacqueline Muir-Broaddus

*Southwestern University***Developmental issues of respect and disrespect among elementary school students**

Mary E. Belsom

*Southeastern Louisiana University*

Brittney N. DePaula

*Southeastern Louisiana University*

Barbara J. Shwalb

*Southeastern Louisiana University***Domestic dogs and the facilitation of social interaction between humans**

Cynthia L. Smith

*Henderson State University*

Todd Wiebers

*Henderson State University***Influence of test authority on acceptance phenomenon in personality assessment**

Laura G. McCary

*Oklahoma Baptist University*

Bret M. Roark

*Oklahoma Baptist University***SWPA Paper Session: Gender, Ethnicity and Culture II**

9:00 a.m.- 10:15 a.m.

Jacob Brickler Room

Chaired by Scott A. Hutchens

**Attitudes towards gays and lesbians: Gender and sexism**

Shirley M. Ogletree

*Texas State University-San Marcos*

Ann E. Harper

*Texas State University-San Marcos***An investigation into men and women's perceptions of the pre-menstrual woman**

Coral U. Machado

*Arkansas State University*

David A. Saarnio

*Arkansas State University***Housecleaning attitudes and intimate relationships**

Shirley M. Ogletree

*Texas State University-San Marcos*

James B. Worthen

*Southeastern Louisiana University***Contraceptive knowledge in the Rio Grande Valley**

Olga L. Villanueva

*University of Texas at Brownsville*

Beth I.R. Harris

*University of Texas at Brownsville*

Matthew C. Johnson

*University of Texas at Brownsville*



**Impression formation as a function of carrying style, gender, and sexual orientation**

Scott A. Hutchens  
Amanda J. Vasilion

*Delta State University*  
*Delta State University*

**Symposium: Hurricane Rita: Personality variables and coping mechanisms**

9:30 a.m.- 10:20 a.m.

Ballrooms G&amp;H

Chaired by Jerry L. Whiteman

Jerry L. Whiteman  
Lawrence S. Dilks  
Sattaria S. Dilks  
Janice C. Marceaux  
Brooke D. Mayeaux  
Darrel B. Turner  
Rachel E. White

*McNeese State University*  
*McNeese State University*  
*McNeese State University*  
*McNeese State University*  
*McNeese State University*  
*McNeese State University*  
*McNeese State University*

**SCPA Paper Session: Animal Learning IV**

9:00 a.m.- 10:20 a.m.

William Barton Room

Chaired by Mark A. Krause

**Male bonding: Influence of male relationships in captive chimpanzee groups**

Mary C. Mareno  
Susan P. Lambeth  
Sarah F. Brosnan  
Joan S. Silk  
Steven J. Schapiro

*Southwestern University*  
*University of Texas M.D. Anderson Cancer Center*  
*Emory University*  
*University of California, Los Angeles*  
*University of Texas M.D. Anderson Cancer Center*

**Post-prandial chemosensory searching behavior in rat snakes (*Elaphe guttata emoryi*)**

Mark A. Krause

*University of Portland***The effects of perceptual learning on taste-potentiated odor aversions**

Karen Doyle  
W. Robert Batsell  
John Batson

*Kalamazoo College*  
*Kalamazoo College*  
*Furman University*

**TOPSS Symposium: Teaching research methods in the AP classroom**

9:00 a.m.- 10:30 a.m.

George Bonnell Room

Chaired by Craig Gruber

Craig Gruber

Katherine P. Minter

Marissa M. Sarabondo

*American University**Westwood High School, Austin, Texas**Lamar Academy and**McAllen Memorial H. S., McAllen, Texas.***SCPA Invited Speaker**-Chaired by Michael Domjan**Mauricio R. Papini***Texas Christian University***Role of surprising nonreward in associative learning**

Saturday, 10:30 a.m.- 11:20 a.m.

Ballroom D

Dr. Papini is interested in the modulation of behavior by affective states of anxiety and frustration. It is hoped that this research will contribute to a better understanding of the evolution of learning mechanisms, the interface between learning and emotion, and the understanding of emotional disorders. He is interested in the modulation of behavior by affective states of anxiety and frustration. Animals are tested under conditions involving surprising reward loss and their adjustment is assessed both behaviorally and physiologically. Surprising reward loss is a source of emotional modulation that may lead to behavioral facilitation, as in the frustration effect, or behavioral suppression, as in successive negative contrast. Surprising reward loss may also engage the hypothalamic-pituitary-adrenal axis. Some of the mechanisms underlying adjustment to unexpected reward loss are hypothesized to be unique to mammals. Comparative research indicates that the type of adjustment observed in relatively more conservative vertebrates is purely cognitive, lacking the emotional tone commonly observed in analogous experiments with mammals. It is hoped that this research will contribute to a better understanding of the evolution of learning mechanisms, the interface between learning and emotion, and the understanding of emotional disorders.

**PT@CC Symposium: Scholarship at the community college level**

10:30 a.m.- 11:20 a.m.

Ballroom E

Chaired by Jennifer O'Loughlin-Brooks and Valerie T. Smith

Jennifer O'Loughlin-Brooks

*Collin County Community College*

Valerie T. Smith

*Collin County Community College*

Kim Tanuvasa

*Collin County Community College*

Katrina Caudill

*Collin County Community College*

Nick Guido

*Collin County Community College*

Donnie Knight

*Collin County Community College*

**SCPA Business Meeting**

11:30 a.m.- 12:00 p.m.

Ballroom D

- Acitelli, Linda K., 25  
 Ackerman, Paul, viii  
 Adkisson, Regginald, viii  
 Ahmad, Aneeq, 4, 5, 40  
 Alberts, Jeffrey R., 9  
 Alvarez, Maria M., 32  
 Arens, Megan T., 25  
 Armstrong, Philip L., 33  
 Aronson, Elliot, 36, 40  
 Aronson, Joshua, 30  
 Arriaga-Ramirez, J. C. Pedro, 27,28  
 Ashworth, Burton J., 7, 12, 33  
 Atchison, Timothy B., 20, 32  
 Augustine, Marleah J., 16  
 Augustine, Melissa A., 27  
 Avery, Claire, 33  
 Baghurst, Timothy M., 4  
 Bailey, Scott A., vii, viii, 11, 35, 41  
 Ball, Brian S., 34  
 Ball, Steven E., 25, 34  
 Barrera, Maribel, 8  
 Bartling, Carl, viii, 38  
 Bass, Martha A., 17  
 Batsell, W. Robert, 52  
 Batson, John, 52  
 Beck, Richard A., 48,  
 Bejarano, Rafael, 28  
 Belsom, Mary E., 51  
 Benavidez, Marisol J., 32  
 Benham, Grant, 11  
 Bennett, Carol L., 32  
 Bennett, Russell L., 32  
 Bernstein, Ira H., 8, 17, 37  
 Besozzi, Megan, 25, 34  
 Beuning, Amanda L., 11, 48  
 Bienvenu, Mary B., 38  
 Biernat, Monica, 6  
 Biondillilo, Kristen, viii  
 Bishop, Cat, 14  
 Blanck, Angela L., 40  
 Borrego, Samantha A., 51  
 Boughner, Robert L., 40  
 Bourassa, Jacqueline F., 7, 12, 31  
 Bourgeois, Anthony E., 11  
 Bourgeois, Marie A., 7, 12, 33  
 Bower, Catherine A., 17  
 Bowman, Derek C., 34  
 Boyd, Stephanie L., 8  
 Bradley, Melissa L., 43  
 Breaux, Brooke O., 41  
 Breeding, Richard, viii  
 Breckenridge, Rebecca L., 28  
 Brewer, Steve T., 40  
 Brooker, Monica, viii  
 Brosnan, Sarah F., 52  
 Brouillard, Pamela, 41  
 Brown, Jay C., 25  
 Brown, Leah J., 39  
 Brownell, Colleen A., 48  
 Bruce, A. Jerry., 10, 21  
 Brunnworth, Natalie D, 28  
 Bryant, Kris K., 12  
 Bryant, Trelitha R., 31, 32  
 Budzek, Karolyn J., 16  
 Burdsal, Charles A., vii, 16, 17, 26, 38  
 Burdsal, Jeanne P., vii, viii  
 Burgess, Melinda, 10, 11, 17, 31, 39, 48  
 Burgess, Stephen R., 10, 11, 17, 31, 39, 48  
 Burns, Alicia D., 26  
 Burns, Jessica M., 50  
 Burson, Sharon, 47  
 Butler, Casey, viii  
 Busmail, Maria G., 5  
 Buss, David, 19  
 Cajas, Erika C., 37  
 Calhoun, Samantha J., 25  
 Campbell, Dawna J., 37  
 Cano, Richard B., 17  
 Canu, Will H., viii, 17  
 Cargo, Dawn R., 21  
 Carlson, Aaron Z., viii, 26  
 Carlston, David L., 4

- Carr, Rita A., 34  
 Carvalho, Catherine, 38  
 Casa de Calvo, Mario P., 49  
 Case, Kim, 16  
 Castillo, Susan F., 12  
 Castro, Veronica, 23  
 Cataldi, Amy E., 43  
 Caver, Kelly A., 10  
 Chalmers, Christine E., 51  
 Chang, Kyle, E., 5  
 Chang, Sau Hou, 4  
 Chaparro, Barbara, viii  
 Chiasson, Henry J., 28  
 Christensen, Chrisanne M., viii, 34  
 Chung, Amy, 12, 31  
 Cline, Robbie, viii  
 Clopton, James R., 7  
 Cohn, Jenifer L., 22  
 Cole, Tara M., 32, 34  
 Collier, William G., 39  
 Colvey, Debra J., 14  
 Cook, Jennifer L., 5  
 Cooley, David T., 42  
 Cottingham, B. Jean, 38  
 Courtney, Jon R., 21  
 Covington, Christopher C., 34  
 Cox, Jared S., 38  
 Coyle, Thomas R., 20  
 Craddock, Ben D., 50  
 Crews, Allison, 50  
 Croyle, Kristin, L., viii, 37  
 Cruz-Morales, Sara E., 27  
 Cuevas, Mary Jane, 12  
 Cusato, Brian, 14  
 Cusato, Melissa Burns, 14  
 Czuchry, Michael L., 10, 21  
 Daniel, Alan M., 35  
 Dann, Robin, 50  
 Datteri, Darcee L., vii, 15  
 Daughtry, Donald W., 9, 11  
 Davis, Clarence, 3  
 Davis, Cole R., 10, 11, 17, 31, 38, 49  
 Davis, John M., viii, 3, 17  
 Davis, Megan E., 3  
 Davis, Stephen F., 39  
 Decker, Jennifer R., 7  
 DeFilippo, Jessica L., 8, 37  
 DeLeon, Naomi, 37  
 De Los Santos, Josephine, 23, 26, 47  
 Demarest, Kristina G., 5  
 Dennis L. Jackson, 5, 15, 23  
 DePaola, Steve J., viii, 33  
 DePaula, Brittney N., 51  
 Desai, Aashka, 49  
 Desforges, Donna M., 49  
 Dewi, Emilia S., 50  
 Diehl, Abby N., 22  
 Dilks, Sattaria S., 52  
 Dilks, Lawrence S., viii, 7, 8, 12, 33, 48, 52  
 Doan, Virginia M., 43  
 Domjan, Michael, 14, 53  
 Donohue, Darius D., 27  
 Donovan, Kathleen M., 41  
 Doyle, Karen, 52  
 Drake, Ryan A., 31  
 Dudley, George, 31, 32  
 Dunne, Brendan, 42  
 Duplantis, Melissa E., 49  
 Dusek, Brittany R., 37  
 Edgington, Chuck, 33  
 Edwards, Arielle, 33  
 Ellison, Brent, vii, viii  
 Ellwood, Emily N., 50  
 Emerson, Kaleigh R., 11  
 Erwin-Hartley, Mary A., 8  
 Exner, Amanda L., 3  
 Eyre, Heidi L., viii, 11, 48, 49  
 Ezell, Sherri C., 48  
 Faust, Douglas S., viii  
 Ferguson, Ryan W., 21  
 Fielding, Cheryl W., 47  
 Fillmore, Derek G., 50

- Flannagan, Dorothy A., viii, 42  
 Fleck, Dorothy T., 4  
 Fleck, J. Roland, 4  
 Fleming, Amanda M., 4  
 Flores, Laura, 38  
 Foley, Brittany L., 43  
 Foltz, Alan D., 28  
 Frahm, Krystle A., 17  
 Francis, Nedra H., 4  
 Franks, Susan, 11  
 Froese, Arnold D., viii, 5, 41  
 Frohardt, Russell J., 22, 41  
 Frost, Ashley N., 40  
 Frost, Christopher, 31  
 Fuchs, Perry N., 28  
 Gadzella, Bernadette M., 15, 38  
 Galasso, Fedora O., 50  
 Gamble, Cynthia L., 51  
 Gann, Leslie K., 21  
 Garcia-Lopez, Stella D., viii, 38  
 Garrison, Stephanie D., 40  
 Gean, Emily G., 14  
 Gearson, Sean M., 16  
 Gensic, Alison, 3  
 Gesn, Paul R., 32  
 Gill, Emily L., 42  
 Gillaspay, James A., viii, 4, 17, 26, 27, 43  
 Gillaspay, Stephen R., 4  
 Gilmore, Candace, 17  
 Ginsburg, Harvey J., 32  
 Glass, Sarah C., 21  
 Gleason, Stephanie, 14  
 Gomillion, Sarah C., 48  
 Gonzales, Angela C., 11  
 Goodson, Shannon L., 31, 32  
 Graham, Loranel M., 21  
 Green, Raymond J., 4, 20, 49, 50  
 Grover, Cathy A., viii, 27  
 Gruber, Craig W., 53  
 Guarraci, Fay A., 22, 23  
 Gulley, Bethany, 3  
 Haemmerlie, Frances M., viii  
 Halcomb, Charles G., 27  
 Hall, Brooke E., 8  
 Hall, John P., viii, 39  
 Hall, Sharon K., viii, 5  
 Haney, Elizabeth A., 25  
 Hargrave, Stephanie J., 27  
 Harkabus, Lindsey C., 3  
 Harman, Marsha J., 10, 21  
 Harper, Ann E., 51  
 Harrington, Rick, 49  
 Harris, Beth I.R., 51  
 Harris, Richard, J., viii  
 Harris, Shanas, 15  
 Harrison, Paul D., 38  
 Hart, Christian L., viii, 8, 50  
 Hartlaub, Mark G., 39, 41  
 Hatchett, Heather, 16  
 Hatnot, Shana M., 50  
 Hayes, Kaira M., 15, 16  
 Heard, Courtney C., 41  
 Hendrix, Jennifer, viii  
 Hendrix, Toby J., 28  
 Henley, Tracy B., 4, 14, 34  
 Hensby, Christian P., 21  
 Henseler, Sarah E., 16, 37  
 Hernandez, Bernardino, 20  
 Hernandez, Marco L., 37  
 Herrera-Conaway, Ruth Marisa, 41  
 Hicks, Jennifer, L., viii  
 Higa-King, Jennifer J., 27  
 Higginbotham, David R., 32  
 Hilborn, Scott, 11  
 Hill, Candi L., 48  
 Hines, Debra J., 22, 41  
 Hinkle, Veronica D., 38  
 Hixson, Sheila B., 7, 33  
 Hodges, Cynthia A., 33  
 Hoelscher, Virginia C., 39  
 Holder, Ronald R., 42  
 Holmes, Cooper B., 16

- Hom, Jr., Harry L., 49  
 Horn, Sarah, viii  
 Howard, Jeffrey, viii  
 Howard, Laura A., 16  
 Howard, Waylon J., 27  
 Howell, Meagan L., 49  
 Hubbard, Timothy L., 11, 20, 21, 29  
 Hudson, Lucas P., 50  
 Hughes, Leighann B., 40  
 Hughes, Mercathea J., 7  
 Hughes, Tommie, 48  
 Humphreys, Joy D., 7  
 Hurst, Shannon, 33  
 Hutchens, Scott A., 14, 16, 20, 21, 51, 52  
 Hutchison, Joanna L., 11  
 Hynan, Linda S., 17, 22  
 Isaak, Matthew I., viii, 32  
 Issen, Laurel A., 26  
 Jackson, Benetha G., viii, 7  
 Jackson, Dennis L., 5, 15, 23  
 Jackson, Glenda C., 27  
 Jackson, Valerie D., 20  
 Jasbring, Lindsey M., 26  
 Johnson, Miles, 17, 31, 38  
 Johnson, Emily L., 42  
 Johnson, Matthew C., vii, viii, 10, 25, 51  
 Johnson, Robert D., viii, 14  
 Johnson, Theodore D., 42, 43  
 Jones, Kelanie, 17, 31, 38  
 Jones, Melissa B., 49  
 Jordan, Amy B., 42  
 Joyce, Elizabeth L., 22, 23  
 Juarez-Maldonado, Claudia E., 27  
 Judice Campbell, Nicole, 16, 50  
 Junco, Kacee A., 34  
 Just, Helen D., 16, 41, 50  
 Kaderka, Amy, 3  
 Kahn, Amber, 3  
 Kao, Yung-Fei K., 21  
 Kardas, Edward P., vii, viii, 26, 44  
 Richard A., vii, 13, 35, 40, 45  
 Kauffman, Erin E., 31  
 Keathley, Rosanne S., 17  
 Kee, Jeffery Alan., 7  
 Kelley, Erin E., 15  
 Kelly, Ryan C., 10, 21  
 Kelly, William E., 9, 11  
 Kesterson, Janine S., 25  
 Khramtsova, Irina I., 16  
 Kirk, Edythe E., viii, 11, 37, 42  
 Kirk, Roger E., 15  
 Kranz, Peter L., 8  
 Krause, Mark A., 52  
 Kubiszyn, Thomas, x, 18  
 Kurian, Sherine E., 12, 31  
 LaBauve, Bill J., 7  
 Lamas, Maria S., 12  
 Lambdin, Candace N., 27  
 Lambdin, Charles G., 5  
 Lambeth, Susan P., 52  
 Lammers, Bill J., viii, 15  
 Lapiere, Coady B., 7  
 LaPota, Holly B., 11  
 Lawrence, Sara C., viii  
 Leftwich, Michael J., 11  
 Lenz, Alan S., 20, 38  
 LeUnes, Arnold D., 11  
 Lewis, Elissa L., 8, 37, 43  
 Lockhart, Lisa K., viii  
 Loffredo, Donald A., 49  
 Logan, Page, 21  
 Long, Christopher R., 50  
 Lopez, Jose J., 23  
 Lovell, Jennifer L., 23  
 Low, Jean M., 7, 38  
 Lucas, Don, 42  
 Lukenbill, James F., 8  
 Luster, Shelly R., 34  
 Machado, Coral U., 16, 51  
 Marceaux, Janice C., 7, 8, 12, 33, 48, 50, 52  
 Mareno, Mary C., 52  
 Marrs, Heath, 15, 16

- Martin, James, H., 42  
 Martinez, Amanda, 20  
 Marzioli, Amber G., 43  
 Mascorro, Brenda I., 10  
 Masten, William G., 15, 38  
 Mathie, Virginia Andreoli, 35  
 Mather, Robert D., 49  
 Matthews, Janet R., viii  
 Matzenbacher, Dena L., 33  
 Mayeaux, Brooke D., 7, 12, 33, 48, 50, 52  
 McCain, John R., 16  
 McCall, Deborah, vii  
 McCarter, Shalisa, 17, 31, 38  
 McCary, Laura G., 51  
 McConnell, Bridget L., 20  
 McConnell, Carlee M., 43  
 McCracken, Lindsay M., 5  
 McCracken, Mandy L., 5  
 McCubbin, James A., 20  
 McGahan, Joseph R., 48  
 McGlamery, Mary E., 34  
 McGregor, Loretta N., vii, 23, 41  
 McGregor, Porsha, vii  
 McGregor, Sean, vii  
 McKenna, Ralph J., 17  
 McKibban, Amie R., viii, 49  
 McNaughton-Cassill, Mary Ellen, 5, 12, 37  
 McNeese, Bethany L., 16  
 Meier, Jo A., 5  
 Mellgren, Roger L., 28  
 Melville, Cam L., 7, 50  
 Merritt, Paul S., viii, 20  
 Meyer, Mackenzie K., 42  
 Milbury, Kathrin, 25  
 Miller, Aletha R., 33  
 Miller, Arden T., 28  
 Miller, Whitney J., 28  
 Minter, Katherine, 53  
 Montgomery, Robert L., 29  
 Montoya, Jared A., 41  
 Morrow, Mark M., 26  
 Mosack, Victoria, 16  
 Muglia, Carlina N., 14  
 Muir-Broaddus, Jacqueline, 51  
 Murphree, Patricia D., 21  
 Murphy, Michael D., viii, 28, 29  
 Myers, Billie C., 48  
 Nail, Paul R., vii, 1, 4, 6, 9, 19, 23, 26, 29, 30, 36, 44, 45  
 Naylor, Natasha K., 49  
 Neighbors, Bryan D., 8, 37, 42  
 Nelson, Michael D., 12, 32  
 Nesenholtz, Dinah E., 41  
 Netterville, Victoria A., 50  
 Newby, Robert W., viii  
 Newcomb, Tamara C., 33  
 Newsom, Jesse, 14  
 Nichols, Andrew W., 42  
 Nixon, Casey B., 31, 32  
 Noland, Ramona M., 15, 17  
 Norfolk, Philip A., 12  
 Norris, Jacob N., 35  
 Norsworthy, Larry A., 3, 7, 8, 31, 34  
 Ogletree, Shirley M., 31, 42, 51  
 Oldenkamp, Jeffrey L., 4, 31  
 O'Loughlin-Brooks, Jennifer, 10, 47, 54  
 Olson, Laura M., 4  
 Ortega-Saavedra, M. Guadalupe, 27, 28  
 Osbaldiston, Richard, 5, 26  
 Overton, Terry P., 47  
 Page, Billy T., 27  
 Palmer, Christine A., 26  
 Palmer, Tasha N., 16  
 Papini, Mauricio R., 35, 53  
 Park, Anna E., 14  
 Parkerson, Annette H., 28  
 Peacock, Heather M., 11, 48  
 Pearce, Amy R., viii, 27, 42  
 Perkins, Scott., 3  
 Peters, Anne E., 35  
 Peterson, Molly K., 42  
 Phillips, Marissa D., 33



- Pierce, Latoya, viii  
 Pilcher, June J., 20  
 Pillow, David R., 7, 50  
 Pinnell, Mary E., 42  
 Pollock, Skip, vii  
 Poole, Ophelia O., 37  
 Porac, Clare, 23  
 Porter, Mary L., 14  
 Potts, Christina N., 3, 43  
 Powell, Jacqueline G., 10, 21  
 Priest, Jonathan W., 26  
 Prihoda, Nathan C., 48  
 Purc-Stephenson, Rebecca J., 5, 15  
 Purdy, Jesse E., 35, 39  
 Radford, Sunshine D., 33  
 Rafferty, James M., 32  
 Ramirez, Sylvia Z., 8  
 Ramsey, Alexandra N., 42  
 Randell, Joe A., 8  
 Randolph-Seng, Brandon, 25  
 Reed, Kristin L., 11  
 Reese, Jeff, 3, 15, 31  
 Reich, Darcy A., 49  
 Reuther, Daniel W., 43  
 Rhoads, Eileen R., 49  
 Rhoads, Paul A., 43  
 Rhodes, Heidi M., 34  
 Rice, Gary C., 43  
 Richards, Casey S., 37  
 Riedlinger, Elizabeth M., 35  
 Rivera, David J., 50  
 Roark, Bret M., 25, 51  
 Robertson, Jill E., 49  
 Robertson, Michaela T., 7  
 Robinson, Christin D., 50  
 Robinson, Melinda K., 48  
 Rodinsky, Harold, viii  
 Rogers, Darrin L., viii, 50  
 Roland, Rachel R., 16  
 Rossmiller, Sarah L., 43  
 Rowlands, Steve, 3  
 Rugh, Rebecca A., 15  
 Ryan, Michael J., 39  
 Saarnio, David A., viii, 14, 28, 51  
 Sandler, Irwin, 22  
 Sarabando, Marissa M., 53  
 Savoy, Kyra E., 12  
 Sawyer, Grant, 27  
 Schamel, Molly, 37  
 Schapiro, Steven J., viii, 52  
 Scharff, Lauren, viii, 4, 25, 31, 50  
 Schmidt, Lindsey M., 50  
 Schriewer, Ashley E., 11  
 Scott, Alisa A., 11  
 Scott, Carl W., viii, 12, 20, 48, 51  
 Scott, Heather M., 11  
 Seidel, Steven D., 38  
 Serova, Svetlana A., 28  
 Serratos, Kent, 37  
 Seys, Cedric, 12  
 Shelton, Jeremy A., 49  
 Shoaf, Caleb, 10, 11  
 Shoptaugh, Carol F., 28  
 Short, Anna E., 28  
 Short, Erin L., 3, 25  
 Shortnacy, Melissa D., 16  
 Shwalb, Barbara J., 51  
 Sia, Tiffany L., 10  
 Sierra, Claudia M., 10  
 Silk, Joan S., 52  
 Singg, Sangeeta, viii, 16  
 Singleton, Amie L.C., 34  
 Smith, Cynthia L., 49  
 Smith, Jamie M., 8  
 Smith, Raegan B., 33  
 Smith, Theodore S., 4, 15  
 Smith, Valerie T., 10, 54  
 Smith, Veronica A., 34  
 Snook, Joy-Del T., 39  
 Stacks, James R., 32  
 Stermer, Paul, 10, 17, 31, 38  
 Stockton, Candace A., 51

- Stote, Deborah L., 5, 40  
Stringfellow, Ronald L., 12  
Sullivan, Maureen A., 33  
Taylor, Emily G., 26  
Taylor, Jenel N., 50  
Taylor, Ronald, D., viii  
Taylor, Wyn E., 32  
Tietz, Julie A., viii  
Tokuda, Satoru., 27  
Treadway, Kathleen A., 21  
Turner, Darrel B., 8, 50, 52  
Urbano, Catherine M., 10, 21  
Valadez, Charles D., 42  
Van Leeuwen, Marilyn D., viii  
Vandehey, Michael A., 31  
Vasilion, Amanda J., 52  
Villanueva, Olga L., 51  
Voiles, Jennifer M., 3  
Waldschmidt, Jennifer G., 8  
Walker, Bonnie J., viii  
Walker-Montoya, Gina G., 17  
Watson, Mallory L., 20  
Weaver, Kenneth A., viii, 16, 41  
Weaver, Rebecca R., 5, 28  
Webb, Ashley R., 11  
Weed, Jessie L., 32  
Weissenburger, David, viii  
Wells, Patricia A., 48  
Wharton, Virginia M., 7  
Wherry, Jeffrey N., 34  
White, Rachel E., 52  
Whiteman, Jerry L., 52  
Wickham, Robert E., 10  
Wiebers, Todd, 25, 51  
Wilkerson, Keith A., 48  
Williams, Jaymi, 33  
Williams, Joni D., 32, 34  
Williams, Katie, viii  
Williams, Kelly M., 43  
Williamson, W. Paul, 28  
Wilson, Deborah J., 34  
Wolfe, Lesley A., 12  
Woo, Wai (Ada) N., 37  
Wood, Michael David., 35  
Wood, Kristin C., 26  
Wood, Kristin R. , 41  
Wood, Virginia V., viii  
Worthen, James B., 51  
Wozencraft, Theresa, vii, 41  
Wright, Genevieve E., 42  
Yakunina, Elena Sergeeva , 26  
Yates, Christine L., 3, 27  
York, Stephanie M., 7  
Yudovich, Alex, 3

Welcome to the Southwestern Psychological Association 52nd Annual Convention

Visit the  
**American Psychological Association**  
Membership Booth

in the Capitol View Terrace Room at the Marriott Austin at the Capitol



- Join APA today and receive a **FREE** gift
- Pick up the latest issue of *Monitor on Psychology* and *gradPSYCH* magazines
- Get information on APA books and journals, your personal benefits program and more
- Order your official APA Membership Certificate and Plaque



# 2007 SWPA Convention

Renaissance Worthington Hotel

Fort Worth, TX

April 5 - 7, 2008