

The Fifty-Sixth Meeting of the Southwestern Psychological Association

President
Scott Bailey
Texas Lutheran University

Past President
Lauren Scharff
US Air Force Academy

President-Elect
Arnold Froese
Sterling College

Executive Council Members

Arizona
Meliksah Demir
Northern Arizona
University

Arkansas
Ruth Provost
Williams Baptist College

Kansas
Cathy Grover
Emporia State University

Louisiana
Larry Dilks
Counseling Services of
Southwestern Louisiana

Missouri
Frances (Dee) Montgomery
Missouri University of Science & Technology

Oklahoma
Shelia Kennison
Oklahoma State University

Tennessee
Clark McKinney
Southwest Tennessee
Community College

Texas
Christian Hart
Texas Women's University

Undergraduate
Representative
Kevin Windecker
Texas Lutheran University

Secretary-Treasurer
Sharon Roberts
Northeastern State University

Graduate
Representative
Benjamin England
Texas Tech University

Association and Convention Support Staff

Convention Manager
Sherry Reisman
Partner: Reisman-White

Program Chair
Jeanne Burdsal
Wichita State University

Webmaster
Michael Coon
MC2 Studios

Election Commissioner
Charles Burdsal
Wichita State University

Presidents of the Southwestern Psychological Association

Gardner Murphy, PhD, 1954
Aaron Q Sartain, PhD, 1956
Gordon V Anderson, PhD, 1957
Robert R Blake, PhD, 1958
Wayne H Holtzman, PhD, 1959
Ruth M Hubbard, PhD, 1960
Fillmore Sanford, PhD, 1961
John P Anderson, PhD, 1962
Saul B Sells, PhD, 1963
Irwin A Berg, PhD, 1964
Ira Iscoe, PhD, 1965
Benjamin Fruchter, PhD, 1966
Malcolm D Arnoult, PhD, 1967
Jackson B Reid, PhD, 1968
Daniel E Sheer, PhD, 1969
Oscar A Parsons, PhD, 1970
Janet T Spence, PhD, 1971
James Leslie McCary, PhD, 1972
Frank A Logan, PhD, 1973
Vladimir Pishkin, PhD, 1974
Logan Wright, PhD, 1975
Harry J Parker, PhD, 1976
C Eugene Walker, PhD, 1977
Henry C Ellis, PhD, 1978
Alvin G Burstein, PhD, 1979
H Wayne Ludvigson, PhD, 1980
June Gallessich, PhD, 1981
Roger L Mellgren, PhD, 1982
Toni Falbo, PhD, 1983
Larry Christenson, PhD, 1984
Douglas P Ferraro, PhD, 1985
Warren H Jones, PhD, 1986
Janet R Matthews, PhD, 1987
Stephen F Davis, PhD, 1988
Clyde Hendrick, PhD, 1989
Francis T Durson, PhD, 1990
Randolph A Smith, PhD, 1991
Robert L Montgomery, PhD, 1992
Gordon K Hodge, PhD, 1993
Dennis C Cogan, PhD, 1994
Michael R Best, PhD, 1995
Roger E Kirk, PhD, 1996
Robert T Hogan, PhD, 1997
Vicki Green, PhD, 1998
Jesse E Purdy, PhD, 1999
Theresa A Wozencraft, PhD, 2000
Randall Wight, PhD, 2001
John M Davis, PhD, 2002
Mary Brazier, PhD, 2003
Kenneth M Weaver, PhD, 2004
Edward P Kardas, PhD, 2005,
Paul R Nail, PhD, 2006
Charles A Burdsal, PhD, 2007
Linda S Hynan, PhD, 2008
Lauren Scharff, PhD, 2009
Scott A Bailey, PhD, 2010

From the President

Scott A. Bailey

Texas Lutheran University

Greetings and welcome to the 56th annual convention of the Southwestern Psychological Association. It has been an honor and pleasure to participate in the planning of this event. The growth and momentum of SWPA are most encouraging.

Our program is rich with interesting invited addresses, papers, posters, symposia, presentations on effective teaching, and continuing education workshops. To be sure, the breadth and depth of the program is crucially linked to the participation of our affiliate organizations: SCPA, SAMR, Psi Chi, and TPA. I hope that your experience here leaves you with expanded understandings of basic and applied human and nonhuman behavior.

For two years, members of SWPA have produced a quarterly electronic newsletter. The goal for the newsletter is to highlight the interesting work people are doing in the region. Please help us remain aware of the host of things that you are doing. If you or someone you know has a program of research, a project of particular interest, or anything that you think merits inclusion in the newsletter, please submit a description of it so that we may work it into the queue.

The annual conference is the focal event for our organization. The newsletter and webpage (www.swpsych.org) are great tools for disseminating information relevant to psychologists and students of psychology. Shortly after the conference has ended an electronic survey will be sent to every registrant; please take a few moments when you get it to help ensure that your interests are appropriately represented in the 2011 San Antonio conference program, and in our newsletter and webpage.

Enjoy the convention!

2010 Program Reviewers

Thank you to our members who served as reviewers!

Edward T Asbury	Christian L. Hart	Victoria Mosack
Carl Bartling	Linda S Hynan	Crystal D Oberle
Alexander Beaujean	Matthew C. Johnson	Shirley M. Ogletree
Elson M. Bihm	Beth A. Jones	Randall E. Osborne
Stefanie Boswell	D Gabrielle Jones-Wiley	Yaron Rabinowitz
Robert L Boughner	Edward P. Kardas	Neena Rao
Walter Buboltz	Shelia M Kennison	Lana S Rhoads
Jeanne P. Burdsal	Marcel Satsky Kerr	Steven Roring
Jennifer Byrd-Craven	Peter L Kranz	Kevin Rowell
David L Carlston	Lacy Elise Krueger	Kimberly Rynearson
Alice P Carter	Caleb W Lack	Todd Ryska
Shawn R Charlton	Bill J. Lammers	Lauren Scharff
Julie Dorton Clark	David M. Lawson	Carl W. Scott
Jennifer G. Clement	Veronica E. Lewis	Michael J. Serra
Dennis R. Combs	Lisa K. Lockhart	Glenn D. Shean
Lisa Comparini	Don Lucas	Ken Sobel
Renee A Countryman	Pamelyn M MacDonald	Laura C Spiller
Mary Lynn Crow	William G Masten	Andrew M Terranova
Meliksah Demir	Dena L Matzenbacher	Paula J Varnado-Sullivan
Paula A Desmond	Brenda Lee McDaniel	Jeannetta Williams
Amy K Dicke-Bohmann	Valerie McGaha-Garnett	Deborah Jewel Wilson
George M. Diekhoff	Meredith L. McKee	Victoria Zascavage
Lawrence S Dilks	Mary Ellen McNaughton-Cassill	Leslie Wade Zorwick
Arnold D Froese	Jo A. Mitchell	Evan L Zucker
Gilbert J. Garza	Frances Haemmerlie Montgomery	
John P. Hall	Jared A. Montoya	

Acknowledgement of Financial Support to SWPA

SWPA—Southwestern Psychological Association gratefully acknowledges financial support provided during the 2009-2010 calendar year. The organization received support for its Annual Fund and for the Endowed Fund.

Annual Fund Donors

- Mr. and Mrs. Perry R. Dickinson
- Robinswood School, Lake Charles, LA
- CPCL Professional Training Resources, Inc., Pineville, LA
- Louisiana Community Care, Ball, LA
- Glenn M. Hebert, Inc.

Endowed Fund Sponsors—Designated for a forensic psychology lecture series*

- Todd and Rex Townsley
- Raleigh Newman, A Professional Law Corporation
- Cox, Cox, Filo, Camel & Wilson, LLC, Attorneys
- Norman Thigpen, Attorney
- Larry A. Roach, Inc., A Professional Law Corporation
- Terrell Fowler
- Lawrence Dilks

*SWPA—Southwestern Psychological Association will inaugurate the forensic psychology lecture series at its 2011 meeting in San Antonio.

State Representative Invited Speaker Symposia

In 2009, SWPA instituted a special set of symposia coordinated by our elected state representatives during the second year of their two-year terms. The state representatives organize their symposia by inviting faculty and other esteemed professionals from around the region and the nation. The state symposia in the 2010 program were organized by the representatives from Missouri and Louisiana. The intent of these symposia is to further enhance the level of research presented at our annual convention.

Acknowledgements

We also gratefully acknowledge the generosity of the Boards of Scientific Affairs and Education of the American Psychological Association for their contributions toward the SWPA Social event and underwriting of the Harry Kirke Wolfe Lecture.

Audio-Visual Policy

SWPA will provide computer, projector, and screen for the Invited speakers presenting in Ballroom E. SWPA will provide a screen and electrical power cords in all other meeting rooms where members present papers, workshops, or symposia. If members need any other audio-visual equipment, they are responsible for making their own arrangements and payment.

The security and storage of any equipment brought to the meeting site is the sole responsibility of the individual bringing or renting the equipment for the meeting. SWPA is not responsible for the security and storage of equipment brought to the meeting site by private arrangement.

SWPA Social Topic Table Facilitators

Many thanks to the following individuals who have agreed to serve as facilitators at topic tables at our SWPA Social on Thursday, April 8th.

Dr. Richard Beck Psychology of Religion	Abilene Christian University
Dr. Melissa Burns-Cusato & Dr. Brian Cusato Comparative Psychology	Centre College
Dr. Meliska Demir Happiness/Social Psychology	Northern Arizona University
Dr. Jenelle Fitch Counseling	Texas Woman's University
Dr. Carolyn Turner Working with Sex Offenders	Texas Lutheran University
Dr. David Thomas Infant Cognition	Oklahoma State University
Dr. Adena Young Education Psychology	Missouri State University
Dustin Elliott, Jill Peters, Sabrina Higgins, Megan Koranda, and Chris Rea Being a GTA: Hints for First Time Teaching	Emporia State University

Marriott Dallas/Addison Quorum Hotel Meeting Facilities

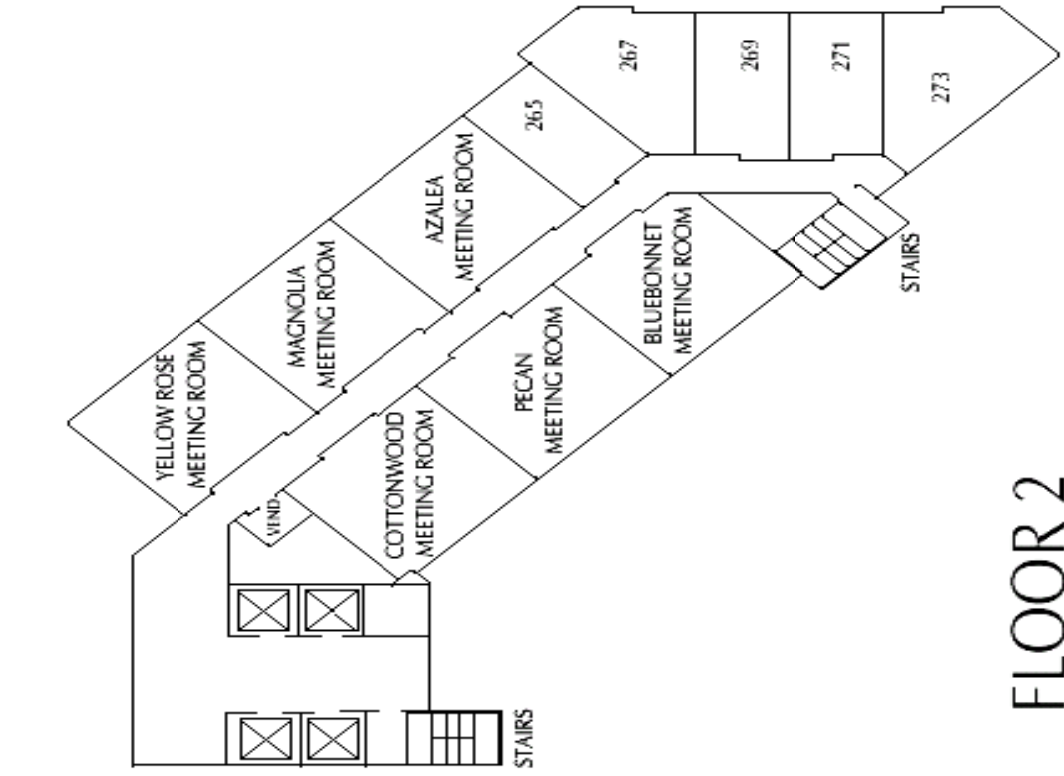

FLOOR 2

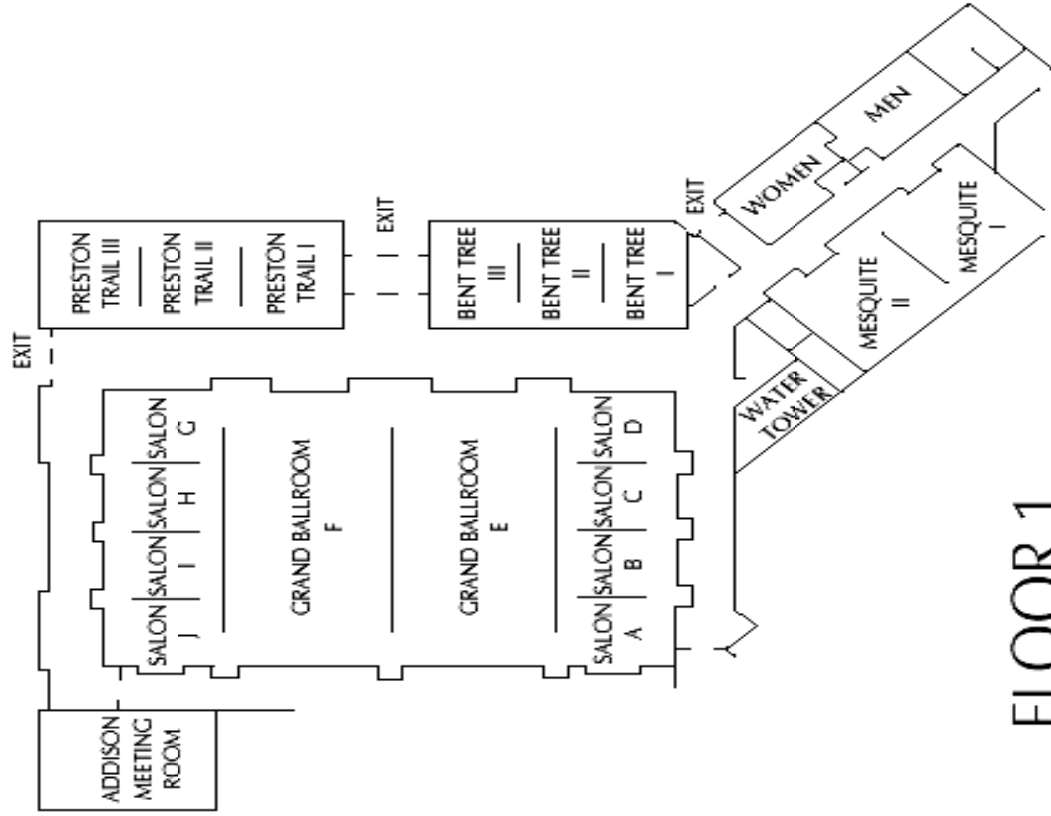

FLOOR 1

SWPA 2010 Conference Exhibitors

Exhibitors' booths are located in either Salons A-D where the poster sessions are held or in the hallway immediately outside the poster area.

Wiley

Since 1807, Wiley has been a leading publisher of print and electronic products. Stop by our booth to preview our 2010 psychology higher education offerings.

Walden University

Walden University celebrates 40 years of serving the higher education needs of professionals through degrees that encourage positive social change. Offered online, areas of study range from health and education to management and public administration

Pearson

Pearson is the foremost provider of assessments for psychology professionals. Our reliable, well-validated tools assess ability/intelligence, behavior, personality, memory, neurological concerns, psychosocial and other issues.

McNeese State University

The McNeese Psychology Department is located in Lake Charles, LA and offers an MA degree with concentrations in counseling, general-experimental, ABA, and addictions treatment.

Angelo State University

Dr. Sangeeta Singg will provide information, brochures, applications, and goodies about the program and Angelo State University.

Southeastern Louisiana University

Southeastern Louisiana University Psychology Masters Program

Council on Undergraduate Research

This booth will share information on the Council on Undergraduate Research, whose mission is to support and promote high quality undergraduate student-faculty collaborative research and scholarship.

Missouri Western State University

Stephen F Austin State University

The SFASU Department of Psychology Master's Degree program – information regarding program and assistantships available

Oklahoma State University

Tarleton State University

Tarleton State University offers graduate programs in Stephenville, Fort Worth, Waco and Online.

American Psychological Association

**Southwestern Psychological Association
2010 Annual Convention
April 8 – 10, 2010
Marriott Dallas/Addison Quorum – Dallas, Texas**

Thursday – April 8, 2010

Psi Chi: Preparing for Your Future: Observational Learning of Professional Skills

Thursday, 8:00 AM - 9:00 AM

Session: [1]

Chaired by: Evan Zucker

Room: Mesquite 2

**SWPA /TPA Poster Session 1: Cognition/Memory, Neuropsychology, Sensation,
Stress, Sports, Animal/Com**

Thursday, 8:30 AM - 10:00 AM

Session: [2]

Room: Salons A-D

1. Differences in Memory Impairment in Patients of TBI and Chemical Exposure

Ashley N Carroll

Louisiana Tech University

Lawrence S Dilks

Counseling Services of Southwest Louisiana

Andrew Justin Thrasher

Fielding Graduate University

Salvatore Paul Carbonaro, Jr.

Fielding Graduate University

Janice C. Marceaux

Shelley Blancett

Fielding Graduate University

2. Effects of Media on Mood: A Preliminary Investigation

Ravin McCallum

Texas Lutheran University

Jennifer Martinez

Texas Lutheran University

Ruby Leah Guerra

Texas Lutheran University

James Keith Benzschawel

Texas Lutheran University

Michael L. Czuchry

Texas Lutheran University

3. FACES (4.0) are Processed Differently than Real Faces

Curt A. Carlson

Texas A & M University - Commerce

4. Neural Mediators of Working Memory in Autism Spectrum Disorders

M. Amanda Earl Colby

University of Texas - Dallas

Michael Allen Motes

University of Texas - Dallas

Bart Rypma

University of Texas - Dallas

5. The Immediate Effects of Music on Mood & Emotion

Paul Kazyak

University of Dallas

6. Using COGNISTAT to Predict Dementia

LaShondra Simone Collins

University of Central Arkansas

Danielle Smith

University of Central Arkansas

Kevin Rowell

University of Central Arkansas

7. Cognition and Personality in Binary Choice Tasks

Drew Guillaume Stephenson *Oklahoma State University*
Devan Ramirez *Oklahoma State University*
James W. Grice *Oklahoma State University*

8. Does Media Effect Mood? The Influence of Movies on Demeanor

Catherine Ruth Hoffmann *Texas Lutheran University*
Bryan Lowery *Texas Lutheran University*
Janeé Jackson *Texas Lutheran University*
Michael L. Czuchry *Texas Lutheran University*
Josh Haby *Texas Lutheran University*

9. Examining the Link between Memory and Understanding in Multimedia Learning

Michael J. Serra *Texas Tech University*
Jennifer Scardino *Texas Tech University*
Kyla Ellis *Texas Tech University*

10. Hindsight Bias: "That Blurry Face is Smiling at Me!"

Elizabeth Wilcox *Missouri State University*
Kathrene Valentine *Missouri State University*
Harry L. Hom, Jr. *Missouri State University*

11. Risk In Simulated Environments: The Role of Working Memory Capacity

Terry Glen Rawlinson *Texas A & M University - Commerce*
Shulan Lu *Texas A & M University -Commerce*
Tracy B Henley *Texas A & M University - Commerce*

12. Framing the Health Care Debate: Issues in News Coverage

Carl W. Scott *University of Saint Thomas*
Jesus Bautista *University of Saint Thomas*
Adrian Campos Garcia *University of Saint Thomas*

13. Cognitive Impairment Secondary to Electrocution: A Neuropsychological Case Study

Shelley Blancett *Fielding Graduate University*
Lawrence S Dilks *Counseling Services of Southwest Louisiana*
Ashley N Carroll *Louisiana Tech University*
Andrew Justin Thrasher *Fielding Graduate University*
Janice C. Marceaux
Salvatore Paul Carbonaro, Jr. *Fielding Graduate University*

14. Impact of Depressive Symptom Clusters on Cognition in a Multi-Ethnic Cohort

Melissa L. Edwards *Texas Tech University*
Valerie Hobson *Texas Tech University Health Sciences Center*
Leigh Johnson *Texas Tech University Health Sciences Center*
Sid E O'Bryant *Texas Tech University Health Sciences Center*

15. Cognitive Abilities Impact Emotional Control in Children with High-Functioning Autism

Ashlee Ruth Loughan	<i>Walden University</i>
Lauren Serpati	<i>George Mason University</i>
Dorothy Zhang	<i>Northeastern State University</i>
Joshua Roberts	<i>Northeastern State University</i>
Layne Kalbfleisch	<i>George Mason University</i>

16. Depression Sub-Factors and How They Affect Cognitive Decline in an MDC Population

Lauren Nicole Wyshywaniuk	<i>Texas Tech University Health Sciences Center</i>
Kruti Anil Bhakta	<i>Texas Tech University Health Sciences Center</i>
Crystal Strange	<i>Texas Tech University Health Sciences Center</i>
Valerie Hobson	<i>Texas Tech University Health Sciences Center</i>
Sid E O'Bryant	<i>Texas Tech University Health Sciences Center</i>

17. Understanding Parent-Teacher Disagreement on Ratings of Children's Executive Functioning

Cheryl H Silver	<i>University of Texas Southwestern</i>
Carmen Jimenez	<i>University of Texas Southwestern</i>
Lauren Smith	<i>University of Texas Southwestern</i>

18. Presentation Styles and Their Effects on Participants' Responses

Kristine Weir	<i>Texas Woman's University</i>
Alex Weir	<i>Texas Woman's University</i>

19. Examining the Relationship between Perceived Emotional Intelligence and Trait Worry

Paula A Desmond	<i>Southwestern University</i>
Meagan J Anderson	<i>Southwestern University</i>
Caitlyn L Carnes	<i>Southwestern University</i>

20. Tangible Social Support Moderates the Relationship between Academic Stress and Resilience

Jessica Grimm	<i>University of Texas - Arlington</i>
Angela Liegey Dougall	<i>University of Texas - Arlington</i>

21. Calling All Eeyores: The Relationship Between Relaxation and Optimism.

Samuel Warfield Cornish	<i>St. Edward's University</i>
Helen D. Just	<i>St. Edward's University</i>

22. Symptomatology of Children Exposed to Domestic Violence

Lauren L Gilland	<i>Texas Tech University</i>
Brittany C. Burkett	<i>Texas Tech University</i>
Jeffrey N Wherry	<i>Texas Tech University</i>

23. Development of the Self-Efficacy for Managing the Stress Response Scale

Jessica Lynn Tworek	<i>Texas A & M University - Corpus Christi</i>
Ashley D. Louie	<i>Texas A & M University - Corpus Christi</i>
Caroline Cordero Hall	<i>Texas A & M University - Corpus Christi</i>
Yaron Rabinowitz	<i>Texas A & M University - Corpus Christi</i>

24. Using Logotherapy to Help Athletes with Career Termination Issues: A Case Study

Todd Ryska	<i>Army Center for Enhanced Performance, Ft. Hood, TX</i>
------------	---

25. Changes in Self-Efficacy for Managing the Stress Response and Sports Anxiety

Ashley D. Louie	<i>Texas A & M University - Corpus Christi</i>
Jessica Lynn Tworek	<i>Texas A & M University - Corpus Christi</i>
Caroline Cordero Hall	<i>Texas A & M University - Corpus Christi</i>
Yaron Rabinowitz	<i>Texas A & M University - Corpus Christi</i>

26. Pain Coping Styles of Nontraditional Female Athletes

Michael C. Meyers	<i>Montana State University</i>
Anthony E. Bourgeois	<i>Texas A & M University - College Station</i>
Arnold Dallas LeUnes	<i>Texas A & M University - College Station</i>
Shane I Hudson	<i>Texas A & M University - College Station</i>

27. Socioecology of Territoriality in the Painted Bunting (*Passerina ciris*)

Magdalen Ann Beiting	<i>University of Dallas</i>
Marjorie Camille O'Connor	<i>University of Dallas</i>

SWPA Undergraduate Research Competition

Thursday, 8:30 AM - 10:00 AM

Session: [3]

Chaired by: Arnold Froese

Room: Grand Ballroom E

1. Are We Green, Grey, or Do We Just Act That Way?

Hannah Abbott	<i>University of Central Arkansas</i>
---------------	---------------------------------------

2. The Effects of an Intervention on Students' Critical Thinking about Nonscientific Claims

Noah David Pierce	<i>Washburn University</i>
-------------------	----------------------------

3. Delayed Risk-Taking

Bradley D. Gossett	<i>University of Central Arkansas</i>
--------------------	---------------------------------------

4. To Deceive or Not to Deceive? Testing Cognitive Dissonance Theory without Deception

Joshua H Crunkleton	<i>University of Central Arkansas</i>
---------------------	---------------------------------------

5. Relationship Quality, Respect, and Happiness among Young Adults

Cleve Alexander Graver	<i>Northern Arizona University</i>
------------------------	------------------------------------

SWPA Talks: Sexual Behaviors

Thursday, 8:30 AM - 10:00 AM

Session: [4]

Chaired by: Laura Spiller

Room: Bent Tree 1

1. Hyperfemininity, Sexual Self-Concept, and Risk for Sexual Victimization

Amy English	<i>Midwestern State University</i>
Laura C Spiller	<i>Midwestern State University</i>
Sabrina Bradley	<i>Midwestern State University</i>

2. Men Dislike Nail Polish: Masculinity, Discipline, Aggression, and Attitudes Toward Homosexuals

Daniel Alberto Arevalo	<i>University of Dallas</i>
------------------------	-----------------------------

3. Women's History of Athletic Involvement: Risk or Protective Factor for Sexual Coercion

Elise Brown	<i>Midwestern State University</i>
Laura C Spiller	<i>Midwestern State University</i>
Beverly L. Stiles	<i>Midwestern State University</i>
Susan Marie Gross	<i>Midwestern State University</i>

4. Gender Concepts as Moderators of Sexual Behaviors

Ashley K. Billig	<i>Texas A & M University - Corpus Christi</i>
Pamela Brouillard	<i>Texas A & M University - Corpus Christi</i>

5. Measuring Male College Students Perceptions of Coercive Sexual Initiation Strategies

Jubilee Dickson	<i>Midwestern State University</i>
Jayla Jorene Davis	<i>Midwestern State University</i>
Laura C Spiller	<i>Midwestern State University</i>

6. Stereotypical Gender Role Beliefs and Aggression in College Dating Relationships

Robert Michael Gresham	<i>Midwestern State University</i>
Laura C Spiller	<i>Midwestern State University</i>

SWPA Symposium: Trauma in Multicultural Populations

Thursday, 8:30 AM - 10:30 AM

Session: [5]

Chaired by: D Jones-Wiley

Room: Bent Tree 3

Trauma in Multicultural Populations: Perceptions, Effects, Coping and Resiliency

D Gabrielle Jones-Wiley	<i>Jackson State University</i>
Jean Kesnold Mesidor	<i>Jackson State University</i>
Porshia Lynette Haymon	<i>Jackson State University</i>
Stacey Leist-Haynes	<i>Jackson State University</i>
Ashley Early King	<i>Jackson State University</i>
Lindsey Davis	<i>Jackson State University</i>
Keith Hudson	<i>Jackson State University</i>

Psi Chi: Conversation Hour-How to Develop Leadership Skills

Thursday, 9:00 AM - 10:00 AM

Session: [6]

Chaired by: Randall Osborne and Laura Crocker

Room: Mesquite 1

SWPA Symposium: ACU's Mobile Learning Initiative

Thursday, 9:00 AM - 10:00 AM

Session: [7]

Chaired by: Scott Perkins and Christina Perkins

Room: Preston Trail 1

ACU's Mobile Learning Initiative: Educating for the 21st Century Learner

Scott Perkins	<i>Abilene Christian University</i>
Christina M. Perkins	<i>Abilene Christian University</i>

TPA CE Session: Insuring Against Insurance: Practical Steps and Simple Solutions to Keep your Billing Compliance

Thursday, 9:00 AM - 11:00 AM

Session: [8]

Chaired by: Troy Brooks and Jan Spears

Room: Addison Meeting Room

Insuring Against Insurance: Practical Steps and Simple Solutions to Keep your Billing Compliance

Troy Brooks

Troy Brooks and Associates, PC

Jan Spears

MJS & Associates

Saul Sells Lecture: Karen Pryor

Thursday, 10:30 AM - 11:30 AM

Session: [9]

Chaired by: Scott Bailey

Room: Grand Ballroom E

Reaching the Animal Mind

Operant conditioning using secondary reinforcers as event markers—otherwise known as clicker training—is revolutionizing animal care. Paraplegics and blind people train their own service dogs. Children as young as nine can teach the new puppy punishment-free games that prevent nipping and jumping up. Zoo trainers teach ALL the animals, from tigers and giraffes to birds and reptiles, to cooperate in their own medical care, including voluntary blood draws. The human version, called TAG teaching, speeds up skills acquisition in sports, physical therapy, language, music, and for people with special needs including autism. Karen Pryor, author of *Don't Shoot the Dog* and, recently, *Reaching the Animal Mind*, will take us on a visual tour of new apps of an old science. See how you might use it yourself!

Will be followed by a conversation hour at 11:30 AM

SWPA/TPA Poster Session 2: Cross Cultural, Gay/Lesbian Issues, Religion, Sexual Behavior, Personality

Thursday, 10:30 AM - 12:00 PM

Session: [10]

Room: Salons A-D

1. Age and Gender Differences on Subjective Well-being - A Cross-cultural Study

Qingwei Wang

Collin County Community College

2. Anxiety Symptoms Are Differentially Related to HbA1c Levels among Rural-Dwelling Female Adults

Valerie Hobson

Texas Tech University Health Sciences Center

Leigh Johnson

Texas Tech University Health Sciences Center

Sid E O'Bryant

Texas Tech University Health Sciences Center

3. Perceptions of Outstanding University Teachers In the United States and Russia

Bill J. Lammers

University of Central Arkansas

Elena Savina

James Madison University

4. A Cross-Cultural Study of Gender, Ethnic Identity and Self-Esteem

Amanda Schnelle

Texas Lutheran University

5. An Exploration of Relationship Options among Hispanic College Students

Deborah Kay Huerta	<i>University of Texas - Brownsville</i>
Virginia V. Wood	<i>University of Texas at Brownsville</i>
Matthew C. Johnson	<i>University of Texas - Brownsville</i>

6. Capitalization and Friendship among Young Adults in Saudi Arabia

Meliksah Demir	<i>Northern Arizona University</i>
----------------	------------------------------------

7. Racial Differences in Stigmatization of the Mentally III

Polina Radchenkova	<i>Alcorn State University</i>
Polly A. Stone, Ph.D.	<i>Alcorn State University</i>
Glenn D. Shean	<i>College of William & Mary</i>
Jacintha Green	<i>Alcorn State University</i>

8. Don't Ask, Don't Tell: An Exploratory Study of the Lesbian Military Experience

Meladee LaNay Garst	<i>Oklahoma State University</i>
Julie Dorton Clark	<i>Oklahoma State University</i>

9. Sex Role Identification and Self-Esteem in Female to Male Transgender Individuals

Lisa Hughes	<i>University of Houston</i>
Stacey Meier	<i>University of Houston</i>

10. Investigating the Role of Parenting in Female to Male Transgender Individuals

Stacey Meier	<i>University of Houston</i>
Lisa Hughes	<i>University of Houston</i>

11. Knowledge and Its' Effects on People's View of Homosexuality

Sarah Marie Ball	<i>Texas A & M University - Commerce</i>
------------------	--

12. A Comparison of Infidelity in Men and Women

Barbara Duff Calvert	<i>Louisiana Tech University</i>
Richard L Sylvester	<i>Louisiana Tech University</i>
Walter Buboltz	<i>Louisiana Tech University</i>

13. The Effects of Attractiveness and Economics on Attitudes regarding Sexual Behavior

Julie Angelica Caudle	<i>Texas A & M University - Corpus Christi</i>
Steven D. Seidel	<i>Texas A & M University - Corpus Christi</i>

14. Attractiveness and Sexual Promiscuity

Robert L Boughner	<i>Rogers State University</i>
Jessica A. Marchewka	<i>Rogers State University</i>

15. The Relationship between Feminist Identity Development and Vulva Self-Image

Amy Nicole Madewell	<i>Oklahoma State University</i>
---------------------	----------------------------------

16. Effect of Preference for Consistency on Perception of Appearance

Cristin Tkachuk	<i>University of Central Arkansas</i>
-----------------	---------------------------------------

17. Exploration of the Relationship between Implicative Dilemmas and Psychological Well-Being

Stefanie I Badzinski	<i>Oklahoma State University</i>
James W. Grice	<i>Oklahoma State University</i>

18. Friendship Quality, Intimacy Motivation, and Happiness: A Meditational Model

L. Dakota Dudney	<i>Northern Arizona University</i>
------------------	------------------------------------

19. Personality Assessment and Student Retention

Robert L. Montgomery *University of Missouri - Rolla*
 Frances Haemmerlie Montgomery *University of Missouri - Rolla*

20. Measuring Personality in the National Longitudinal Study of Adolescent Health

Alexander Beaujean *Baylor University*
 J. Kenneth Young *Lamar University*

21. Big Five Personality Factors: As Predictors of Recycling

Ruth A Provost *Williams Baptist College*
 Lana s Rhoads *Williams Baptist College*
 Paul A. Rhoads *Williams Baptist College*

22. Facebook, Twitter, and Personality: Individual Differences and Use of Social Networking Sites

Alec Cunningham *High Point University*
 Jana S. Spain *High Point University*

23. Personality and Belief Correlates of the Out-Of-Body Experience

James Erik Robbins *Louisiana Tech University*
 Jerome J Tobacyk *Louisiana Tech University*
 Mary M Livingston *Louisiana Tech University*

24. The Relationship between Attachment Styles and Action Control

Christina George *Our Lady Of The Lake University*
 Loranel M Graham *Our Lady Of The Lake University*

25. Openness and Spirituality: Religious Views, Mindfulness, and Social Attitudes

Julie Beth Swagerty *Oklahoma State University*
 Maria Howell *Oklahoma State University*
 Sue C Jacobs *Oklahoma State University*
 Nathan D'Coby Richards *Oklahoma State University*
 Anne Weese *Oklahoma State University*
 Richard Calleja Zamora *Oklahoma State University*

26. The Relationship Between Protestant Fundamentalism, Religiosity, and Intelligence.

Julie White *University of Central Oklahoma*
 Sarah Michelle Scott *University of Central Oklahoma*
 Caleb W Lack *University of Central Oklahoma*

27. An Examination of Sex Differences in Type and Perceived Effectiveness of Prayer

Maggie Bean *Texas A & M University - Corpus Christi*
 Mark G. Hartlaub *Texas A & M University - Corpus Christi*
 Mary Anastasia Taylor *Texas A & M University - Corpus Christi*

28. Religiosity and Health Behavior Patterns in Caucasian and Hispanic College Students

Maggie Bean *Texas A & M University - Corpus Christi*
 Sarah Evans *Texas A & M University - Corpus Christi*
 Yaron Rabinowitz *Texas A & M University - Corpus Christi*

29. An Examination of the Content of Religious Humor

Ashley D. Louie *Texas A & M University - Corpus Christi*
 Mark G. Hartlaub *Texas A & M University - Corpus Christi*

Psi Chi: What the Student Researcher Needs to Know About Ethics

Thursday, 11:30 AM - 12:30 PM

Chaired by: Shelia Kennison

Session: [11]

Room: Mesquite 2

Panelists:

Sue Jacobs (Oklahoma State University)

Yvonne Montgomery (Langston University)

SWPA: Conversation Hour- Karen Pryor

Thursday, 11:30 AM - 12:30 PM

Session: [12]

Room: Grand Ballroom E

TPA Symposium: Business Aspects of Private Practice

Thursday, 11:30 AM - 12:30 PM

Session: [13]

Chaired by: Monique Levermore

Room: Preston Trail 2 and 3

Business and Psychology: Negotiating the business aspects of private practice

Monique Levermore

Carlos Albizu University

SWPA Symposium: How Do Students Learn to Avoid Plagiarism

Thursday, 11:30 AM - 12:30 PM

Session: [14]

Chaired by: Sharon Roberts

Room: Preston Trail 1

How Do Students Learn to Avoid Plagiarism?

Sharon L Roberts

Northeastern State University

Kevin Johnson

Northeastern State University

Alesa Liles

Northeastern State University

Buffy Ann Hall

Northeastern State University

Lindsey Michelle Swagerty

Northeastern State University

SWPA Poster Session 3: Educational Psychology, School Psychology, Teaching of Psychology and Faculty

Thursday, 12:30 PM - 2:00 PM

Session: [15]

Room: Salons A-D

1. Factors Impacting Student and Faculty Perceptions: Incongruent Expectations in the Advising Relationship

Stephanie Dixon

Missouri State University

Tracie D. Burt

Missouri State University

Adena Young

Missouri State University

2. General Psychology Midterm Grades Used to Identify Academically At-Risk College Students

George M. Diekhoff

Midwestern State University

Michael Vandehey

Midwestern State University

Crystale Michelle Marsh

University of Texas of the Permian Basin

3. Remedial College Students Use of Literacy for Academic and Leisure Pursuits

Kari Watkins

Stephen Burgess

Southwestern Oklahoma State University

4. Self-Perceptions of Childhood Television Viewing: A Quantitative and Qualitative Preliminary Study

Julia M Hogan

University of Dallas

5. Small Groups and Online Journaling as Undergraduate Multicultural Instructional Strategies

E. Allen Eason

American Psychological Society

Brenda Lee McDaniel

Kansas State University

Jaree Danielle Basgall

Kansas State University

Alex Caitlin Elliott

Kansas State University

6. The Relationship Between Academic Attitudes and Theories of Intelligence

Mary M Livingston

Louisiana Tech University

Alice P Carter

Louisiana Tech University

Tracy Harper

Louisiana Tech University

7. Active Exploration of and Commitment to Gender Roles: A New Scale

Nga T. Nguyen

University of Houston

Margaret Schwartz Moravec

University of Houston

Ashlie Brown

University of Houston

Jennifer Stinson

University of Houston

Krisztina Petho-Robertson

University of Houston

8. First-Generation Transfer Students' Perceptions: Implications for Retention and Success

Melissa Hawthorne

Texas A & M University - Commerce

Adena Young

Missouri State University

9. Reasons for Online vs. Face-to-Face University Student Instructional Modality Preference

Rick Harrington

University of Houston - Victoria

Donald A. Loffredo

University of Houston -Victoria

10. Self-Efficacy and Learning in Sororities and Fraternities

Jon G. Thompson

Texas State University - San Marcos

Crystal D Oberle

Texas State University-San Marcos

11. Self-Regulated Learning: Are Females More Active in the Learning Process?

Ida Chauvin

Louisiana Tech University

Alice P Carter

Louisiana Tech University

Ashley N Carroll

Louisiana Tech University

Mary M Livingston

Louisiana Tech University

12. Test-Anxious Thoughts: Dimensions and Time-Course

Eelson M. Bihm

University of Central Arkansas

Troy Michael E Marsden

University of Central Arkansas

13. The Relationship Between Perceived Parent Attitudes and Student Attitudes Toward Mathematics

Beatrice Charmaine Mosier	<i>Louisiana Tech University</i>
Alice P Carter	<i>Louisiana Tech University</i>
Julie A. Osland	<i>Wheeling Jesuit University</i>
Mary M Livingston	<i>Louisiana Tech University</i>

14. Making the Grade: A Qualitative Pilot Study of a High-School Graduate

Christina Norma Rodriguez	<i>University of Dallas</i>
---------------------------	-----------------------------

15. Procrastination, Self-Esteem and Commitment Issues in a Sample of University Students

Leslie Karen Eslava	<i>University of Dallas</i>
---------------------	-----------------------------

16. Anxiety, Gender, Information Processing Speed, and Achievement in Rural High School Students

Shereen LaFaye Traylor	<i>APA</i>
Steven Roring	<i>APA</i>
Merly Mathew	<i>Oklahoma State University</i>

17. Neuroimaging and Autism: Functional MRIs

Lucila Leal	<i>La Joya ISD-La Joya, TX</i>
Jo A. Mitchell	<i>University of Texas Pan American</i>

18. Student-Teacher Relationships Quality Matters... But What is Being Done About It?

James Lee Hopper	<i>University of Central Arkansas</i>
------------------	---------------------------------------

19. Are You Thinking of Teaching Honors General Psychology?

Edward P. Kardas	<i>Southern Arkansas University</i>
Chrisanne Christensen	<i>Southern Arkansas University</i>

20. Can We Teach Social Justice through Social Psychology Curriculum? A Preliminary Step

Lisa K. Lockhart	<i>University of the Incarnate Word</i>
------------------	---

21. Facebook and Psychology: Use and Misuse of Social Networks.

Matthew T Kincheloe	<i>University of Central Oklahoma</i>
David B Weed	<i>University of Central Oklahoma</i>
Caleb W Lack	<i>University of Central Oklahoma</i>

22. Perceived Interest and Difficulty of Topics in General Psychology: A Descriptive Comparison

Jared F. Edwards	<i>Southwestern Oklahoma State University</i>
Jorie Hitch Edwards	<i>Southwestern Oklahoma State University</i>
Melinda Burgess	<i>Association for Psychological Science</i>

23. Using a Class Capture System to Enhance Academic Performance

William A Montgomery	<i>Angelo State University</i>
----------------------	--------------------------------

24. Additional Psychometric Data for the Activities Inventory: Revised Factor Structure and Normative Sample

Theresa A. Wozencraft	<i>University of Louisiana-Lafayette</i>
Brenton Ray Abadie	<i>University of Louisiana - Lafayette</i>

25. Behavioral Traits that Help Identify Model Students: A Professors' Perspective.

James Leyton	<i>Texas A & M University - Corpus Christi</i>
Katie Young	<i>Texas A & M University - Corpus Christi</i>
Brenda Mundahl	<i>Texas A & M University - Corpus Christi</i>
Jeff Rock	<i>Texas A & M University - Corpus Christi</i>

26. Coverage of Diversity in Introductory Psychology Textbooks

Lawrence Tran	<i>Oklahoma State University</i>
Jessica Curtis	<i>Oklahoma State University</i>
Kristopher I. Bradley	<i>Oklahoma State University</i>
Shelia M Kennison	<i>Oklahoma State University</i>

27. Myth Busting Keyless Entry: Teaching Mixed Design Factorial ANOVA

Gilbert J. Garza	<i>University of Dallas</i>
Brittany Landrum	<i>University of Dallas</i>

28. Psychotherapy Trainees and Social Networking Use.

David B Weed	<i>University of Central Oklahoma</i>
Matthew T Kincheloe	<i>University of Central Oklahoma</i>
Caleb W Lack	<i>University of Central Oklahoma</i>

29. The Perceptions and Impacts of Smiley Emoticons in Computer-Mediated Communication

Mei Jiang	<i>Texas A & M University - Commerce</i>
Adena Young	<i>Missouri State University</i>

30. Cyberbullying among High School Students: Cluster Analysis and Sex and Age Differences.

Ikuko Aoyama	<i>Baylor University</i>
--------------	--------------------------

SWPA Symposium: Interdisciplinary Research: A Graduate Student Perspective

Thursday, 1:00 PM - 2:00 PM

Session: [16]

Chaired by: Amy Madewell

Room: Bent Tree 2

The Logistics of Interdisciplinary Research: A Graduate Student Perspective

Amy Nicole Madewell	<i>Oklahoma State University</i>
Aimee J Barrett	<i>Oklahoma State University</i>
Jessica S Parker	<i>Oklahoma State University</i>
Adelina Longoria	<i>Booz Allen Hamilton</i>

Psi Chi Talks: Session 1

Thursday, 1:00 PM - 2:30 PM

Session: [17]

Chaired by: Randall Osborne

Room: Mesquite 2

1. A Cockatoo to Cheer You: Animal Assisted Therapy Using an Umbrella Cockatoo

Jacquelyn Louise Allen	<i>Henderson State University</i>
Todd Wiebers	<i>Henderson State University</i>

2. Group Versus Individual Performance in Tasks with Varying Levels of Difficulty

Michael Schwartz	<i>Samford University</i>
------------------	---------------------------

3. Anticipated Interaction and Dovidio and Gaertner's (2005) Integrated Model of Racism

Brad Cameron	<i>University of Central Arkansas</i>
--------------	---------------------------------------

4. Middle Eastern Stereotypes and the Influence of Language

Paul B Harwell	<i>Stephen F. Austin State University</i>
----------------	---

5. Cross-Cultural Differences in Social and Group Discounting

Caitlin Porter	<i>University of Central Arkansas</i>
----------------	---------------------------------------

6. No Need to Lie: Testing Cognitive Dissonance Theory without Deception

Tosha Marie Honey

University of Central Arkansas

SWPA/TPA Talks: Clinical/Counseling, Family, Personality, Stress

Thursday, 1:00 PM - 3:00 PM

Session: [18]

Chaired by: David Carlston

Room: Preston Trail 2 and 3

1. Supervising Student-Therapists: Suggestions for the Transfer of Long-Term Psychotherapy Patients

Frank Trimboli

University of Texas Southwestern Medical Center - Dallas

Charles William Keenan

Texas A & M University - Commerce

2. Self-Monitoring of Target Behaviors by Individuals with Intellectual/Developmental Disabilities

Gerald Edward Nissley

Deer Oaks

3. Toward a Model for Predicting Family Dysfunction and Cohesion

Joy E. Reagan

Texas Woman's University

Edward T Asbury

Texas Woman's University

4. Personality and Online Social Environments

Jason D. Ferrell

University of Central Oklahoma

Alicia Limke

University of Central Oklahoma

5. Theory of Mind and Pathological Dimensions of Personality in College Students

Shannon Akin

Texas A & M University - Commerce

Tracy B Henley

Texas A & M University - Commerce

Steven Edward Ball

Texas A & M University - Commerce

6. Rock Me Amadeus: Mozart versus Biofeedback

Gracee Jean Trawick

Texas Lutheran University

Krystal Parham

Texas Lutheran University

Scott A Bailey

Texas Lutheran University

7. Internet Addiction as it Relates to Symptom Distress and Functioning

David L Carlston

Midwestern State University

SWPA CE Session: Psychotherapy in Depression

Thursday, 1:00 PM - 4:00 PM

Session: [19]

Chaired by: Jeff Brooks-Harris

Room: Addison Meeting Room

Multitheoretical Psychotherapy for Depression: Combining Effective Strategies and Working Interactively

Jeff E Brooks-Harris

Texas Woman's University

Melvin L. Varghese

Texas Woman's University

Camille Hannah Benson

Texas Woman's University

LeAnne M Shepard

Texas Woman's University

Andrea Kathleen Ryan

Texas Woman's University

SAMR Invited Address: James Grice

Thursday, 2:00 PM - 3:00 PM

Session: [20]

Chaired by: Linda Hynan

Room: Grand Ballroom E

Recovering our Common Sense: Psychology as an Observation Oriented Science

Since the early 1900s psychological research has been dominated by statistical methods that are overly abstract and often ill-suited for the types of questions most psychologists wish to ask. In this presentation, Observation Oriented Modeling will be introduced as a radical alternative to these traditional methods of data analysis. Observation Oriented Modeling challenges researchers to develop integrated models that explain patterns of observations rather than estimate abstract population parameters. The focus of research is thus shifted away from aggregate statistics and is instead directed toward assessing the accuracy of judgments based on the observations in hand. This shift brings the persons in a psychological study to the forefront of the analysis and conclusions, while completely eschewing such confusing concepts as Type I, Type II, Type III errors, statistical power, and the p-value.

SCPA: Talks 1

Thursday, 2:30 PM - 3:30 PM

Session: [21]

Chaired by: Scott Coleman

Room: Salons G-H

1. Male Japanese Quail Mating Strategies are Determined by Previous Mating Success

Amanda Glueck	<i>Centre College</i>
Brian Cusato	<i>Centre College</i>
Melissa Burns-Cusato	<i>Centre College</i>

2. Conditioned Anti-Predatory Behavior in Mulloway

Jesse E. Purdy	<i>Southwestern University</i>
Morgan Elizabeth Mingle	<i>Southwestern University</i>

3. "Who's Your Daddy": Kin Recognition in Prepubescent and Adult Rats.

Jessica L Bolton	<i>Southwestern University</i>
Brittany Joyce Ford	<i>Southwestern University</i>
Carissa Winland	<i>Southwestern University</i>
Fay Guarraci	<i>Southwestern University</i>

4. Caffeine Withdrawal May Impair Latent Maze Learning in Rats

Adelle Katheryne Novier	<i>Texas Lutheran University</i>
Cristal Mercedes Hernandez	<i>Texas Lutheran University</i>
Scott A Bailey	<i>Texas Lutheran University</i>

Psi Chi: Conversation Hour-Build and Maintain Vital Psi Chi Chapter

Thursday, 2:30 PM - 3:30 PM

Session: [22]

Chaired by: Evan Zucker and Laura Crocker

Room: Mesquite 1

Psi Chi Poster Session 1

Thursday, 2:30 PM - 4:00 PM

Chaired by: Randall Osborne

Session: [23]

Room: Salons A-D

1. Alcohol Use and Depression among Adolescents: The Impact of Family Structure

Monique Sharyn Grant

Prairie View A & M University

2. Aspects of Lying Within Communication

Benjamin J Parker

McNeese State University

Keri Nicole Theriot

McNeese State University

Clinton Smith

McNeese State University

Justin James Daigle

McNeese State University

3. Establishing the Need for a Peer Led Relationship Violence Program

Amber D Amonette

Southern Arkansas University

4. Fostering Better Relationships: Exploring Early Childhood Influences and Moral Emotional Development

Jaree Danielle Basgall

Kansas State University

Alex Caitlin Elliott

Kansas State University

Brenda Lee McDaniel

Kansas State University

5. Hello Cutie! Perceptions of Girls and Boys

Victoria Eliza Sank

St. Edward's University

6. Introverted but Not Shy: A New Perspective on the Measurement of Introversion

Lauren E Margulieux

Southwestern University

Traci A Giuliano

Southwestern University

Kathryn L Bollich

Southwestern University

Stacy Ellane Mathis

Southwestern University

Whitney L. Laas

Southwestern University

7. Monotony in Monogamy: A Study of Females Seeking to Have an Affair

Clinton Smith

McNeese State University

Justin James Daigle

McNeese State University

Benjamin J Parker

McNeese State University

8. New Age Names versus Traditional Names on Job Applications

Heather M Butler

Stephen F. Austin State University

Lisa D. Topp

Stephen F. Austin State University

9. Primary Drug Addictions and the SOCRATES

Benjamin J Parker

McNeese State University

Cameron L Melville

McNeese State University

10. Shy to "Fly": Testing the Effectiveness of Self-Presentation Strategies of Shy Individuals

Stacy Ellane Mathis

Southwestern University

Whitney L. Laas

Southwestern University

Kathryn L Bollich

Southwestern University

Traci A Giuliano

Southwestern University

Lauren E Margulieux

Southwestern University

11. Social Anxiety and Rumination: Effect on Anticipatory Anxiety, Memory Bias, and Beliefs

Kurt Wayne Einsel

Washburn University

12. The Acquisition of Heteronormativity: The Belief that Heterosexuality is Normal

Justin James Daigle	<i>McNeese State University</i>
Benjamin J Parker	<i>McNeese State University</i>

13. The Effect of Multiple Schedules on Learning

Zachary J. Bond	<i>McNeese State University</i>
Benjamin J Parker	<i>McNeese State University</i>

14. The Effects of Gender and Activity on Time Spent in Car

Brian G Broussard	<i>University of Central Arkansas</i>
Greg W Edgin	<i>University of Central Arkansas</i>
Kalyn Paul Hoggard	<i>University of Central Arkansas</i>

15. The Experience of Being Heard While in Treatment for a Mental Illness

Lindsey Schutze	<i>University of Dallas</i>
-----------------	-----------------------------

16. The Relationship between Social and Probability Discounting

Tiffany Kaye Bullard	<i>University of Central Arkansas</i>
----------------------	---------------------------------------

17. The Sexting Personality: A NEO-PI-R Profile

Kristina Renee Blue	<i>Williams Baptist College</i>
---------------------	---------------------------------

18. Treatment Modality Variances for Trichotillomania by Sex, Age, and Comorbidity

Brad Gros	<i>University of Louisiana - Lafayette</i>
Lisa Wegener	<i>University of Louisiana - Lafayette</i>

19. When to Whistle-Blow: Factors that Effect Perceptions of Informants of Academic Cheating

Stacy Ellane Mathis	<i>Southwestern University</i>
Amanda Lee Burkett	<i>Southwestern University</i>

SWPA Talks: Educational Psychology, School Psychology, Measurement, Sports

Thursday, 2:30 PM - 4:00 PM

Session: [24]

Chaired by: Beth Jones

Room: Bent Tree 3

1. Parental Participation in Individual Education Programs: Effects of Family Variables and Mini-Conferencing

Beth A. Jones	<i>Texas A & M University - Commerce</i>
---------------	--

2. Improving Self-concept in Elementary Special Education Students: A Vocational Training Model

Beth A. Jones	<i>Texas A & M University - Commerce</i>
Kashunda Lynn Williams	<i>Texas A & M University - Commerce</i>
Tasia Sharanne Barrett	<i>Texas A & M University - Commerce</i>

3. The Student-Instructor Relationship Scale as a Predictor of Academic Success

Felecia Kristina Cagle	<i>University of Central Arkansas</i>
------------------------	---------------------------------------

4. Transitioning Special Needs Preschool Children To Kindergarten: Comparing WPPSI-III and WISC-IV Scores

Deborah Jewel Wilson	<i>Southern Arkansas University</i>
----------------------	-------------------------------------

5. Occupational Burnout Among College Coaches: How are Leadership and Administrative Characteristics Related?

Todd Ryska	<i>Army Center for Enhanced Performance, Ft. Hood, TX</i>
------------	---

6. The Role of Self Organization on Friendship Quality

Zach Krings	<i>Northern Arizona University</i>
Meliksah Demir	<i>Northern Arizona University</i>

SAMR Conversation Hour: James Grice

Thursday, 3:00 PM - 4:00 PM

Session: [25]
Room: Bent Tree 3

Missouri State Representative Symposium

Thursday, 3:30 PM - 5:00 PM

Session: [26]

Chaired by: Frances Montgomery

Room: Preston Trail 2 and 3

Teaching the Psychology of Gender in the 21st Century

Our presentation will encompass an informational and experiential symposium designed to educate and engage participants about current issues related to the psychology of gender. Particular emphasis will be given to addressing sexism and sexist experiences. Additionally, a variety of approaches and techniques will be presented regarding how to most effectively teach students about gender issues in contemporary psychology classes.

Frances Haemmerlie Montgomery

University of Missouri - Rolla

Debra Mollen

Texas Woman's University

Virginia Maril

Texas Woman's University

Jennifer Mootz

Texas Woman's University

Ron Paul

Texas Woman's University

SWPA: Student Caucus

Thursday, 4:00 PM - 5:00 PM

Session: [27]

Room: Bent Tree 2

Chaired by: Benjamin England and Kevin Windecker

Meet with other students and the student representatives on SWPA's Executive Committee (EC). This time is designed to build connections between members and the EC and to solicit student comments and ideas about SWPA and the convention.

SWPA Social

Thursday, 5:00 PM - 7:00 PM

Session: [28]

Room: Grand Ballrooms E & F

Come join us for conversation, beverages, light hors d'oeuvres and door prizes. Several of SWPA's full members will be facilitating Topic Table discussions during part of the social (check the program front pages for the list of topics and facilitators).

Friday – April 9, 2010

Psi Chi: Workshop-Multicultural Awareness and Teaching

Friday, 8:00 AM - 9:00 AM

Session: [29]

Chaired by: Kathryn Lee

Room: Mesquite 2

CUPP Breakfast Meeting

Friday, 8:00 AM - 9:00 AM

Session: [30]

Chaired by: Scott A Bailey

Room: Cafe Costa Restaurant and Bar

Ask for the CUPP breakfast which will be held at the Cafe Costa Restaurant and Bar located in the convention hotel.

APA's proposed Principles for Quality Undergraduate Education in Psychology currently under review will be discussed.

SWPA Graduate Research Competition

Friday, 8:00 AM - 9:30 AM

Session: [31]

Chaired by: Lauren Scharff

Room: Grand Ballroom E

1. Friendship, Perceived Mattering and Happiness Among American and Turkish Young Adults

Nicholas Bilyk

Northern Arizona University

2. Informational Influence and Ambiguity in Conforming to Perceptions of Sexual Harassment

Jessica Cascio

Lamar University

3. Investigating Prejudice and Openness toward Homosexual Persons

Richard L Sylvester

Louisiana Tech University

Dustin Shelby Whitlock

Louisiana Tech University

Rebecca Hoffmann

Louisiana Tech University

Barbara Duff Calvert

Louisiana Tech University

4. Do Happy and Angry Virtual Characters Elicit Emotional Responses in Humans?

Devin Pierce

Texas A & M University - Commerce

5. Political Orientation and Prejudice: A Test of the Integrated Model of Racism

Peter Zunick

University of Central Arkansas

SWPA Talks: Teaching of Psychology

Friday, 8:00 AM - 9:30 AM

Session: [32]

Chaired by: Arnold Froese

Room: Preston Trail 2 and 3

1. Academic Dishonesty: Perceptions of Prevalence, Risk, Emotional Impact.

David L Carlston

Midwestern State University

2. Methods to Increase Attendance and Performance in Large Lecture Classes

Lora L Jacobi

Stephen F. Austin State University

3. The Relationship of Critical Thinking and Personality Variables with Introductory Statistics Scores

Amy K Dicke-Bohmann *Texas A & M University-San Antonio*
Samuel K. Rock *Texas A & M University-San Antonio*

4. College Students' Texting Habits and Expectations of Effects on Learning

Christina N Carpenter *Sterling College*
Arnold D Froese *Sterling College*
Rebecca B Barnes *Sterling College*

5. The Effect of Texting on "Learning"

Arnold D Froese *Sterling College*
Denyse Ariana Inman *Sterling College*
Jessica Raquel Schooley *Sterling College*
Sarah M Tucker *Sterling College*
Jeffrey Ropp *Sterling College*
Brian M Allen *Sterling College*
Jasmin Daniela Chacon *Sterling College*
Andrea Jane Mehninger *Sterling College*

6. Determining the Validity and Reliability of the Lifelong Learning Skills Index

Marcel Satsky Kerr *Texas Wesleyan University*
Kimberly Rynearson *Tarleton State University*

SWPA Poster Session 4: Social, Crime and Delinquency

Friday, 8:30 AM - 10:00 AM

Session: [33]
Room: Salons A-D

1. Priming and Ethnicity Interaction Effects on Causal Attribution

Chris C Peterson *University of Texas - Dallas*

2. Praiseworthiness: The Effect of Background Information

Shirley M. Ogletree *Texas State University-San Marcos*
Jennifer Ann Covington *Texas State University - San Marcos*
Richard L. Archer *Texas State University - San Marcos*

3. Social Capital and Facebook Usage as Predictors of Satisfaction with College Life

Brittany Landrum *University of Dallas*
Gilbert J. Garza *University of Dallas*

4. Stereotyping in those with ADHD

Leigh Lorraine Bondurant *Hendrix College*
Leslie Wade Zorwick *Hendrix College*

5. The Effect of Mortality Salience on Weapon Bias

Matthew Spencer *Oklahoma State University*
Kristopher I. Bradley *Oklahoma State University*
Shelia M Kennison *Oklahoma State University*

7. The Impact of Coping Style on Financial Decision Making

Tommie Hughes *Texas A&M-Texarkana*

8. The Relationship of Self Control and Mate Preferences

April M Dickerson	<i>Texas A & M University - Corpus Christi</i>
Molly Bishop	<i>Texas A & M University - Corpus Christi</i>
Steven D. Seidel	<i>Texas A & M University - Corpus Christi</i>

9. Wanna Cyber? The Effect of Perceived Gender on Interactions within Chat Rooms

Andrew Bryan Serafino	<i>Texas Lutheran University</i>
Josh Haby	<i>Texas Lutheran University</i>
Tiffany L. Sia	<i>Texas Lutheran University</i>
Michael L. Czuchry	<i>Texas Lutheran University</i>

10. Child Abuse: Race & Relationship of the Caregiver

Tracy Michelle Kimble	<i>Henderson State University</i>
Aneeq Ahmad	<i>Henderson State University</i>

11. Excessive Chatting: The Impact of Co-rumination via Facebook Chat

Katie Starr	<i>Oklahoma State University</i>
David Lovett	<i>Oklahoma State University</i>
Kristin Hastings	<i>Oklahoma State University</i>
Brandon J. Auer	<i>Oklahoma State University</i>
Jennifer Byrd-Craven	<i>Oklahoma State University</i>
Shelia M Kennison	<i>Oklahoma State University</i>

12. Race and System Justification

Alex Woody	<i>Hendrix College</i>
Leslie Wade Zorwick	<i>Hendrix College</i>

13. The Dissonance Factor in Understanding Identity in Academic Achievement

Katherine L Pang	<i>University of Texas at Tyler</i>
------------------	-------------------------------------

14. Happiness and Other Psychological Correlates of Political Orientation

Peter Zunick	<i>University of Central Arkansas</i>
Paul R. Nail	<i>University of Central Arkansas</i>

15. Impression Formation for Self-Esteem in Online Social Networks

Monique Champagne	<i>Texas Woman's University</i>
Stephanie Burrows	<i>University of the Incarnate Word</i>
Christian L. Hart	<i>Texas Woman's University</i>

16. A Preliminary Study: College Students and Belief in the Paranormal

David M. Osburn	<i>Arkansas Tech University</i>
-----------------	---------------------------------

17. Abortion: A Look at Knowledge and Attitudes in College Students

Sara E. Sebek	<i>Henderson State University</i>
Todd Wiebers	<i>Henderson State University</i>

18. Anger Reactivity and Aggressive Behaviors in Females

Joseph Harris	<i>Stephen F. Austin State University</i>
Monica Rhodes	<i>Stephen F. Austin State University</i>
Andrew M Terranova	<i>Stephen F Austin State University</i>

19. Democrats and Republicans: Psychologically, Ideologically, or Altogether Different?

Allison Riels	<i>University of Central Arkansas</i>
Elizabeth Long	<i>University of Central Arkansas</i>
Shawn R Charlton	<i>University of Central Arkansas</i>

20. Evaluating Differences in Self-Concept between Genders

Elizabeth Patton	<i>University of Dallas</i>
------------------	-----------------------------

21. Female Suspicion as an Adaptive Process in Mate Evaluation

Laura Katherine Cowan	<i>Texas Woman's University</i>
Drew A. Curtis	<i>Texas Woman's University</i>
Christian L. Hart	<i>Texas Woman's University</i>

22. Gender and Vocality: Differences in Perception of Verbal Disinhibition in Couples

Susanna R. Hunter	<i>Hendrix College</i>
Melanie Morse	<i>Hendrix College</i>

23. Ingroup Perception of Outgroup Defection

Jamie S Snider	<i>Texas A & M University - Commerce</i>
Stephen M Reysen	<i>Texas A & M University - Commerce</i>

24. Looking Good and Honest: Perception of Believability of Males in Dating Videos

Drew A. Curtis	<i>Texas Woman's University</i>
Laura Katherine Cowan	<i>Texas Woman's University</i>
Christian L. Hart	<i>Texas Woman's University</i>

25. Measuring Ingroup Identification

Stephen M Reysen	<i>Texas A & M University - Commerce</i>
------------------	--

26. Mindfulness Awareness and Social Attitudes Differ Depending upon Political Beliefs

Nathan D'Coby Richards	<i>Oklahoma State University</i>
Sue C Jacobs	<i>Oklahoma State University</i>
Maria Howell	<i>Oklahoma State University</i>
Julie Beth Swagerty	<i>Oklahoma State University</i>
Richard Calleja Zamora	<i>Oklahoma State University</i>
Anne Weese	<i>Oklahoma State University</i>

27. Perpetrator Attractiveness and Age Influences Attitudes about Sexual Harassment

Gia Marie Bradley	<i>Texas Woman's University</i>
I'geal Che'rie Griffin	<i>Texas Woman's University</i>
Kristi Marie Heinrich	<i>Texas Woman's University</i>
Christian L. Hart	<i>Texas Woman's University</i>

28. Exploring Adolescent Delinquent Behavior and Influencing Variables: A Social Psychological Examination.

Keith Hudson	<i>Jackson State University</i>
--------------	---------------------------------

29. The Relationship between Emotional Intelligence and Anxiety in Adolescent Delinquent Males

John R. Barnett	<i>Southwestern Oklahoma State University</i>
Amy L. Barnett	<i>Southwestern Oklahoma State University</i>
Brittany Stewart	<i>Southwestern Oklahoma State University</i>
Natalie R James	<i>Southwestern Oklahoma State University</i>
Caleb M Scoville	<i>Southwestern Oklahoma State University</i>

SWPA Talks: Cognition/Memory, Neuropsychology, Human Factors, Sensation/Perception, Experimental

Friday, 8:30 AM - 10:00 AM

Session: [34]

Chaired by: Michael Czuchry

Room: Bent Tree 2

1. The Effects of Music Type on Mood and Memory

Jayne Tiemann	<i>Texas Lutheran University</i>
Leslie Elizabeth Fischer	<i>Texas Lutheran University</i>
Michelle Elise Dubroc	<i>Texas Lutheran University</i>
Michael L. Czuchry	<i>Texas Lutheran University</i>

2. The Effects of Visual Priming on Music Perception

Kyle Austin Leihnsing	<i>Texas Lutheran University</i>
Melanie Green	<i>Texas Lutheran University</i>
Michael L. Czuchry	<i>Texas Lutheran University</i>

3. Gender Differences in the Effect of Politeness in a Computerized Learning Task.

Sebastian Oliver Thomas	<i>Rice University</i>
David Lane	<i>Rice University</i>

4. Optimizing the Presentation of Visual and Auditory Information: Utilizing Echoic Memory

Daniel Shields Glaser	<i>Rice University</i>
David Lane	<i>Rice University</i>

5. Neural Correlates of Age Differences in Conjunction Search

Neena Rao	<i>University of Texas - Dallas</i>
Michael Allen Motes	<i>University of Texas - Dallas</i>

6. Staying Friends Forever: Technology's Effect on Friendship

Allison Lowry	<i>High Point University</i>
Kirsten Li-Barber	<i>High Point University</i>

SWPA Symposium: Friendship Experiences in Different Cultures

Friday, 8:30 AM - 10:00 AM

Session: [35]

Chaired by: Meliksah Demir

Room: Preston Trail 1

Friendship Experiences and Happiness among Young Adults in Different Cultures

Meliksah Demir	<i>Northern Arizona University</i>
Jacki Fitzpatrick	<i>Texas Tech University</i>
Kendra Patrice Marum	<i>Northern Arizona University</i>
Cleve Alexander Graver	<i>Northern Arizona University</i>

SWPA Workshop: Equine Facilitated Mental Health: A New Area for Psychology

Friday, 8:30 AM - 10:00 AM

Session: [36]

Chaired by: John Hall

Room: Bent Tree 3

Equine Facilitated Mental Health: A New Area for Psychology

John P. Hall	<i>Texas Wesleyan University</i>
--------------	----------------------------------

Psi Chi: Conversation Hour-Kathryn Lee

Friday, 9:00 AM - 10:00 AM

Session: [37]

Room: Mesquite 1

SCPA: Keynote Address and Talks 2

Friday, 9:00 AM - 11:00 AM

Session: [38]

Chaired by: Scott Coleman

Room: Salons G-H

The keynote address lasts from 9:00-10:00. The talks follow at 10:00-11:00.

Keynote Address: Mauricio R. Papini *Texas Christian University*

Developmental and Neurobiological Consequences of Selective Breeding for Recovery from Incentive Downshift

A selective breeding protocol was implemented for the recovery from a type of incentive downshift, consummatory successive negative contrast (cSNC). cSNC is a procedure in which rats given free access to 32% sucrose show a sharp suppression of drinking behavior after a downshift to 4% sucrose, compared to rats that always receive 4% sucrose. Suppression of drinking is followed by a gradual recovery of drinking behavior to the control level. We found differences in the isolation-induced positive vocalizations, in which pups in the two selected lines, L and H, emitted a lower number of high-frequency vocalizations (around 50 kHz) than pups in the control line (R). Furthermore, rats in the H line showed less sensitivity to the naloxone manipulation during incentive downshift compared to rats in the L and R lines. These results suggest that selective breeding for recovery from reward downshift results in a complex set of phenotypic changes that include modifications during the development. At least some of these effects may be mediated by changes in the effectiveness of opioid receptors.

1. The Paradoxical Effects of Morphine on Sexual Motivation in Female Rats.

Morgan Elizabeth Mingle	<i>Southwestern University</i>
Alexander S. Hall	<i>Southwestern University</i>
Jessica L Bolton	<i>Southwestern University</i>
Fay Guarraci	<i>Southwestern University</i>

2. Chronic Exposure to Methamphetamine Affects Sexual Behavior in Female Rats.

Carissa Winland	<i>Southwestern University</i>
Brittany Joyce Ford	<i>Southwestern University</i>
Jessica L Bolton	<i>Southwestern University</i>
Charles Haycox	<i>St. Edward's University</i>
Mark Eugene Maynard	<i>St. Edward's University</i>
Douglas M Clements	<i>St. Edward's University</i>
Christine Wise	<i>St. Edward's University</i>
Russell Frohardt	<i>St. Edward's University</i>
Fay Guarraci	<i>Southwestern University</i>

3. Anticipating Sexual Interactions Improves Behavioral Efficiency and Reproductive Success in Japanese Quail

Emily Sither *Centre College*

Brian Cusato *Centre College*

4. MePD Intracranial Infusions of Methamphetamine Have No Effect on Female Sexual Behavior

Charles Haycox *St. Edward's University*

Mark Eugene Maynard *St. Edward's University*

Douglas M Clements *St. Edward's University*

Christine Wise *St. Edward's University*

Carissa Winland *Southwestern University*

Brittany Joyce Ford *Southwestern University*

Jessica L Bolton *Southwestern University*

Russell Frohardt *St. Edward's University*

Fay Guarraci *Southwestern University*

TPA CE Session: Applying Neuroscience to Psychotherapy: Conceptualization, Intuition, Intervention

Friday, 9:00 AM - 12:00 PM

Session: [39]

Chaired by: Rowland Folensbee

Room: Addison Meeting Room

Applying Neuroscience to Psychotherapy: Conceptualization, Intuition, Intervention

Rowland W. Folensbee

Baylor College of Medicine

SWPA: Invited Speaker- Rick Miller

Friday, 10:00 AM - 11:00 AM

Session: [40]

Chaired by: Arnold Froese

Room: Grand Ballroom E

Teaching Students What They Don't Want to Learn

Effective teaching has always been more than filling students' heads with information. However, teaching becomes particularly challenging when students walk into the classroom with information, beliefs, and attitudes that are incompatible with the ideas to be learned. In this situation, teaching must address the task of changing students' minds rather than filling them. In this talk, I will discuss a variety of social influence techniques that can be used in a classroom setting to change students' minds and attitudes, especially students' beliefs in pseudoscientific and paranormal phenomenon.

Will be followed by a conversation hour at 11:00 AM

SWPA/TPA Poster Session 5: Health Behaviors, Developmental, Family

Friday, 10:30 AM - 12:00 PM

Session: [41]

Room: Salons A-D

1. The Impact of Exercise on Cognition: A Project FRONTIER Study

Valerie Hobson

Texas Tech University Health Sciences Center

Sid E O'Bryant

Texas Tech University Health Sciences Center

2. Beliefs about Obesity: Perceptions of Size and Obesity Stigma

Jennifer W Bacani

University of Texas - Dallas

Sanobar L. Patel

University of Texas - Dallas

Shayla C Holub

University of Texas - Dallas

3. Effects of TENS Unit and Cognitive Therapy in Patients with Chronic Pain

Ashley N Carroll

Louisiana Tech University

Lawrence S Dilks

Counseling Services of Southwest Louisiana

Salvatore Paul Carbonaro, Jr.

Fielding Graduate University

Andrew Justin Thrasher

Fielding Graduate University

Janice C. Marceaux

Shelley Blancett

Fielding Graduate University

4. Exploring the Relationship between Perceived Emotional Intelligence and Adaptiveness in Coping

Paula A Desmond

Southwestern University

Caitlyn L Carnes

Southwestern University

Meagan J Anderson

Southwestern University

5. Implications of a White Coat Stress Response on Mean Arterial Pressure

Carol Borden

Bemidji State University

Ming Mun Chong

Bemidji State University

6. Psychological and Behavioral Predictors of Health in Hispanic and Caucasian College Students

Sarah Evans

Texas A & M University - Corpus Christi

Maggie Bean

Texas A & M University - Corpus Christi

Yaron Rabinowitz

Texas A & M University - Corpus Christi

7. Scabies Survey of College Students Using Fear of Scabies Scale-10

Sangeeta Singg

Angelo State University

8. Social Harmony: The Effects of Music and Relaxation Training on Social Anxiety

Allison Stampahar

St. Edward's University

Helen D. Just

St. Edward's University

9. The Effects of Exercise on Female Stress and Emotion

Lauren Harrison

Austin College

Renee A Countryman

Austin College

10. College Students Use of Emotional Regulation as Related to Health

Enrique M Solis

University of Texas of the Permian Basin

Lewis Gene Busbee

University of Texas of the Permian Basin

Christina Heidi Thomas

University of Texas of the Permian Basin

Suzanne Rathbun

University of Texas of the Permian Basin

11. Exploring Emotional Intelligence and Coping within a Transactional Model of Stress

Paula A Desmond	<i>Southwestern University</i>
Julia Marie Paul Poritz	<i>Southwestern University</i>
Sarah Fritz	<i>Southwestern University</i>

12. God as a Supplement to Perceived Social Support

Jordan Cacici	<i>Hendrix College</i>
Robert Hessling	<i>Hendrix College</i>

13. Loving Yourself: The Relationship between Relaxation Techniques and Self-Compassion

Michael Sivinski	<i>St. Edward's University</i>
Helen D. Just	<i>St. Edward's University</i>

14. Ready, Set, Relax: Does Biofeedback/Relaxation Training Increase Scores on the GRE?

Helen D. Just	<i>St. Edward's University</i>
Michael Sivinski	<i>St. Edward's University</i>
Allison Stampahar	<i>St. Edward's University</i>
Samuel Warfield Cornish	<i>St. Edward's University</i>
Jorge Gonzalez	<i>St. Edward's University</i>
Naomi Broadway	<i>St. Edward's University</i>

15. Self Harm: Investigation into the Relationship of Self-harm & Body Image Dissatisfaction

Celeste Adriana Velazquez	<i>University of Texas - Pan American</i>
Jessica Connie Gonzalez	<i>University of Texas - Pan American</i>
Kristin L. Croyle	<i>University of Texas - Pan American</i>

16. The Effect of Self-Control Depletion on Health Risk Behavior

Amy Houlihan	<i>Texas A & M University - Corpus Christi</i>
Lauren Sanders	<i>Texas A & M University - Corpus Christi</i>
Lynn Marie Fahey	<i>Texas A & M University - Corpus Christi</i>
María Luisa Sanchez	<i>Texas A & M University - Corpus Christi</i>
Erica Dannelle Westbrook	<i>Texas A & M University - Corpus Christi</i>

17. The Psychological Characteristics of Exergamers and Traditional Exercisers

Ashley D. Louie	<i>Texas A & M University - Corpus Christi</i>
Maggie Bean	<i>Texas A & M University - Corpus Christi</i>
Sarah Evans	<i>Texas A & M University - Corpus Christi</i>
Yaron Rabinowitz	<i>Texas A & M University - Corpus Christi</i>

18. Attributions of Personal Traits: Is it my Parents' Fault?

Dena L Matzenbacher	<i>McNeese State University</i>
Linda Brannon	<i>McNeese State University</i>
Kaston Dariel Anderson Jr.	<i>McNeese State University</i>

19. Playing of Violent Video Games and School Performance among College Students

Kyle Toelle	<i>Association for Psychological Science</i>
Tasha Butterbaugh	<i>Association for Psychological Science</i>
Melinda Burgess	<i>Association for Psychological Science</i>
Stephen Burgess	<i>Southwestern Oklahoma State University</i>

20. Preschool Home Literacy Environments

Janet Vazquez *Association for Psychological Science*
 Stephen Burgess *Southwestern Oklahoma State University*

21. Sense and Sensibilities: Intelligence and Other Positive Psychosocialities

MaryLou Fair Worthen *Amberton University*

22. Ultrasonic Vocalizations: An Index of Social Interest and Frustration in Aged Rats?

Jennifer R Peterson *Texas Christian University*
 Colin Loris *Texas Christian University*
 Sam Nick Russo *Texas Christian University*
 Brenton G. Cooper *Texas Christian University*

23. A Picture is Worth a Thousand Words: Is Age One of Them?

Robert C Randow *Texas Lutheran University*
 Melissa Oehlke *Texas Lutheran University*

24. Mothers' Beliefs about Their Infants' Body Shapes: Accuracy and Associations with Feeding

Elaine Dolan *University of Texas - Dallas*
 Cin Cin Tan *University of Texas - Dallas*
 Flora Farago *University of Texas - Dallas*
 Sarah Lynn Trauterman *University of Texas - Dallas*
 Charles Schindler *University of Texas - Dallas*
 Sasha Moiger *University of Texas - Dallas*
 Elizabeth Marie Reith *University of Texas - Dallas*
 Shayla C Holub *University of Texas - Dallas*

25. Predicted Enjoyability of Violent Games by Sex and Age of Player

Brittany Stewart *Southwestern Oklahoma State University*
 Natalie R James *Southwestern Oklahoma State University*
 Caleb M Scoville *Southwestern Oklahoma State University*
 Melinda Burgess *Association for Psychological Science*
 Stephen Burgess *Southwestern Oklahoma State University*

26. Relations Between Maternal Blood Toxicants and Infant Encoding Speed

David G. Thomas *Oklahoma State University*
 Tessa Henard *Oklahoma State University*
 Nicki Lynn Aubuchon-Endsley *Oklahoma State University*
 Stephanie Lea Grant *Southern Nazarene University*
 Lawrence Tran *Oklahoma State University*

27. The Effects of Parental Military Deployment: An Adjustment Perspective

Bethany Moore *Sam Houston State University*
 Marsha J Harman *Sam Houston State University*

28. Teacher Reports about Conflict Types and Conflict Resolution Strategies in the Classroom

Lisa Comparini *Texas A & M University - Corpus Christi*
 Amy Brannon Anderson *Texas A & M University - Corpus Christi*
 Ashley D. Louie *Texas A & M University - Corpus Christi*
 Don Patrick Trahan *Texas A & M University - Corpus Christi*
 Cassandra K. Zinke *Texas A & M University - Corpus Christi*

29. Examining Parenting and Child-Rearing Attitudes of Adolescent Mothers

Valerie McGaha-Garnett

Oklahoma State University

Richard Calleja Zamora

Oklahoma State University

30. The Relationships among Family Function, School Life Adjustment and Depressive Mood

Shu-Hui Chang

Chung-Yuan Christian University

Mei-Chueh Huang

Chung-Yuan Elementary School

31. Mutual Influences in Marital Adjustment: Both Spouse's Attachment and Religious Commitment

Sara Pollard

University of North Texas

Shelley Riggs

University of North Texas

Jamie Haseley

University of North Texas

Bashir Abdullah

University of North Texas

Ryan Robinson

University of North Texas

SWPA: Conversation Hour-Rick Miller

Friday, 11:00 AM - 12:00 PM

Session: [42]

Room: Grand Ballroom E

SWPA Workshop: Using a Matrix to Teach Clinical or Counseling Psychology

Friday, 11:00 AM - 12:00 PM

Session: [43]

Chaired by: Mary Lynn Crow

Room: Preston Trail 1

Using a Matrix to Teach Clinical or Counseling Psychology

Mary Lynn Crow

University of Texas - Arlington

SAMR Talks: How to Make Statistics and Research Methods User Friendly

Friday, 11:00 AM - 12:30 PM

Session: [44]

Chaired by: Jodie Beeson and
Charles Burdsal

Room: Bent Tree 3

1. How Ready are Students for Graduate Statistics?

Charles A. Burdsal

Wichita State University

2. Teaching Introductory Statistic: What Works

Roger E. Kirk

Baylor University

3. Using Technology as a Partner in Teaching Statistics

Jodie G Beeson

Wichita State University

4. The Advantages of "Chalk and Talk"

James W. Grice

Oklahoma State University

5. Challenges of a Graduate Student Teaching Graduate Students

Felecia A Lee

Wichita State University

Marc Philip Frey

University of Windsor

Psi Chi Talks: Session 2

Friday, 11:00 AM - 12:30 PM

Chaired by: Evan Zucker

Session: [45]

Room: Mesquite 2

1. The Perception of Organic Labeling on Nutritional Content of Food

Katie Leigh Halbesleben

Oklahoma Baptist University

2. The Significance of Error Type in Text-Based Person Perception

John W. Harden

Stephen F. Austin State University

3. Does Inequality Cause Differences between Conservatives and Liberals in Happiness?

Wade Fuqua

University of Central Arkansas

4. Evaluative Organization of Self-Structure: Disadvantages of Compartmentalization

Patrick B Mayfield

University of Central Oklahoma

Alicia Limke

University of Central Oklahoma

Virgil Zeigler-Hill

University of Southern Mississippi

5. Influence of Accent, Voice Pitch, and Gender on Perceptions of Personality

Jeanette Marie Walters

Oklahoma Baptist University

6. Investigation of the Inter-Rater Reliability of the Military Academy Stance Test

Teresa P Perez

Our Lady of the Lake University

SWPA Symposium: Religious Belief and Torture Endorsement

Friday, 11:00 AM - 12:30 PM

Chaired by: Richard Beck

Session: [46]

Room: Bent Tree 1

God and Ticking Time Bombs: Religious Belief and Torture Endorsement

Richard A Beck

Abilene Christian University

SWPA Poster Session 6: Measurement, Industrial/Organizational, Experimental, SAMR

Friday, 12:30 PM - 2:00 PM

Session: [47]

Room: Salons A-D

1. Individual Difference and Item Characteristic Antecedents of Acquiescent Responding in Personality Assessment

John E Buckner

Louisiana Tech University

2. The Problem Solving Inventory: Three-Factor and Five-Factor Structures

Julie A. Osland

Wheeling Jesuit University

Alice P Carter

Louisiana Tech University

3. Traditional versus Non-traditional Undergraduate College Students: GPA and Other Differences

Gregory Wade Taylor

Southern Arkansas University

4. Facets of an Openness Scale for the California Psychological Inventory

Tim Kruse

Texas A & M University - Commerce

Charles William Keenan

Texas A & M University - Commerce

James R. Stacks

Texas A & M University - Commerce

5. Psychometric Properties of the Outcome Rating Scale in a Non-Clinical Population.

Danielle Smith	<i>University of Central Arkansas</i>
Laura Beth Crocker	<i>University of Central Arkansas</i>
Cathy Staton	<i>University of Central Arkansas</i>
Art Gillaspay	<i>University of Central Arkansas</i>
Shawn R Charlton	<i>University of Central Arkansas</i>

6. The Psychometric Properties of an Online Measure of Temporal Discounting

Kallie Wilson	<i>University of Central Arkansas</i>
Shawn R Charlton	<i>University of Central Arkansas</i>

7. Validation of the Cynical Attitudes toward Mathematics Scale-Revised

Alice P Carter	<i>Louisiana Tech University</i>
Julie A. Osland	<i>Wheeling Jesuit University</i>
Oscar David Carter	<i>Louisiana Tech University</i>

8. Age-Related Differences in Expectations of Wealth

Nancy S. Lamphere	<i>Texas A & M University - Commerce</i>
Danielle Simons	<i>Texas A & M University - Commerce</i>

9. Definition Deconstruction: The Results of Five Different Studies

Victoria Zascavage	<i>Xavier University</i>
--------------------	--------------------------

10. Fantasy and Fiction: Does Reading/Watching about Academic Dishonesty Predict Cheating?

Melinda Burgess	<i>Association for Psychological Science</i>
Jared F. Edwards	<i>Southwestern Oklahoma State University</i>

11. Overcoming Obstacles in Teaching Students How to Think Critically: An Instructional Intervention

Meredith L. McKee	<i>Washburn University</i>
Pamelyn M MacDonald	<i>Emporia State University</i>

12. Sexualized Portrayals of Female Singers and their Effect on Perceptions of Rape

Sandra Burpo	<i>Association for Psychological Science</i>
Melinda Burgess	<i>Association for Psychological Science</i>

13. The Effect of Music on an Individuals Emotion

Olajumoke Iyiola	<i>Stephen F. Austin State University</i>
Lisa D. Topp	<i>Stephen F. Austin State University</i>

14. A Correlation between Marriage Views

Melanie Leigh Neal	<i>University of Dallas</i>
--------------------	-----------------------------

15. Attachment Styles and Identity Status: An Experimental Study on College Students

Kristina Frassrand	<i>University of Dallas</i>
--------------------	-----------------------------

16. Does Rap Prime Rape? Music Videos and Perceptions of Sexual Violence

Caleb M Scoville	<i>Southwestern Oklahoma State University</i>
Sandra Burpo	<i>Association for Psychological Science</i>
Melinda Burgess	<i>Association for Psychological Science</i>

17. Opportunity Openers/Barriers : Elementary Educators Define Literacy for Students with SSPD

Victoria Zascavage	<i>Xavier University</i>
William G Masten	<i>Texas A & M University - Commerce</i>

18. Perceptions of Video Game Enjoyability for Males and Females of Different Ages

Natalie R James	<i>Southwestern Oklahoma State University</i>
Brittany Stewart	<i>Southwestern Oklahoma State University</i>
Caleb M Scoville	<i>Southwestern Oklahoma State University</i>
Melinda Burgess	<i>Association for Psychological Science</i>
Stephen Burgess	<i>Southwestern Oklahoma State University</i>

19. Smokers versus Nonsmokers: Differing Study Habits Based on Gender and GPA

Amanda Mebane	<i>University of Dallas</i>
---------------	-----------------------------

20. The Relationship between Mindfulness, Appreciation of Beauty and Subjective Well-Being

Traci Sandoval	<i>University of Texas - Dallas</i>
----------------	-------------------------------------

21. The Impact of a Wellness Program on Work Stress

Xi Lu	<i>SIOP</i>
George Yancey	<i>SIOP</i>

22. Examination of Locus of Control and Clientele-Building Activities

Trelitha R Bryant	<i>Behavioral Sciences Research Press</i>
George Dudley	<i>Behavioral Sciences Research Press</i>
Shannon L Goodson	<i>Behavioral Sciences Research Press</i>

23. What an Office Can Say: Perceptions Based on Office Conditions

Rebecca Mae Gilpin	<i>Texas A & M University - Corpus Christi</i>
Megan Michelle Manning	<i>Texas A & M University - Corpus Christi</i>
Brenda Isabel Ballesteros	<i>Texas A & M University - Commerce</i>
Persian Renee Perez	<i>Texas A & M University - Corpus Christi</i>
Steven D. Seidel	<i>Texas A & M University - Corpus Christi</i>

24. Effects of Adolescent Peer Relationships on Academic Performance

Lisette T Jacobson	<i>Wichita State University</i>
Charles A. Burdsal	<i>Wichita State University</i>

25. Do Your Questionnaires Measure Up? Questionnaire Design Influences Response Times and Responses.

Marc Philip Frey	<i>University of Windsor</i>
------------------	------------------------------

26. Examining the Flynn Effect in the Wechsler Intelligence Scale for Children

Alexander Beaujean	<i>Baylor University</i>
Yanyan Sheng	<i>Baylor University</i>
Xiao Qiu	<i>Baylor University</i>

27. The Development of the Self-Regulatory Academic and Dietary Cognition Scales.

Aaron T McLaughlin	<i>Abilene Christian University</i>
--------------------	-------------------------------------

28. Cognitive Epidemiology: The Influence of Personality and Cognitive Ability in Health Outcomes

Gregory S Ryan	<i>Baylor University</i>
Xiao Qiu	<i>Baylor University</i>
Alexander Beaujean	<i>Baylor University</i>

29. The Dynamic Analog Scale: A Means for Single Item Measurement of Personality

Erika Brown	<i>Oklahoma State University</i>
Scott Ihrig	<i>Oklahoma State University</i>
James W. Grice	<i>Oklahoma State University</i>

30. Is It Really Possible? Impact of Role Models on the Possible Self

Malika Moore

Samford University

SWPA: APA Harry Kirke Wolfe Lecture- David Thomas

Friday, 1:00 PM - 2:00 PM

Session: [48]

Chaired by: Lauren Scharff

Room: Grand Ballroom E

Psychology is a Science: Engaging Students in the Research Process

In part to address problems concerning the lay public's ignorance of the true nature of psychology as a scientific endeavor, the APA has included in its Guidelines for the Undergraduate Psychology Major a call not only to convey this knowledge base to students (Goal 1), but also to teach students to understand the methods we use to gain this knowledge (Goal 2) and to think critically and skeptically (Goal 3) about it. Thus one of my primary learning objectives in teaching psychology to undergraduates at any level is to provide the tools for understanding and evaluating that body of knowledge, as well as the representations of it and other scientific data in the popular media. This year's H.K. Wolfe Lecture will focus on a) teaching basic and advanced research designs through the use of news media, movie plots, and my own research in Ethiopia; b) active participation in the research process using computer-based experiments, public data bases, and untapped sources such as cemeteries and zoos; and c) helping students search for alternative explanations to foregone conclusions.

Will be followed by a conversation hour at 2:00 PM

Psi Chi: Panel-Advice to Students and Faculty from Journal Editors

Friday, 2:00 PM - 3:00 PM

Session: [49]

Chaired by: Randolph Smith and Martha Zlokovich

Room: Mesquite 2

SWPA: Conversation Hour- David Thomas

Friday, 2:00 PM - 3:00 PM

Session: [50]

Room: Grand Ballroom E

SWPA Symposium: Higher Education Challenges during Difficult Economic Times

Friday, 2:00 PM - 3:30 PM

Session: [51]

Chaired by: Peter Kranz

Room: Preston Trail 1

Challenges and Resilience in Higher Education during Difficult Economic Times

Peter L Kranz

University of Texas-Pan American

Cynthia Wimberly

University of Texas - Pan American

Darrin L Rogers

University of Texas - Pan American

Victoria Mosack

Wichita State University

Sylvia Z. Ramirez

University of Texas-Pan American

Anita Thompson

Northeastern State University

Sharon L Roberts

Northeastern State University

SWPA/TPA Talks: Social, Crime and Delinquency, Religion

Friday, 2:00 PM - 3:30 PM

Session: [52]

Chaired by: Jeremy Heider

Room: Bent Tree 2

1. Reducing Implicit Negativity Toward Gays and Lesbians

Jeremy D. Heider

Stephen F. Austin State University

2. The Investigation of Minority Group Influence and the Group Experience

Don Patrick Trahan

Texas A & M University - Corpus Christi

3. "Sometimes a Cigar is Just a Cigar": When Men's Minds Go South

Gracee Jean Trawick

Texas Lutheran University

4. Attachment and Intimate Partner Violence: Examining the Mediating Effect of Interpersonal Problems

David M. Lawson

Stephen F. Austin State University

Stevie Gail Malnar

Stephen F. Austin State University

5. Religiosity, Religious Experiences and Emotions

Justina DeLong

Henderson State University

Aneeq Ahmad

Henderson State University

6. Holland's Vocational Choice Theory, Psychologists, and Police Pre-employment Psychological Screening

M L Dantzker

University of Texas - Pan American

Louisiana State Representative Symposium

Friday, 2:00 PM - 3:30 PM

Session: [53]

Chaired by: Lawrence Dilks

Room: Salons G-H

The Changing Face of Applied Psychology

Professions are seldom static and are frequently in a state of flux with some subcomponents constricting and new realms of practice blossoming. Psychology is no exception and events over the last ten years have resulted in unprecedented changes. Some changes over the last decade have been so dramatic that the very definition of psychology may have to change. This symposium will consider the rapid changes taking place in applied psychology across the country along with the implications for the future.

Ashley N Carroll

Louisiana Tech University

Lawrence S Dilks

Counseling Services of Southwest Louisiana

Shelley Blancett

Fielding Graduate University

TPA CE Session: Fundamentals for a Successful and Ethical Psychology Practice

Friday, 2:00 PM - 5:00 PM

Session: [54]

Chaired by: Brian Stagner

Room: Addison Meeting Room

Fundamentals for a Successful and Ethical Psychology Practice

Brian H Stagner

Texas A & M University - College Station

SAMR: Business Meeting

Friday, 2:30 PM - 3:30 PM

Session: [55]

Chaired by: Dennis Jackson

Room: Bent Tree 3

Psi Chi Poster Session 2

Friday, 2:30 PM - 4:00 PM

Session: [56]

Chaired by: Shelia Kennison and Laura Crocker

Room: Salons A-D

1. An Investigation of National Prejudice Indicators and FBI Hate Crime Statistics

Norma A. Herrera

University of Texas - Pan American

2. Effects of Media Literacy on Weight Concern of Low Body Satisfaction Women

Tiffany Loggins

Stephen F. Austin State University

3. Fashion or Fluke: Stereotype Lift in the Homosexual Male Population

Chad Cotner

Oklahoma State University

4. Gender Stereotypes in Music Television: A Content Analysis

Adrian Campos Garcia

University of Saint Thomas

5. Influence of Prejudice and Perceived Organizational Discrimination on Job Satisfaction

Mario Antonio Navarro

University of St. Thomas

6. Levels of Homophobia Across College Students' Classifications and Genders

Addison Casey Duplechain	<i>McNeese State University</i>
Justin James Daigle	<i>McNeese State University</i>
Benjamin J Parker	<i>McNeese State University</i>

7. Moral Role Models: Impact and Influence on Youth Development

Alex Caitlin Elliott	<i>Kansas State University</i>
Jaree Danielle Basgall	<i>Kansas State University</i>
Brenda Lee McDaniel	<i>Kansas State University</i>

8. Positive Addiction in Running and Non-running Exercises

Adam J Williams	<i>Stephen F. Austin State University</i>
Melissa Diane Kavetski	<i>Stephen F. Austin State University</i>
Kellye Noel Beagle	<i>Stephen F. Austin State University</i>

9. Relationship of Infant Attachment Style Behaviors and Adulthood in Romantic Relationships

Eleasha Tatum	<i>Stephen F. Austin State University</i>
Lisa D. Topp	<i>Stephen F. Austin State University</i>

10. Situational Factors that Influence a Victim's Response Following an Affair

Nicole Entrekin	<i>Lamar University</i>
-----------------	-------------------------

11. Social Information Processing Model and Aggression in College Students

Melissa Diane Kavetski	<i>Stephen F. Austin State University</i>
Natalie Buuck	<i>Stephen F. Austin State University</i>
Eleasha Tatum	<i>Stephen F. Austin State University</i>
Andrew M Terranova	<i>Stephen F Austin State University</i>

12. The Effect of Media on Students' Perceptions of Autism

Julia Phillips	
Whitney Renae Biege	<i>Stephen F. Austin State University</i>
Brandi Marie Dyess	<i>Stephen F. Austin State University</i>

13. The Effects of Ethnicity and Religious Support on Attitudes toward Psychotherapy

Audi Shelaine Fauss-Everhart	<i>University of St. Thomas</i>
------------------------------	---------------------------------

14. The Effects of Parental Attachment and Extracurricular Activity on Youth Outcomes

Latoya Anthea Smart	<i>Prairie View A & M University</i>
---------------------	--

15. The Positive and Negative Compartmentalization Inventory (PNCI): Survey Alternative to Card Sorting

Patrick B Mayfield	<i>University of Central Oklahoma</i>
Alicia Limke	<i>University of Central Oklahoma</i>
Virgil Zeigler-Hill	<i>University of Southern Mississippi</i>

16. The Role of Pain Expression in the Search for Social Support

Victoria Todd	<i>Hendrix College</i>
Robert Hessling	<i>Hendrix College</i>

17. Tired of Being Blue: Effects of Relaxation Training on Anxiety And Depression.

Naomi Broadway	<i>St. Edward's University</i>
Helen D. Just	<i>St. Edward's University</i>

18. Undergraduates' Perceptions of Police Patrol Effects on Partying Behavior Off-Campus.

Marjorie Camille O'Connor	<i>University of Dallas</i>
---------------------------	-----------------------------

SWPA Presidential Address 2010: Scott A. Bailey

Friday, 3:30 PM - 4:30 PM

Session: [57]

Chaired by: Lauren Scharff

Room: Grand Ballrooms E & F

Deliberate Grist: Harvesting Grain for the Learning Mill

SWPA Presidential Address, 2010 Scott A. Bailey

Research suggests that with sufficient deliberate practice one can become proficient at nearly anything. Awareness of the tremendous potential for experience in honing capacity should shape how we approach scholarship. This talk will examine scientific data and anecdotal support of mechanisms that facilitate the development of capacities across a range of domains.

Dr. Scott Bailey is the Lillie Krause Professor of Social Science, and Chair of the Psychology Department at Texas Lutheran University. His research interests are in animal learning, behavioral neuroscience, and comparative psychology.

SWPA: Awards and Annual Members' Meeting

Friday, 4:30 PM - 5:30 PM

Session: [58]

Chaired by: Scott Bailey

Room: Grand Ballrooms E & F

Saturday – April 10, 2010

Psi Chi: Advisors' Breakfast

Saturday, 7:30 AM - 8:30 AM

Chaired by: Randall Osborne

Session: [59]

Room: Cafe Costa Restaurant and Bar

Breakfast will be held at the Cafe Costa Restaurant and Bar which is located in the convention hotel. Ask for the Psi Chi breakfast.

SWPA Poster Session 7: Social, Community

Saturday, 8:30 AM - 10:00 AM

Session: [60]

Room: Salons A-D

1. A “Face” in the Crowd: Differences in the Involvement of Facebook.Com

Doris Cecile Blanchard	<i>McNeese State University</i>
Kaston Dariel Anderson Jr	<i>McNeese State University</i>
Rachel Wright	<i>McNeese State University</i>
Chriscendia Winbush	<i>McNeese State University</i>

2. Abstinence Pledges in Relation to Extrinsic Motivation, Religiosity, and Risk-Taking Behaviors

Samantha Davids	<i>University of Dallas</i>
-----------------	-----------------------------

3. Conformity by Example or by Instruction

Rebecca Duran	<i>Texas Lutheran University</i>
Amanda Catherine Gilley	<i>Texas Lutheran University</i>
Yvette Angelica Martinez	<i>Texas Lutheran University</i>
Michael L. Czuchry	<i>Texas Lutheran University</i>

4. Does Happiness Predict Success within the On Campus and Online College Classrooms?

Anna Marie Evans	<i>University of the Incarnate Word</i>
James Justin Evans	<i>Northwest Vista College</i>
Candy Camargo	<i>Northwest Vista College</i>
Cameron Andrew Hunt	<i>Northwest Vista College</i>
Anthony Erick Sanchez	<i>Northwest Vista College</i>
Wendy Morgan Whipple	<i>University of Texas - Austin</i>
Don Lucas	<i>Northwest Vista College</i>

5. Expecting the Worst; Being Pleasantly Surprised: Predicting Defensive Pessimism with Relationship Variables

Amy K Dicke-Bohmann	<i>Texas A & M University-San Antonio</i>
---------------------	---

6. Feminine Flourishing: Gender and Mental Health

MaryLou Fair Worthen	<i>Amberton University</i>
----------------------	----------------------------

7. Gender, Patriotism, Optimism, and Olympic Viewing

Agustin Pablo Maggio	<i>University of Texas - San Antonio</i>
Mary Ellen McNaughton-Cassill	<i>University of Texas - San Antonio</i>
Michael R Baumann	<i>University of Texas - San Antonio</i>

8. Investigating Heterosexism: Harsh Judgments of Outgroup Sexual Behavior

Joy E. Reagan	<i>Texas Woman's University</i>
Melana Kasper	<i>Texas Woman's University</i>
Christian L. Hart	<i>Texas Woman's University</i>

9. Love and Money: Does Sharing Affect Desirability?

Jacqueline Davis	<i>Texas Woman's University</i>
Angela D. Manns	<i>Texas Woman's University</i>
Elizabeth Michelle Parker	<i>Texas Woman's University</i>
Crystal Tschirgi	<i>Texas Woman's University</i>
Christian L. Hart	<i>Texas Woman's University</i>

10. Meritocracy Priming and the Interpretation of Ambiguous Effort

Emily Lenard	<i>Hendrix College</i>
Leslie Wade Zorwick	<i>Hendrix College</i>

11. Mortality Salience and Political Ideology: Role of Implicit Self-esteem

Robert L Boughner	<i>Rogers State University</i>
Jessica A. Marchewka	<i>Rogers State University</i>
Andrea Marie Mundt	<i>Rogers State University</i>
Andrew Mylan Sanders	<i>Rogers State University</i>
Heidi Hills	<i>Rogers State University</i>
Tony Allen Goodell	<i>Rogers State University</i>

12. Personality Differences in Sport Fans

Jessica Curtis	<i>Oklahoma State University</i>
Shelia M Kennison	<i>Oklahoma State University</i>

13. Predicting Self-Reported Emotions and Behaviors with Interpersonal Expectancies

Elizabeth G. Shoemake	<i>University of Central Oklahoma</i>
Jamie L. Gill	<i>University of Central Oklahoma</i>
James M Rose	<i>University of Central Oklahoma</i>
Sean McMillan	<i>University of Central Oklahoma</i>
Robert D Mather	<i>University of Central Oklahoma</i>

14. Self-Compassion, Perceived Social Support, and Coping Styles among College Undergraduates

Jeannetta Williams	<i>St. Edwards University</i>
--------------------	-------------------------------

15. Sex Differences in Keeping Secrets in Close Relationships

Sarah Evans	<i>Texas A & M University - Corpus Christi</i>
Steven D. Seidel	<i>Texas A & M University - Corpus Christi</i>

16. Social Support and Relational Health Among Female McNair Scholars

Claudia Veronica Porras	<i>Oklahoma State University</i>
Eboney P Crawford	<i>Oklahoma State University</i>
Laura Briscoe	<i>Oklahoma State University</i>
Ilse Carrizales	<i>Oklahoma State University</i>
Andrea Zainab Omidy Nael	<i>Oklahoma State University</i>
Sue C Jacobs	<i>Oklahoma State University</i>
Valerie McGaha-Garnett	<i>Oklahoma State University</i>
Enedelia Saucedo	<i>University of Texas - San Antonio</i>

17. Subtle Prejudices: Spontaneous Reactions to Engaged Biracial Couples

Shantik A Taylor	<i>Texas Lutheran University</i>
Josh Haby	<i>Texas Lutheran University</i>
Enjoli D. Narvaez	<i>Texas Lutheran University</i>
Tiffany L. Sia	<i>Texas Lutheran University</i>
Michael L. Czuchry	<i>Texas Lutheran University</i>

18. The Effect of Racial Stereotypes on Aggression

Kendra Anderson	<i>Hendrix College</i>
Leslie Wade Zorwick	<i>Hendrix College</i>

19. The Effects of Gender on Perceptions of Prejudice towards Women

Blair Sanning	<i>Hendrix College</i>
Leslie Wade Zorwick	<i>Hendrix College</i>

20. The Relationship of Mindfulness to Social Attitudes

Richard Calleja Zamora	<i>Oklahoma State University</i>
Sue C Jacobs	<i>Oklahoma State University</i>
Anne Weese	<i>Oklahoma State University</i>
Julie Beth Swagerty	<i>Oklahoma State University</i>
Nathan D'Coby Richards	<i>Oklahoma State University</i>
Maria Howell	<i>Oklahoma State University</i>

21. Value and Attitude Similarity: A Meta-analytic Review of Predictors of Satisfaction

Jennifer G. Clement	<i>McNeese State University</i>
---------------------	---------------------------------

22. “When People Were Caucasians, I Didn’t even Think about their Ethnicity!”

Paul Thomas Eno	<i>Missouri State University</i>
Kyle Brandenburg	<i>Missouri State University</i>
Brittany Combs	<i>Missouri State University</i>
Harry L Hom, Jr.	<i>Missouri State University</i>
Jamila Wright	

23. Emotional Intelligence and Ethical Reasoning in Counseling Psychology Graduate Students

Tommie Hughes	<i>Texas A&M-Texarkana</i>
---------------	--------------------------------

24. Public Self-Awareness and Prosocial Behavior

Melanie Morse	<i>Hendrix College</i>
Leslie Wade Zorwick	<i>Hendrix College</i>

25. Reluctance to Dislike Others as We Age: Support for Socioemotional Selectivity Theory

Britania Latronica	<i>Wichita State University</i>
Cara Ernzen	<i>Wichita State University</i>
Louis J. Medvene	<i>Wichita State University</i>

26. Emotions and Emotion Regulation

Natalie Buuck	<i>Stephen F. Austin State University</i>
Andrew M Terranova	<i>Stephen F Austin State University</i>

27. Heroes and Villains: Empathy and Priming Effects on Concern for Film Characters

Gabriel Uhriah Slade	<i>Henderson State University</i>
Travis Langley	<i>Henderson State University</i>

28. Self-reported Discrimination in Cooperative Pharmacy Students

Peter L Kranz

University of Texas-Pan American

29. Predictors of Adaptive Functioning in Delinquent Teens

Salvatore Paul Carbonaro, Jr.

Fielding Graduate University

Lawrence S Dilks

Counseling Services of Southwest Louisiana

Ashley N Carroll

Louisiana Tech University

Janice C. Marceaux

Andrew Justin Thrasher

Fielding Graduate University

30. Certified Peer Specialist Programs in the USA: A comparison of 16 States

Emily Anne Grant

Wichita State University

31. The Effects of Actual and Perceived Attractiveness on Ratings of Multiple Attributes

Lora L Jacobi

Stephen F. Austin State University

Kellye Noel Beagle

Stephen F. Austin State University

SWPA Workshop: Academic Job Searches: Becoming Faculty Your First Time Out

Saturday, 8:30 AM - 10:00 AM

Session: [61]

Chaired by: Stefanie Boswell and Jeff Lawley

Room: Bent Tree 1

Demystifying Academic Job Searches: Becoming Faculty Your First Time Out

Stefanie Boswell

University of the Incarnate Word

Jeff Lawley

Louisiana State University - Shreveport

TPA CE Session: Autism Evaluations: Techniques for Interviewing Parents and Discussing the Diagnosis

Saturday, 8:30 AM - 10:30 AM

Session: [62]

Chaired by: Marilyn Monteiro

Room: Addison Meeting Room

Autism Evaluations: Techniques for Interviewing Parents and Discussing the Diagnosis

Marilyn J Monteiro

Private practice

TPA: Defending Psychology From The Criticism That Psychologists Are Anti-Science: A Conversation

Saturday, 9:00 AM - 10:00 AM

Session: [63]

Chaired by: Brian Stagner

Room: Bent Tree 3

Defending Psychology From The Criticism That Psychologists Are Anti-Science: A Conversation

Brian H Stagner

Texas A & M University - College Station

Psi Chi: Panel-Top 10 Questions About Graduate School

Saturday, 9:00 AM - 10:00 AM

Session: [64]

Chaired by: Laura Crocker

Room: Mesquite 2

SWPA Talks: Cognition/Memory

Saturday, 9:00 AM - 10:30 AM

Session: [65]

Chaired by: Michael Serra

Room: Bent Tree 1

1. Decomposing the Memory for Past Test Heuristic in the Underconfidence-with-Practice Effect

Benjamin D. England

Texas Tech University

Michael J. Serra

Texas Tech University

2. Measuring Intelligence Using the Draw-a-Person Intelligence Test

Charlene Emily Shunick

University of Louisiana - Lafayette

Rami Ann LeBlanc

University of Louisiana - Lafayette

3. Resistance to Visual Capture Varies with Individual Differences in Working Memory Capacity

Bradley D. Gossett

University of Central Arkansas

Ken Sobel

University of Central Arkansas

4. Working Memory: A Comparison of Different Irrelevant Background Sounds

Shannon Wittig

Henderson State University

Aneeq Ahmad

Henderson State University

5. Analyses of Error Types in Multitrial Learning Tasks

Lacy Elise Krueger

Texas A & M University - Commerce

6. Foraging Memory: Producing Words from One and From Two Semantic Categories

Daniel Shields Glaser

Rice University

Psi Chi: Conversation Hour-Graduate School Questions

Saturday, 10:00 AM - 11:00 AM

Session: [66]

Room: Mesquite 1

SCPA: Talks 3

Saturday, 10:00 AM - 11:30 AM

Session: [67]

Chaired by: Scott Coleman

Room: Salons G-H

1. Parent-Offspring Kin Recognition in Japanese Quail

Emily Gregory

Centre College

Melissa Burns-Cusato

Centre College

2. Effects of Transport on Behavioral and Physiological Parameters in Nonhuman Primates

Steven J Schapiro

University of Texas M.D. Anderson Cancer Center

Lawrence Williams

University of Texas - M.D. Anderson Cancer Center

3. Managing Diabetic Chimpanzees Using Positive Reinforcement Techniques

Rachel L. Malling

University of Texas M.D. Anderson Cancer Center

Erica Thiele

University of Texas M.D. Anderson Cancer Center

Lisa Reamer

University of Texas M.D. Anderson Cancer Center

Susan Pavonetti

University of Texas M.D. Anderson Cancer Center

Steven J Schapiro

University of Texas M.D. Anderson Cancer Center

4. Relocation Stress Affects Immunological and Physiological Parameters in Squirrel and Owl Monkeys

Lawrence Williams

University of Texas - M.D. Anderson Cancer Center

Steven J Schapiro

University of Texas M.D. Anderson Cancer Center

5. A Comparison of Brain to Body Weight Ratios in Birds of Prey

Scott Coleman

University of Texas - Arlington

SWPA/APA: How to Publish Your Manuscript

Saturday, 10:30 AM - 11:30 AM

Session: [68]

Room: Preston Trail 2 and 3

APA Panel: How to Publish Your Manuscript

Jeff Hume-Pratuch

APA Journals

Stephen F. Davis

SWPA Past President

Randolph A. Smith

Lamar University

SWPA Poster Session 8: Clinical/Counseling, Addictive Behavior, Death Studies, Depression/Suicide

Saturday, 10:30 AM - 12:00 PM

Session: [69]

Room: Salons A-D

1. Does an Image Moderate the Stigmatization of Bulimia Nervosa?

Paula J Varnado-Sullivan

Southeastern Louisiana University

Nina Grubisic

Southeastern Louisiana University

Stephanie Joffrion

Southeastern Louisiana University

2. Effects of Number of Traumatic Experiences on Emotion Regulation

Monica Rhodes

Stephen F. Austin State University

3. Factor Structure of the COGNISTAT in an In-Patient Geropsychiatric Sample

Kevin Rowell

University of Central Arkansas

4. Male Body Image Concerns

Sheryl Miller

Texas A & M University Kingsville

Donald W. Daughtry

Texas A & M University - Kingsville

5. Peer Attachment Security and Eating Disorder Problem Dimensions Among College Women

Kelsey Horick

Southwestern University

Bryan D Neighbors

Southwestern University

6. Sleep Quality and Type A-B Personality

Abbey Gail White

Louisiana Tech University

Walter Buboltz

Louisiana Tech University

Rebecca Hoffmann

Louisiana Tech University

Stephen Tyler Shockey

Louisiana Tech University

Barbara Duff Calvert

Louisiana Tech University

7. The Effect of Failure on Paranoid Ideation and Self-Esteem

Dennis R. Combs

American Psychological Association

8. Undergraduates' Experiences of Sexist Events And Anticipated Impact on Their Future Careers

Frances Haemmerlie Montgomery

University of Missouri - Rolla

Courtney Erin Hubbs

American Educational Research Association

9. Coping Styles of Emergency Medical Technicians

Theresa A. Wozencraft

University of Louisiana-Lafayette

Brenton Ray Abadie

University of Louisiana - Lafayette

10. Eating Disorders in Academia: A Study Between a Public and Private Institution

Fredrik Persson

Lipscomb University

11. Employment Attitudes of Graduating College Students

Femina P. Varghese

University of Central Arkansas

12. Factors Associated with Body Image and Body Image Self-Consciousness in College Women

Carrie Winterowd

APA

Meladee LaNay Garst

Oklahoma State University

Lindsay Murn

Oklahoma State University

Robert Sean Bannon

APA

Marisa M Moore

APA

13. Media Image Influence on Body Esteem and Comparison of Self to Others.

Lindsay Murn

Oklahoma State University

Julie Dorton Clark

Oklahoma State University

Marisa M Moore

APA

14. Psychological Responses to News Media Coverage of Hurricane Ike

Mary Ellen McNaughton-Cassill

University of Texas at San Antonio

Jo A Meier-Marquis

University of St. Thomas

15. Social Cognition as a Predictor of Social Functioning in Schizophrenia

Dennis R. Combs

American Psychological Association

16. The Impact of Parenting Styles on Career Exploration

Jeanette Edmonds Ellis

Louisiana Tech University

Walter Buboltz

Louisiana Tech University

17. Understanding Infant Psychopathology: An Examination of Infant-Caregiver Relationships, Psychopathology, and Psychosocial Stressors

Katie M Holm

Emporia State University

Megan Koranda

Emporia State University

Satoko Hoshino

Emporia State University

Pamelyn M MacDonald

Emporia State University

18. Acculturation Predicts Drinking Behavior of Mexican American College Students

Roberto Reguenes

University of Texas - Brownsville

Jared A. Montoya

University of Texas at Brownsville

19. Gender Differences for Negative Alcohol Consequences in Specific Areas of Functioning

Anya Janice Lopez-Fuentes

Southwestern University

Bryan D Neighbors

Southwestern University

20. Menthol Cigarette Purchases by Race and Gender

Luis Hernandez

University of Dallas

21. Perceived Norms and their Impact on Alcohol, Tobacco, and Controlled Substance Use.

Brian M Bramstedt	<i>University of Louisiana-Monroe</i>
Donald Harris	<i>University of Louisiana-Monroe</i>
Taylor Diaz	<i>University of Louisiana-Monroe</i>

22. The Relationship between Current Alcohol Use, First Age of Use, and Self-Harm

Jessica Connie Gonzalez	<i>University of Texas - Pan American</i>
Celeste Adriana Velazquez	<i>University of Texas - Pan American</i>
Kristin L. Croyle	<i>University of Texas - Pan American</i>

23. A New High: A Qualitative Examination of Teenage Prescription Drug Abuse

Ingeborg Marie Saenz	<i>University of Dallas</i>
----------------------	-----------------------------

24. Anxiety as a Factor in Gambling Treatment Continuity

Sonia M Clark	<i>McNeese State University</i>
Cameron L Melville	<i>McNeese State University</i>

25. Impact of ADHD on Internet Addiction among College Students

Benjamin Nicholson	<i>University of Louisiana-Monroe</i>
Veronica E. Lewis	<i>University of Louisiana-Monroe</i>
B. Jean Cottingham, Ph.D.	<i>University of Louisiana-Monroe</i>
Bill McCown	<i>University of Louisiana - Monroe</i>

26. Methamphetamine Use: Evaluation of a Predictive Model Based upon Gateway Hypothesis

Elizabeth K Hood	<i>University of Central Arkansas</i>
James Lee Hopper	<i>University of Central Arkansas</i>
Danielle Smith	<i>University of Central Arkansas</i>
LaShondra Simone Collins	<i>University of Central Arkansas</i>

27. Substance Use and Schizophrenia

Lorissa Kay Luna	<i>Texas A & M University - Kingsville</i>
Laura Cruz Garza	<i>Texas A & M University - Kingsville</i>

28. Views of Death and Dying

Ella Zavala	<i>Texas A & M University - Kingsville</i>
Laura Cruz Garza	<i>Texas A & M University - Kingsville</i>

29. Dreams, Spiritual Struggles and Personal Meaning Derived in Suicide Bereavement

Brandy Michelle Watson	<i>Texas A & M University - College Station</i>
Donald W. Daughtry	<i>Texas A & M University - Kingsville</i>

SWPA Talks: Social

Saturday, 10:30 AM - 12:00 PM

Session: [70]

Chaired by: Leslie Zorwick

Room: Bent Tree 2

1. Working Relationships in Legal Settings: The Role of Status, Warmth, and Competence

Leslie Wade Zorwick	<i>Hendrix College</i>
---------------------	------------------------

2. Phrasing and Sequencing Questions to Foster Honest Responses in Potential Jurors

Haley M Siler	<i>Centre College</i>
---------------	-----------------------

3. The Influence of Demographics on Exhibited Greeting Customs

Matt Peisen	<i>University of Dallas</i>
-------------	-----------------------------

4. Does Hindsight Bias Perpetuate Stereotyping Behaviors?

Morgan Grotewiel	<i>Missouri State University</i>
Nicole Brenner	
Harry L Hom, Jr.	<i>Missouri State University</i>
Scott E Parrigon	<i>Baldwin-Wallace College</i>

5. College Students' Prejudicial Biases Against Instructors Who Smoke Cigarettes

Crystal D Oberle	<i>Texas State University - San Marcos</i>
Rachel M. Vogel	<i>Texas State University - San Marcos</i>

6. Perceived Notions on Personal Relationship with People with Disabilities

Bethany Baldwin	<i>Henderson State University</i>
Aneeq Ahmad	<i>Henderson State University</i>

Psi Chi: Conversation Hour-Psi Chi National President – Dr. Alvin Wang

Saturday, 11:00 AM - 12:00 PM

Session: [71]
Room: Mesquite 1

SWPA CE Session: Diagnosis Mental Disorders

Saturday, 11:00 AM - 12:30 PM

Chaired by: Lawrence Dilks

Session: [72]
Room: Addison Meeting Room

Differential Diagnosis of Mental Disorders

Lawrence S Dilks	<i>Counseling Services of Southwest Louisiana</i>
Ashley N Carroll	<i>Louisiana Tech University</i>

SCPA Business Meeting

Saturday, 12:00 PM - 1:00 PM

Chaired by: Scott Coleman

Session: [73]
Room: Salons G-H

SWTOP Business Meeting

Saturday, 12:00 PM - 1:00 PM

Chaired by: Marcel Kerr

Session: [74]
Room: Preston Trail 2 and 3

Psi Chi: Distinguished Speaker: William Swann

University of Texas - Austin

Saturday, 1:00 PM - 2:00 PM

Session: [75]

Chaired by: Randall Osborne

Room: Grand Ballroom E

Fighting, Dying and Killing for One's Group: Nature and Consequences of Identity Fusion

Whereas most people draw a sharp division between their personal selves and the groups of which they are members, some people feel that their personal and group identities are fused. When people's personal and social selves become fused, they perceive the two to be functionally equivalent. As a result, they express willingness to engage in extraordinary behaviors in the service of their group membership, such as fighting, dying for the group, or even killing for the group. In one study, for example, persons who were fused with Spain endorsed plunging to their deaths in front of a speeding trolley to save the lives of fellow Spaniards. The nature and implications of identity fusion will be discussed.

Will be followed by a conversation hour at 2:00 PM

SWPA Workshop: Three Stage Memory: Using What You Know to Teach

Saturday, 1:00 PM - 2:00 PM

Session: [76]

Chaired by: Stefanie Boswell

Room: Preston Trail 1

Three-Stage Memory: Using What You Teach to Improve How You Teach

Stefanie Boswell

University of the Incarnate Word

Jeff Lawley

Louisiana State University - Shreveport

SWPA Symposium: Resiliency: Trait or Learned Behavior

Saturday, 1:00 PM - 2:00 PM

Session: [77]

Chaired by: Kimberly Rynearson and Marcel Kerr

Room: Bent Tree 2

Resiliency: Trait or Learned Behavior

Kimberly Rynearson

Tarleton State University

Marcel Satsky Kerr

Texas Wesleyan University

SWPA/TPA CE Session: Injured Soldiers in Transition

Saturday, 1:30 PM - 3:30 PM

Session: [78]

Chaired by: Todd Ryska

Room: Addison Meeting Room

Lessons Learned in Helping Soldiers Transition from Injury to New Possibilities

Todd Ryska

Army Center for Enhanced Performance, Ft. Hood, TX

Psi Chi: Conversation Hour with William Swann

Saturday, 2:00 PM - 3:00 PM

Session: [79]

Room: Mesquite 1

Psi Chi: Awards Ceremony

Saturday, 3:00 PM - 4:00 PM

Chaired by: Randall Osborne

Session: [80]

Room: Mesquite 2

AUTHOR INDEX

Please note that these are session numbers and not page numbers

Author Name	Session	Author Name	Session
Abadie, Brenton Ray	[15] [69]	Benzschawel, James Keith	[2]
Abbott, Hannah	[3]	Bhakta, Kruti Anil	[2]
Abdullah, Bashir	[10] [41]	Biege, Whitney Renae	[56]
Ahmad, Aneeq	[33] [52] [65] [70]	Bihm, Elson M.	[15]
Akin, Shannon	[18]	Billig, Ashley K.	[4]
Allen, Brian M	[32]	Bilyk, Nicholas	[31]
Allen, Jacquelyn Louise	[17]	Bishop, Molly	[33]
Amonette, Amber D	[23]	Blancett, Shelley	[2] [41] [53]
Anderson, Amy Brannon	[41]	Blanchard, Doris Cecile	[60]
Anderson, Kendra	[60]	Blue, Kristina Renee	[23]
Anderson, Meagan J	[2] [41]	Bollich, Kathryn L	[23]
Anderson Jr, Kaston Dariel	[41] [60]	Bolton, Jessica L	[21] [38]
Aoyama, Ikuko	[15]	Bond, Zachary J.	[23]
Archer, Richard L.	[33]	Bondurant, Leigh Lorraine	[33]
Arevalo, Daniel Alberto	[4]	Borden, Carol	[41]
Asbury, Edward T	[18]	Boswell, Stefanie	[61] [76]
Aubuchon-Endsley, Nicki Lynn	[41]	Boughner, Robert L	[10] [60]
Auer, Brandon J.	[33]	Bourgeois, Anthony E.	[2]
Bacani, Jennifer W	[41]	Bradley, Gia Marie	[33]
Badzinski, Stefanie I	[10]	Bradley, Kristopher I.	[15] [33]
Bailey, Scott A	[9] [18] [21] [58]	Bradley, Sabrina	[4]
Baldwin, Bethany	[70]	Bramstedt, Brian M	[69]
Ball, Sarah Marie	[10]	Brandenburg, Kyle	[60]
Ball, Steven Edward	[18]	Brannon, Linda	[41]
Ballesteros, Brenda Isabel	[47]	Brenner, Nicole	[70]
Bannon, Robert Sean	[69]	Briscoe, Laura	[60]
Barnes, Rebecca B	[32]	Broadway, Naomi	[41] [56]
Barnett, Amy L.	[33]	Brooks, Troy	[8]
Barnett, John R.	[33]	Brooks-Harris, Jeff E	[19]
Barrett, Aimee J	[16]	Brouillard, Pamela	[4]
Barrett, Tasia Sharanne	[24]	Broussard, Brian G	[23]
Basgall, Jaree Danielle	[15] [23] [56]	Brown, Ashlie	[15]
Baumann, Michael R	[60]	Brown, Elise	[4]
Bautista, Jesus	[2]	Brown, Erika	[47]
Beagle, Kellye Noel	[56] [60]	Bryant, Trelitha R	[47]
Bean, Maggie	[10] [41]	Buboltz, Walter	[10] [69]
Beaujean, Alexander	[10] [47]	Buckner, John E	[47]
Beck, Richard A	[46]	Bullard, Tiffany Kaye	[23]
Beeson, Jodie G	[44]	Burdsal, Charles A.	[44] [47]
Beiting, Magdalen Ann	[2]	Burgess, Melinda	[15] [41] [47]
Benson, Camille Hannah	[19]	Burgess, Stephen	[15] [41] [47]

Author Name	Session	Author Name	Session
Burkett, Amanda Lee	[23]	Cottingham, Ph.D., B. Jean	[69]
Burkett, Brittany C.	[2]	Countryman, Renee A	[41]
Burns-Cusato, Melissa	[21] [67]	Covington, Jennifer Ann	[33]
Burpo, Sandra	[47]	Cowan, Laura Katherine	[33]
Burrows, Stephanie	[33]	Crawford, Eboney P	[60]
Burt, Tracie D.	[15]	Crocker, Laura Beth	[6] [22] [23] [47] [56] [64]
Busbee, Lewis Gene	[41]	Crow, Mary Lynn	[43]
Butler, Heather M	[23]	Croyle, Kristin L.	[41] [69]
Butterbaugh, Tasha	[41]	Crunkleton, Joshua H	[3]
Buuck, Natalie	[56] [60]	Cunningham, Alec	[10]
Byrd-Craven, Jennifer	[33]	Curtis, Drew A.	[33]
Cacici, Jordan	[41]	Curtis, Jessica	[15] [60]
Cagle, Felecia Kristina	[24]	Cusato, Brian	[21] [38]
Calvert, Barbara Duff	[10] [31] [69]	Czuchry, Michael L.	[2] [33] [34] [60]
Camargo, Candy	[60]	Daigle, Justin James	[23] [56]
Cameron, Brad	[17]	Dantzker, M L	[52]
Carbonaro, Jr., Salvatore Paul	[2] [41] [60]	Daughtry, Donald W.	[69]
Carlson, Curt A.	[2]	Davids, Samantha	[60]
Carlston, David L	[18] [32]	Davis, Jacqueline	[60]
Carnes, Caitlyn L	[2] [41]	Davis, Jayla Jorene	[4]
Carpenter, Christina N	[32]	Davis, Lindsey	[5]
Carrizales, Ilse	[60]	Davis, Stephen F.	[68]
Carroll, Ashley N	[2] [15] [41] [53] [60] [72]	DeLong, Justina	[52]
Carter, Alice P	[15] [47]	Demir, Meliksah	[10] [24] [35]
Carter, Oscar David	[47]	Desmond, Paula A	[2] [41]
Cascio, Jessica	[31]	Diaz, Taylor	[69]
Caudle, Julie Angelica	[10]	Dicke-Bohmann, Amy K	[32] [60]
Chacon, Jasmin Daniela	[32]	Dickerson, April M	[33]
Champagne, Monique	[33]	Dickson, Jubilee	[4]
Chang, Shu-Hui	[41]	Diekhoff, George M.	[15]
Charlton, Shawn R	[33] [47]	Dilks, Lawrence S	[2] [41] [53] [60] [72]
Chauvin, Ida	[15]	Dixon, Stephanie	[15]
Chong, Ming Mun	[41]	Dolan, Elaine	[41]
Christensen, Chrisanne	[15]	Dubroc, Michelle Elise	[34]
Clark, Julie Dorton	[10] [69]	Dudley, George	[47]
Clark, Sonia M	[69]	Dudney, L. Dakota	[10]
Clement, Jennifer G.	[60]	Duplechain, Addison Casey	[56]
Clements, Douglas M	[38]	Duran, Rebecca	[60]
Colby, M. Amanda Earl	[2]	Dyess, Brandi Marie	[56]
Coleman, Scott	[21] [38] [67] [73]	Eason, E. Allen	[15]
Collins, LaShondra Simone	[2] [69]	Edgin, Greg W	[23]
Combs, Brittany	[60]	Edwards, Jared F.	[15] [47]
Combs, Dennis R.	[69]	Edwards, Jorie Hitch	[15]
Comparini, Lisa	[41]	Edwards, Melissa L.	[2]
Cooper, Brenton G.	[41]	Einsel, Kurt Wayne	[23]
Cornish, Samuel Warfield	[2] [41]	Elliott, Alex Caitlin	[15] [23] [56]
Cotner, Chad	[56]	Ellis, Jeanette Edmonds	[69]

Author Name	Session	Author Name	Session
Ellis, Kyla	[2]	Green, Jacintha	[10]
England, Benjamin D.	[27] [65]	Green, Melanie	[34]
English, Amy	[4]	Gregory, Emily	[67]
Eno, Paul Thomas	[60]	Gresham, Robert Michael	[4]
Entrekin, Nicole	[56]	Grice, James W.	[2] [10] [20] [44] [47]
Ernzen, Cara	[60]	Griffin, I'geal Che'rie	[33]
Eslava, Leslie Karen	[15]	Grimm, Jessica	[2]
Evans, Anna Marie	[60]	Gros, Brad	[23]
Evans, James Justin	[60]	Gross, Susan Marie	[4]
Evans, Sarah	[10] [41] [60]	Grotewiel, Morgan	[70]
Fahey, Lynn Marie	[41]	Grubisic, Nina	[69]
Farago, Flora	[41]	Guarraci, Fay	[21] [38]
Fauss-Everhart, Audi Shelaine	[56]	Guerra, Ruby Leah	[2]
Ferrell, Jason D.	[18]	Haby, Josh	[2] [33] [60]
Fischer, Leslie Elizabeth	[34]	Halbesleben, Katie Leigh	[45]
Fitzpatrick, Jacki	[35]	Hall, Alexander S.	[38]
Folensbee, Rowland W.	[39]	Hall, Buffy Ann	[14]
Ford, Brittany Joyce	[21] [38]	Hall, Caroline Cordero	[2]
Frassrand, Kristina	[47]	Hall, John P.	[36]
Frey, Marc Philip	[44] [47]	Harden, John W.	[45]
Fritz, Sarah	[41]	Harman, Marsha J	[41]
Froese, Arnold D	[3] [32] [40]	Harper, Tracy	[15]
Frohardt, Russell	[38]	Harrington, Rick	[15]
Fuqua, Wade	[45]	Harris, Donald	[69]
Garcia, Adrian Campos	[2] [56]	Harris, Joseph	[33]
Garst, Meladee LaNay	[10] [69]	Harrison, Lauren	[41]
Garza, Gilbert J.	[15] [33]	Hart, Christian L.	[33] [60]
Garza, Laura Cruz	[69]	Hartlaub, Mark G.	[10]
George, Christina	[10]	Harwell, Paul B	[17]
Gill, Jamie L.	[60]	Haseley, Jamie	[41]
Gilland, Lauren L	[2]	Hastings, Kristin	[33]
Gillaspy, Art	[47]	Hawthorne, Melissa	[15]
Gilley, Amanda Catherine	[60]	Haycox, Charles	[38]
Gilpin, Rebecca Mae	[47]	Haymon, Porshia Lynette	[5]
Giuliano, Traci A	[23]	Heider, Jeremy D.	[52]
Glaser, Daniel Shields	[34] [65]	Heinrich, Kristi Marie	[33]
Glueck, Amanda	[21]	Henard, Tessa	[41]
Gonzalez, Jessica Connie	[41] [69]	Henley, Tracy B	[2] [18]
Gonzalez, Jorge	[41]	Hernandez, Cristal Mercedes	[21]
Goodell, Tony Allen	[60]	Hernandez, Luis	[69]
Goodson, Shannon L	[47]	Herrera, Norma A.	[56]
Gossett, Bradley D.	[3] [65]	Hessling, Robert	[41] [56]
Graham, Loranel M	[10]	Hills, Heidi	[60]
Grant, Emily Anne	[60]	Hobson, Valerie	[2] [10] [41]
Grant, Monique Sharyn	[23]	Hoffmann, Catherine Ruth	[2]
Grant, Stephanie Lea	[41]	Hoffmann, Rebecca	[31] [69]
Graver, Cleve Alexander	[3] [35]	Hogan, Julia M	[15]

Author Name	Session	Author Name	Session
Hoggard, Kalyn Paul	[23]	Kerr, Marcel Satsky	[32] [74] [77]
Holm, Katie M	[69]	Kimble, Tracy Michelle	[33]
Holub, Shayla C	[41]	Kincheloe, Matthew T	[15]
Hom, Jr., Harry L	[2] [60] [70]	King, Ashley Early	[5]
Honey, Tosha Marie	[17]	Kirk, Roger E.	[44]
Hood, Elizabeth K	[69]	Koranda, Megan	[69]
Hopper, James Lee	[15] [69]	Kranz, Peter L.	[51] [60]
Horick, Kelsey	[69]	Krings, Zach	[24]
Hoshino, Satoko	[69]	Krueger, Lacy Elise	[65]
Houlihan, Amy	[41]	Kruse, Tim	[47]
Howell, Maria	[10] [33] [60]	Laas, Whitney L.	[23]
Huang, Mei-Chueh	[41]	Lack, Caleb W	[10] [15]
Hubbs, Courtney Erin	[69]	Lammers, Bill J.	[10]
Hudson, Keith	[5] [33]	Lamphere, Nancy S.	[47]
hudson, shane I	[2]	Landrum, Brittany	[15] [33]
Huerta, Deborah Kay	[10]	Lane, David	[34]
Hughes, Lisa	[10]	Langley, Travis	[60]
Hughes, Tommie	[33] [60]	Latronica, Britania	[60]
Hume-Pratuch, Jeff	[68]	Lawley, Jeff	[61] [76]
Hunt, Cameron Andrew	[60]	Lawson, David M.	[52]
Hunter, Susanna R.	[33]	Leal, Lucila	[15]
Hynan, Linda S	[20]	LeBlanc, Rami Ann	[65]
Ihrig, Scott	[47]	Lee, Felecia A	[44]
Inman, Denyse Ariana	[32]	Lee, Kathryn	[29]
Iyiola, Olajumoke	[47]	Leihsing, Kyle Austin	[34]
Jackson, Dennis L	[55]	Leist-Haynes, Stacey	[5]
Jackson, Janeé	[2]	Lenard, Emily	[60]
Jacobi, Lora L	[32] [60]	LeUnes, Arnold Dallas	[2]
Jacobs, Sue C	[10] [33] [60]	Levermore, Monique	[13]
Jacobson, Lisette T	[47]	Lewis, Veronica E.	[69]
James, Natalie R	[33] [41] [47]	Leyton, James	[15]
Jiang, Mei	[15]	Li-Barber, Kirsten	[34]
Jimenez, Carmen	[2]	Liegey Dougall, Angela	[2]
Joffrion, Stephanie	[69]	Liles, Alesa	[14]
Johnson, Kevin	[14]	Limke, Alicia	[18] [45] [56]
Johnson, Leigh	[2] [10]	Livingston, Mary M	[10] [15]
Johnson, Matthew C.	[10]	Lockhart, Lisa K.	[15]
Jones, Beth A.	[24]	Loffredo, Donald A.	[15]
Jones-Wiley, D Gabrielle	[5]	Loggins, Tiffany	[56]
Just, Helen D.	[2] [41] [56]	Long, Elizabeth	[33]
Kalbfleisch, Layne	[2]	Longoria, Adelina	[16]
Kardas, Edward P.	[15]	Lopez-Fuentes, Anya Janice	[69]
Kasper, Melana	[60]	Loris, Colin	[41]
Kavetski, Melissa Diane	[56]	Loughan, Ashlee Ruth	[2]
Kazyak, Paul	[2]	Louie, Ashley D.	[2] [10] [41]
Keenan, Charles William	[18] [47]	Lovett, David	[33]
Kennison, Shelia M	[11] [15] [33] [56] [60]	Lowery, Bryan	[2]

Author Name	Session	Author Name	Session
Lowry, Allison	[34]	Mitchell, Jo A.	[15]
Lu, Shulan	[2]	Moiger, Sasha	[41]
Lu, Xi	[47]	Mollen, Debra	[26]
Lucas, Don	[60]	Monteiro, Marilyn J	[62]
Luna, Lorissa Kay	[69]	Montgomery, Frances Haemmerlie	[10] [26] [69]
MacDonald, Pamelyn M	[47] [69]	Montgomery, Robert L.	[10]
Madewell, Amy Nicole	[10] [16]	Montgomery, William A	[15]
Maggio, Agustin Pablo	[60]	Montoya, Jared A.	[69]
Malling, Rachel L.	[67]	Moore, Bethany	[41]
Malnar, Stevie Gail	[52]	Moore, Malika	[47]
Manning, Megan Michelle	[47]	Moore, Marisa M	[69]
Manns, Angela D.	[60]	Mootz, Jennifer	[26]
Marceaux, Janice C.	[2] [41] [60]	Morse, Melanie	[33] [60]
Marchewka, Jessica A.	[10] [60]	Mosack, Victoria	[51]
Margulieux, Lauren E	[23]	Mosier, Beatrice Charmaine	[15]
Maril, Virginia	[26]	Motes, Michael Allen	[2] [34]
Marsden, TroyMichael E	[15]	Mundahl, Brenda	[15]
Marsh, Crystale Michelle	[15]	Mundt, Andrea Marie	[60]
Martinez, Jennifer	[2]	Murn, Lindsay	[69]
Martinez, Yvette Angelica	[60]	Nael, Andrea Zainab Omidy	[60]
Marum, Kendra Patrice	[35]	Nail, Paul R.	[33]
Masten, William G	[47]	Narvaez, Enjoli D.	[60]
Mather, Robert D	[60]	Navarro, Mario Antonio	[56]
Mathew, Merly	[15]	Neal, Melanie Leigh	[47]
Mathis, Stacy Ellane	[23]	Neighbors, Bryan D	[69]
Matzenbacher, Dena L	[41]	Nguyen, Nga T.	[15]
Mayfield, Patrick B	[45] [56]	Nicholson, Benjamin	[69]
Maynard, Mark Eugene	[38]	Nissley, Gerald Edward	[18]
McCallum, Ravin	[2]	Novier, Adelle Katheryne	[21]
McCown, Bill	[69]	O'Bryant, Sid E	[2] [10] [41]
McDaniel, Brenda Lee	[15] [23] [56]	O'Connor, Marjorie Camille	[2] [56]
McGaha-Garnett, Valerie	[41] [60]	Oberle, Crystal D	[15] [70]
McKee, Meredith L.	[47]	Oehlke, Melissa	[41]
McLaughlin, Aaron T	[47]	Ogletree, Shirley M.	[33]
McMillan, Sean	[60]	Osborne, Randall E.	[6] [17] [59] [75] [80]
McNaughton-Cassill, Mary Ellen	[60] [69]	Osburn, David M.	[33]
Mebane, Amanda	[47]	Osland, Julie A.	[15] [47]
Medvene, Louis J.	[60]	Pang, Katherine L	[33]
Mehringer, Andrea Jane	[32]	Papini, Mauricio R.	[38]
Meier, Stacey	[10]	Parham, Krystal	[18]
Meier-Marquis, Jo A	[69]	Parker, Benjamin J	[23] [56]
Melville, Cameron L	[23] [69]	Parker, Elizabeth Michelle	[60]
Mesidor, Jean Kesnold	[5]	Parker, Jessica S	[16]
Meyers, Michael C.	[2]	Parrigon, Scott E	[70]
Miller, Rick	[40]	Patel, Sanobar L.	[41]
Miller, Sheryl	[69]	Patton, Elizabeth	[33]
Mingle, Morgan Elizabeth	[21] [38]	Paul, Ron	[26]

Author Name	Session	Author Name	Session
Pavonetti, Susan	[67]	Rogers, Darrin L	[51]
Peisen, Matt	[70]	Ropp, Jeffrey	[32]
Perez, Persian Renee	[47]	Roring, Steven	[15]
Perez, Teresa P	[45]	Rose, James M	[60]
Perkins, Christina M.	[7]	Rowell, Kevin	[2] [69]
Perkins, Scott	[7]	Russo, Sam Nick	[41]
Persson, Fredrik	[69]	Ryan, Andrea Kathleen	[19]
Peterson, Chris C	[33]	Ryan, Gregory S	[47]
Peterson, Jennifer R	[41]	Rynearson, Kimberly	[32] [77]
Petho-Robertson, Krisztina	[15]	Rypma, Bart	[2]
Phillips, Julia	[56]	Ryska, Todd	[2] [24] [78]
Pierce, Devin	[31]	Saenz, Ingeborg Marie	[69]
Pierce, Noah David	[3]	Sanchez, Anthony Erick	[60]
Pollard, Sara	[10] [41]	Sanchez, Maria Luisa	[41]
Poritz, Julia Marie Paul	[41]	Sanders, Andrew Mylan	[60]
Porras, Claudia Veronica	[60]	Sanders, Lauren	[41]
Porter, Caitlin	[17]	Sandoval, Traci	[47]
Provost, Ruth A	[10]	Sank, Victoria Eliza	[23]
Pryor, Karen	[9]	Sanning, Blair	[60]
Purdy, Jesse E.	[21]	Sauceda, Enedelia	[60]
Qiu, Xiao	[47]	Savina, Elena	[10]
Rabinowitz, Yaron	[2] [10] [41]	Scardino, Jennifer	[2]
Radchenkova, Polina	[10]	Schapiro, Steven J	[67]
Ramirez, Devan	[2]	Scharff, Lauren	[31] [48] [57]
Ramirez, Sylvia Z.	[51]	Schindler, Charles	[41]
Randow, Robert C	[41]	Schnelle, Amanda	[10]
Rao, Neena	[34]	Schooley, Jessica Raquel	[32]
rathbun, suzanne	[41]	Schutze, Lindsey	[23]
Rawlinson, Terry Glen	[2]	Schwartz, Michael	[17]
Reagan, Joy E.	[18] [60]	Schwartz Moravec, Margaret	[15]
Reamer, Lisa	[67]	Scott, Carl W.	[2]
Reguenes, Roberto	[69]	Scott, Sarah Michelle	[10]
Reith, Elizabeth Marie	[41]	Scoville, Caleb M	[33] [41] [47]
Reysen, Stephen M	[33]	Sebek, Sara E.	[33]
Rhoads, Lana S.	[10]	Seidel, Steven D.	[10] [33] [47] [60]
Rhoads, Paul A.	[10]	Serafino, Andrew Bryan	[33]
Rhodes, Monica	[33] [69]	Serpati, Lauren	[2]
Richards, Nathan D'Coby	[10] [33] [60]	Serra, Michael J.	[2] [65]
Riels, Allison	[33]	Shean, Glenn D.	[10]
Riggs, Shelley	[10] [41]	Sheng, Yanyan	[47]
Robbins, James Erik	[10]	Shepard, LeAnne M	[19]
Roberts, Joshua	[2]	Shockey, Stephen Tyler	[69]
Roberts, Sharon L	[14] [51]	Shoemake, Elizabeth G.	[60]
Robinson, Ryan	[10] [41]	Shunick, Charlene Emily	[65]
Rock, Jeff	[15]	Sia, Tiffiny L.	[33] [60]
Rock, Samuel K.	[32]	Siler, Haley M	[70]
Rodriguez, Christina Norma	[15]	Silver, Cheryl H	[2]

Author Name	Session	Author Name	Session
Simons, Danielle	[47]	Tkachuk, Cristin	[10]
Singg, Sangeeta	[41]	Tobacyk, Jerome J	[10]
Sither, Emily	[38]	Todd, Victoria	[56]
Sivinski, Michael	[41]	Toelle, Kyle	[41]
Slade, Gabriel Uhriah	[60]	Topp, Lisa D.	[23] [47] [56]
Smart, Latoya Anthea	[56]	Trahan, Don Patrick	[41] [52]
Smith, Clinton	[23]	Tran, Lawrence	[15] [41]
Smith, Danielle	[2] [47] [69]	Trauterman, Sarah Lynn	[41]
Smith, Lauren	[2]	Trawick, Gracee Jean	[18] [52]
Smith, Randolph A.	[49] [68]	Traylor, Shereen LaFaye	[15]
Snider, Jamie S	[33]	Trimboli, Frank	[18]
Sobel, Ken	[65]	Tschirgi, Crystal	[60]
Solis, Enrique M	[41]	Tucker, Sarah M	[32]
Spain, Jana S.	[10]	Tworek, Jessica Lynn	[2]
Spears, Jan	[8]	Valentine, Kathrene	[2]
Spencer, Matthew	[33]	Vandehey, Michael	[15]
Spiller, Laura C	[4]	Varghese, Femina P.	[69]
Stacks, James R.	[47]	Varghese, Melvin L.	[19]
Stagner, Brian H	[54] [63]	Varnado-Sullivan, Paula J	[69]
Stampahar, Allison	[41]	Vazquez, Janet	[41]
Starr, Katie	[33]	Velazquez, Celeste Adriana	[41] [69]
Staton, Cathy	[47]	Vogel, Rachel M.	[70]
Stephenson, Drew Guillaume	[2]	Walters, Jeanette Marie	[45]
Stewart, Brittany	[33] [41] [47]	Wang, Qingwei	[10]
Stiles, Beverly L.	[4]	Watkins, Kari	[15]
Stinson, Jennifer	[15]	Watson, Brandy Michelle	[69]
Stone, Ph.D., Polly A.	[10]	Weed, David B	[15]
Strange, Crystal	[2]	Weese, Anne	[10] [33] [60]
Swagerty, Julie Beth	[10] [33] [60]	Wegener, Lisa	[23]
Swagerty, Lindsey Michelle	[14]	Weir, Alex	[2]
Swann, William	[75]	Weir, Kristine	[2]
Sylvester, Richard L	[10] [31]	Westbrook, Erica Dannelle	[41]
Tan, Cin Cin	[41]	Wherry, Jeffrey N	[2]
Tatum, Eleasha	[56]	Whipple, Wendy Morgan	[60]
Taylor, Gregory Wade	[47]	White, Abbey Gail	[69]
Taylor, Mary Anastasia	[10]	White, Julie	[10]
Taylor, Shantik A	[60]	Whitlock, Dustin Shelby	[31]
Terranova, Andrew M	[33] [56] [60]	Wiebers, Todd	[17] [33]
Theriot, Keri Nicole	[23]	Wilcox, Elizabeth	[2]
Thiele, Erica	[67]	Williams, Adam J	[56]
Thomas, Christina Heidi	[41]	Williams, Jeannetta	[60]
Thomas, David G.	[41]	Williams, Kashunda Lynn	[24]
Thomas, Sebastian Oliver	[34]	Williams, Lawrence	[67]
Thompson, Anita	[51]	Wilson, Deborah Jewel	[24]
Thompson, Jon G.	[15]	Wilson, Kallie	[47]
Thrasher, Andrew Justin	[2] [41] [60]	Wimberly, Cynthia	[51]
Tiemann, Jayme	[34]	Winbush, Chriscendia	[60]

Author Name	Session
Windecker, Kevin	[27]
Winland, Carissa	[21] [38]
Winterowd, Carrie	[69]
Wise, Christine	[38]
Wittig, Shannon	[65]
Wood, Virginia V.	[10]
Woody, Alex	[33]
Worthen, MaryLou Fair	[41] [60]
Wozencraft, Theresa A.	[15] [69]
Wright, Jamila	[60]
Wright, Rachel	[60]
Wyshywaniuk, Lauren Nicole	[2]
Yancey, George	[47]
Young, Adena	[15]
Young, J. Kenneth	[10]
Young, Katie	[15]
Zamora, Richard Calleja	[10] [33] [41] [60]
Zascavage, Victoria	[47]
Zavala, Ella	[69]
Zeigler-Hill, Virgil	[45] [56]
Zhang, Dorothy	[2]
Zinke, Cassandra K.	[41]
Zlokovich, Martha Scott	[49]
Zorwick, Leslie Wade	[33] [60] [70]
Zucker, Evan L	[1] [22] [45]
Zunick, Peter	[31] [33]

